



**NOTIFICATION TO ATTEND MEETING OF THE SOUTH EAST AREA COMMITTEE
TO BE HELD IN THE COUNCIL CHAMBER, CITY HALL, DAME STREET, DUBLIN 2.
ON MONDAY 8 JULY 2019 AT 3.00 PM**

AGENDA

MONDAY 8 JULY 2019

PAGE

1	Election of Chairperson	
2	Election of Vice Chairperson	
3	Time of South East Area Committee meetings	
4	Minutes of the South East Area Committee meeting held on 13 May 2019.	3 - 34
5	Presentation on Planning Application PWSZ3270/19 re Irish Glass Bottle site	
6	Presentation on bike schemes in Dublin	
7	Presentation on Iveagh Trust Green Strategy Projects Order of Magnitude Costings	
8	Environment & Transportation Department Matters	35 - 52
	i. Minutes of the Traffic Advisory Group meeting held on 25 June 2019.	
	ii. Road Maintenance South East Area Works Programme 2019.	
9	Planning & Property Development Department Matters	53 - 54
	i. Proposal to grant a temporary convenience letting of a site at Beggars Bush, Shelbourne Road to Eir.	
10	Culture, Recreation & Economic Services Department Matters	55 - 58
	i. Update on the installation of the Yi Friendship Garden in Herbert Park.	
11	South East Area Matters	59 - 84
	i. South East Area Updates 8 July 2019.	

- ii. Nominations of South East Area Councillors to committees.
- iii. Proposal to name a development at Charlemont Street / Tom Kelly Road.
- iv. Proposal to name a development at 17 Denzille Lane.
- v. Proposal to name a development at 11 Park Avenue.
- vi. Proposal to name a development at Bellevue Avenue.
- vii. Proposal to initiate the procedures to have Adair Lane taken in charge.

12	Motions 8 July 2019	85 - 90
13	Questions 8 July 2019	91 - 100



MINUTES OF THE SOUTH EAST AREA COMMITTEE MEETING

HELD ON MONDAY 13 MAY 2019

- 1 **Presentation from Transport Infrastructure Ireland on the Metro Project.**
Order: Noted.
- 2 **Presentation on Planning Application 2706/19 re 15 - 17 Sandymount Avenue, Dublin 4.**
Order: Noted.
- 3 **Presentation on review of the Scheme of Special Planning Control for Grafton Street and Environs.**
Order: Noted.
- 4 **Minutes of the South East Area Committee Meeting held on 8th April 2019.**
Order: Agreed.
- 5 **Environment & Transportation Department Matters**
 - i. Minutes of the Traffic Advisory Group meeting held on 30th April 2019.
Order: Noted.
 - ii. Report on Mountpleasant Traffic Trial.
Order: Noted.
 - iii. Report on Dodder Greenway – Preferred Option.
Order: Noted.
- 6 **South East Area Matters**
 - i. South East Area Updates May 2019.
Order: Noted.
 - ii. Discretionary Fund Update May 2019.
Order: Noted.
 - iii. Report on proposal to name a development at Marianella, Orwell Road, Rathgar, Dublin 6 as 1 – 107 Rostrevor Place.
Order: Agreed.

Motions 13th May 2019**Motion 1 from Councillor Dermot Lacey**

This committee requests that a speed limit of 30 KPH be applied to Beach Road / Strand Road.

Order: Report to councillor.

Motion 2 from Councillor Dermot Lacey

This area committee agrees to write to Transport Infrastructure Ireland (TII) to confirm our opposition to the demolition of Markievicz Pool and the apartments and houses at the same complex and that TII should find another way.

Order: Agreed.

Motion 3 from Councillor Mary Freehill

Due to a mugging recently on Temple Gardens which was recorded on a local security camera and also a car hijacking on Temple Road, this area which is a route from the LUAS station is unsafe especially for women walking on their own. It is agreed that the local area office will investigate ways of making this area safer i.e. examine the level of public lighting and take action on how to improve it, make sure that the trees are pruned on a regular basis to give maximum public lighting. Consult with Gardaí to see if there are any other measures that can be put in place to make the area safer.

Order: Report to councillor.

Motion 4 from Councillor Mary Freehill

That the council remain in contact with the current owners of the building previously occupied by DIT on Williams Park to make sure that they maintain their property. This area has become a dumping ground, especially behind the bushes along the window frames. If the building cannot be maintained then they should be required to remove these bushes.

Order: Report to councillor.

Motion 5 from Councillor Mary Freehill

Bin poo bags are available from most libraries. For some reason they are not available in all libraries. It is therefore resolved that supplies be made available in all libraries throughout DCC.

Order: Agreed.

Motion 6 from Councillor Frank Kennedy

In circumstances where multiple residents of Golden Lane, Dublin 8 (an area which is mostly residential encompassing four apartment blocks: Castle Way, Whitefriar Gardens, McDonagh House and the Iveagh Trust Complex, as well as a row of two story houses and a row of three story houses) have complained of a significant interference to the peace and tranquillity of their neighbourhood arising from the Viking Splash tour, which has been raised directly with management of that tour in both 2017 and 2019, this Committee resolves that the Manager should meet with the Viking Splash tour in order to suggest the relocation of the tour away from such a residential area. Separately, the Committee resolves that the Manager will also raise at this meeting the importance of the tour guides treating members of the public with respect in circumstances where concern has been expressed at the personalised nature of some comments made to or about members of the public by the tour guides.

Order: Agreed.

Motion 7 from Councillor Frank Kennedy

This committee records its outright rejection of the proposal to remove trees on the Merrion Road for the Bus Connects proposal and resolves to write to the National Transportation Authority to express its disapproval in this regard.

Order: Agreed.

Motion 8 from Councillor Frank Kennedy

In late 2016 / early 2017 a number of Metropole advertising structures were installed in the South East Area. One particularly egregious instance of this was in front of the American Embassy in Ballsbridge. In addition to being unsightly, a much greater problem is that the structure at this location is extremely dangerous, a serious distraction to road users and is in effect an accident waiting to happen. By way of illustration, a constituent advises that some years ago he was stopped at the lights on the left lane in front of the island where the sign is. A car shot by him on the right and broke the lights. A second car overtook him on the left and mounted the pavement and became buried in the flower bed – two plain clothes Gardaí emerged from the car. If the edifice which currently stands at this location had been in situ it is likely that there would have been fatalities. This Committee resolves that the Metropole at this location should be removed.

Order: Report to councillor.

Motion 9 from Councillor Mannix Flynn

That this committee of Dublin City Council support the building of a community centre at the vacant site on Fishamble Street; this site was approved for social housing that will now not proceed. It is important that this site does not lie vacant and be the subject of antisocial activity. The community at Temple Bar are entitled and deserve their own community facilities and centre that were never provided under the Temple Bar renewal project - it's time now for this to happen.

Order: Agreed.

Motion 10 from Councillor Patrick Costello

That this committee agrees to install sufficient bins in our local parks.

Order: Agreed.

Motion 11 from Councillor Claire Byrne

That this area committee welcomes An Bord Pleanála's decision with regards to the Poolbeg West SDZ, and welcomes this new development for the city, but calls on the Area Manager to ensure the following:

- That there are 900 social and affordable units delivered as agreed by this council (not 875).
- That all the social and affordable units are built on site.
- That we work to include a cost rental model as part of the housing mix.
- That we work with the creative community with regards to the design and delivery of the 40 artists' studios.
- That we work with the local and wider community to establish their needs in terms of the 5% community, creative and cultural space.
- That a committee is set up to deal with the above, with delivering the overall plan, and to deal with the issues arising during the development stage.

Order: Agreed.

Motion 12 from Councillor Claire Byrne

That, in light of further announcements that social housing in the Docklands SDZ will not be provided on site, that this area committee calls on the area, to explain why this is happening, what can be done to address this, where will the units be purchased, and to ensure that 10% Social Housing for the Docklands is delivered on site as is agreed in the SDZ.

Order: Agreed.

Motion 13 from Councillor Claire Byrne

That this area committee once again calls on the Area Manager to write to the Minister for Justice to ask him to reintroduce the Community Graffiti Reduction Programme as a matter of urgency, to assist local communities in the ever growing problem of graffiti on private property, and to find additional resources to support Gardaí in their efforts to address the problem.

Order: Agreed.

Motion 14 from Councillor Claire Byrne

That this area committee, recognises the historic, architectural and environmental importance of the South Georgian Core area, and asks the Area Manager if he will work with the local community and other relevant stakeholders to establish a shared residential vision and a coherent policy framework for the future of area.

Order: Agreed.

Motion 15 from Councillor Mary Freehill

It is generally recognised that engagement of the citizen in combatting climate change is key. Therefore it is agreed that a pilot scheme will be established in Kimmage Rathmines Ward by engaging community groups who will work together with DCC by setting up local action schemes as part of the implementation of recommendations in the 'Climate Change Action Plan'. As a first step it is agreed that an operational and implementation report will be presented to the June meeting of the LAC.

Order: Agreed.

Motion 16 from Councillor Mary Freehill

Having reported the problem of parking on double yellow lines (DYL) on Mount Argus Road, because of pinch points on this road, illegal parking can prevent residents from entering and egressing their homes by car; the council arranged for cars illegally parked to be clamped. Sadly this was a one weekend event and residents cannot get the clampers to call to the area on a regular basis.

This meeting resolves that Mount Argus Road be checked by the clampers for illegal parking on a number of occasions per day.

There are regular examples of dangerous parking by commuters on Church Park Mount Argus, sadly while these actions are very dangerous, the clampers refuse to come along and clamp these cars.

Therefore it is agreed that the Traffic Department have an on-site meeting with the residents' association to come up with a solution and to ensure safety of residents.

Order: Agreed.

Motion 17 from Councillor Patrick Costello

This committee agrees to an on-site meeting on Wasdale Park to meet residents and discuss options relating to traffic calming.

Order: Agreed.

Motion 18 from Councillor Patrick Costello

This committee asks the area engineer to examine the possibility of closing Richmond Hill and Mountpleasant Avenue Lower to through traffic with filtered permeability to continue allowing pedestrian and cycling traffic through. The current trial of no entry to Mountpleasant Avenue Upper has been successful in protecting pedestrians using that road, but has caused problems on the roads beside it. There have also been many cases of cars ignoring the signs and driving through the no entry point. Trialling filtered permeability will ensure that all the roads can have the

same benefit of reduced traffic and protection for vulnerable road users and pedestrians.

Order: Agreed.

Motion 19 from Councillor Kieran Binchy

To ask the manager for a copy of the last Dublin 4 / Ballsbridge street trees survey?

Order: Agreed.

8 **Questions 13th May 2019**

Order: Noted.

Cllr. Ruairí McGinley
Chairperson
Monday 13 May 2019

Attendance

Members:

Ruairí McGinley (Chairman)
Chris Andrews
Patrick Costello
Mary Freehill
Paddy McCartan

Members:

Claire O'Connor
Kieran Binchy
Anne Feeney
Frank Kennedy

Members:

Sonya Stapleton
Claire Byrne
Mannix Flynn
Dermot Lacey

Officers:

Brian Hanney
Brian Kirk
Mark Ginnetty
Neil O'Donoghue
Deirdre Scully

Eileen Martin
Paul McCann
Fiona O'Brien
Rossana Camargo
Eileen Buck

Brian Kavanagh
Declan Hayden
Leah Johnston
Andrew Duff
Alec Dundon

Non-Officials:

Aidan Foley, TII
Suzanne Angley, TII
Paolo Carbone, TII

Q.1 Councillor Paddy McCartan

To ask the manager to have a new name plate installed on Auburn Road Donnybrook as the current plate is in a very dilapidated state (see photo).



Reply:

Arrangements will be made to replace this nameplate.

Q.2 Councillor Ruairí McGinley

To ask manager to respond to particular traffic query (details supplied).

Reply:

The Traffic Advisory Group, at its meeting of 27th November, 2018, received the following report from the Area Engineer on the location referenced:

Under the Road Traffic (Traffic and Parking) Regulations 1997, Section 36 (2) "A vehicle shall not be parked (g) in any place, position or manner that will result in the vehicle obstructing an entrance or an exit for vehicles to or from a premises, save with the consent of the occupier of such premises" or "(c) within 5 metres of a road junction."

It is not recommended to introduce parking restrictions where restrictions are already covered under the regulations, such as placing double yellow lines at a junction as this would lead to a proliferation of same.

Infringements of the regulations should be reported to Dublin Street Parking Services at 602 2500 or to the Gardaí as they occur.

The Traffic Advisory Group, at its meeting of 27th November, 2018, therefore did not recommend double yellow lines at the location.

Q.3 Councillor Ruairí McGinley

To ask manager to renew public lights on Coulsen Avenue, Rathgar.

Reply:

There is no Public Lighting improvement programme for 2019. However, we will investigate the existing lighting on Coulsen Avenue, and any necessary improvements will be added to a list for inclusion in a future public lighting programme of improvements, subject to finances being made available. We will continue to carry out routine maintenance works on the existing lights and will replace existing lamps as required.

Q.4 Councillor Dermot Lacey

To ask the manager for an update on where Waterloo Lane is in relation to the roads resurfacing programme - it is in a disgraceful condition.

Reply:

Waterloo Lane will be put forward for consideration for our 2020 Road Resurfacing Programme. In the interim it will be put on our works list for local repairs.

Q.5 Councillor Dermot Lacey

To ask the manager if he can ascertain when and why Strand Road / Beach Road was deemed to be an arterial road - rather than a local road given its total unsuitability to be designated in any way as a major road.

Reply:

The classification of roads are as follows:

- National primary route
- National secondary route
- Regional road

Strand Road and Beach Road are Regional Roads under the number R131/ R802, these are an arterial route that connects the N1 with Dublin Port.

It is referenced in the Road Traffic Act (S.I. No. 54/2012 - Roads Act 1993) the classification of Regional Roads Order 2012. Each public road mentioned by number beside the letter R in column, opposite a description of the road in column, of the Schedule is classified as a regional road.

The Regulation 2 SCHEDULE.

R131 Drumcondra Road — East Link Bridge — Merrion Gates, Dublin

Between its junction with R132 at Drumcondra Road and its junction with R118 at Merrion Road via Clonliffe Road, Poplar Row, East Wall Road, East Link Toll Bridge, Toll Bridge Road, Sean Moore Road, Beach Road and Strand Road all in the city of Dublin.

R802 Dorset Street — Bath Road, Dublin

Between its junction with R132 at Dorset Street Lower and its junction with R105 at Beresford Place via Gardiner Street Upper, Mountjoy Square West, Gardiner Street Middle and Gardiner Street Lower all in the city of Dublin and between its junction with R105 at Georges Quay and its junction with R111 at Church Avenue via Moss Street, Townsend Street, Sandwith Street, Pearse Street, Ringsend Road, Bridge Street, Irishtown road and Pembroke Street (and via Bath Street) all in the city of Dublin

Furthermore, Strand Road is part of the cordon restriction of 5+ axle vehicles; HGV Strategy provides for a ban on 5+ axle vehicles during the hours of 07.00-19.00 seven days a week from a designated cordon area and provides a limited permit scheme for 5+ axle vehicles that need to load/unload within the city centre area. During the hours of 07.00 – 19.00, seven days a week, HGVs with 5+ axles are not allowed to enter the restricted zone during these times unless they have a valid permit. On the other hand, during the hours 19.00 – 07.00, seven days a week, HGV's with 5+ axles are allowed to enter the restricted zone, even without a permit.

It is not possible to restrict the passage of heavy vehicles on this road as there are no other suitable road for the heavy vehicle to pass through.

Q.6 Councillor Dermot Lacey

To ask the manager if he can have a survey conducted on the usage by trucks and lorries of Strand Road / Beach Road.

Reply:

A speed survey on Strand Road was carried out on the 11th May 2018 (7.00) and 12th May 2018 (8.00). The speed survey showed the 85% percentile speeds were below the speed limit of 50kph. The resultant 85% percentile speed was found to be 44 km/h and speed violations were 3.22%.

- The total number of vans travelling on Strand Road were: 363
- The total number of trucks travelling on Strand Road were: 349
- The total number of buses travelling on Strand Road were:213

Please see the following picture of the Speed Survey.

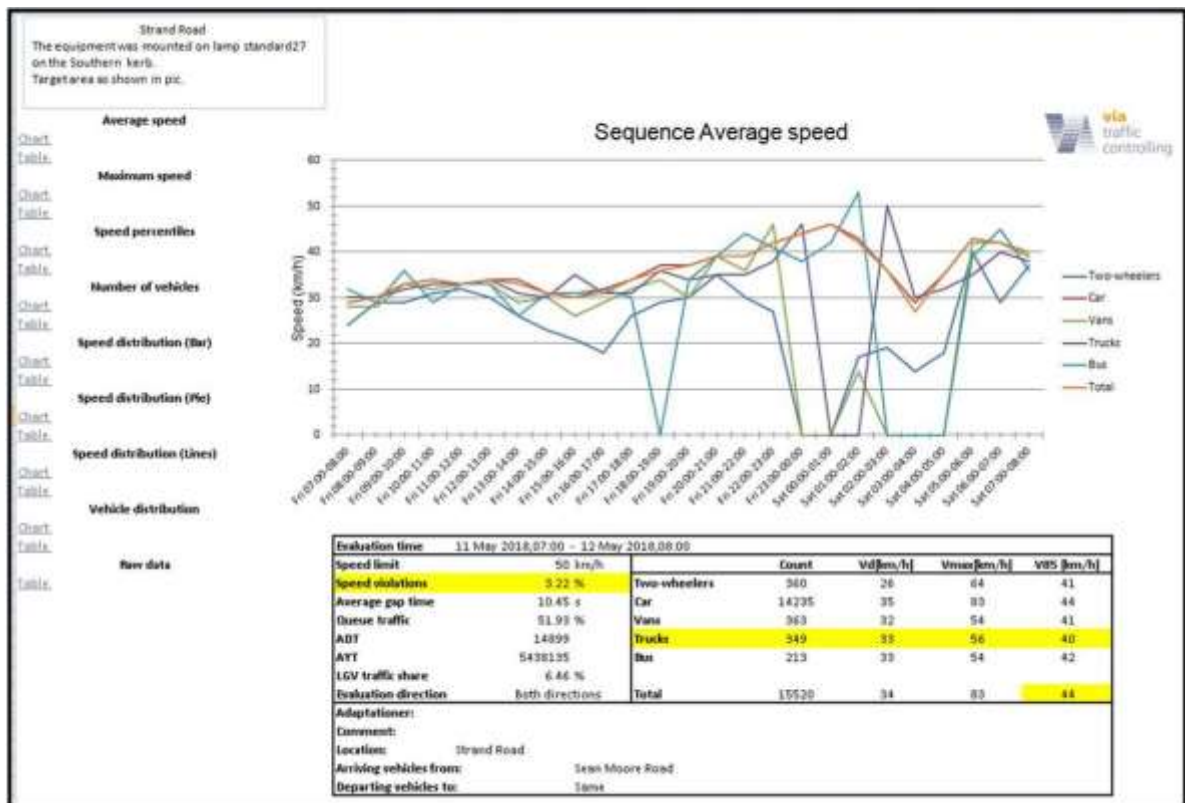

Figure 1. Speed Survey at Strand Road

Strand Road is part of the cordon restriction of 5+ axle vehicles; HGV Strategy provides for a ban on 5+ axle vehicles during the hours of 07.00-19.00 seven days a week from a designated cordon area and provides a limited permit scheme for 5+ axle vehicles that need to load/unload within the city centre area.

During the hours of 07.00 – 19.00, seven days a week, HGVs with 5+ axles are not allowed to enter the restricted zone during these times unless you have a valid permit.

On the other hand, during the hours 19.00 – 07.00, seven days a week, HGV's with 5+ axles are allowed to enter the restricted zone, even without a permit.

Furthermore, HGVs with 4 axles or less are allowed to enter the restricted zone at any time, day or night.

Enforcement of the existing cordon restriction of 5+ axle vehicles is a matter for An Garda Síochána. This matter will be highlighted to the Garda at the next TAG meeting. Furthermore

Dublin City Council have plans to launch an “app” at the end of 2018, that allows members of the public to check if a HGV has a valid permit or not. The public can then report offending vehicles to Dublin City Council (DCC). This will allow DCC to identify areas that need targeted for Garda enforcement.

Q.7 Councillor Ruairí McGinley

To ask manager to retain oak tree in Laurelton estate, Rathgar (detail attached).

Reply:

There are no plans to remove the Oak tree at this location

Q.8 Councillor Dermot Lacey

To ask the manager if he will write to the operators of the (details supplied 1) Centre and ask them once again if they could for once seriously prune the very high and large trees that block light from the residents of (details supplied 2). They have been repeatedly and politely asked to no avail. If they fail to do so again to ask the manager to arrange for Dublin City Council to do so in so far as the trees encroach on and over the public footpath and to inform the Centre that the Council will invoice the Centre for that work.

Reply:

A notice will be sent to details supplied 1 in respect of this overhanging hedge.

Q.9 Councillor Ruairí McGinley

To ask manager to repair path at 121 Rutland Grove.



Reply:

Rutland Grove is part of our 2019 Footpath Reconstruction Programme. We are currently preparing tender documents to procure a contractor to carry out these works. It is envisioned that this works will be scheduled for quarter 3 of 2019.

Q.10 Councillor Dermot Lacey

To ask the manager if he will arrange for the lane from Beech Hill Avenue to Beaver Row to be cleared and cleaned and in particular to arrange for the growth around the three public lampposts to be cut back.

Reply:

Public Domain has been asked to clear out the laneway to remove litter and leaves & the Litter Warden and Public Domain unit have initiated the process of having the graffiti removed.

Waste Management Services had the above mentioned lane cleaned on the 24th April 2019.

Q.11 Councillor Ruairí McGinley

To ask manager to install a mirror for traffic visibility on end of laneway at rear of Harold’s Cross Road as it emerges onto Ashdale Road. A safety issue as lane is busier with children on Ashdale.

Reply:

Dublin City Council do not, as a matter of policy, supply, fit or install traffic mirrors.

Q.12 Councillor Dermot Lacey

To ask the manager if he will arrange for an H sign to be erected on Nutley Lane just beyond the entrance to the Elm Park cul de sac, as outlined in (details supplied).

Reply:

Two new H / hospital signs have been erected on Nutley Lane, see photos below:



A review of H / hospital signage in the general area will also occur in due course.

Q.13 Councillor Ruairí McGinley

To ask the manager to remove tree at 2 Mweenish, Leinster Road West, Harold's Cross.

Reply:

The tree is a mature Hornbeam (*Carpinus betulus*) and considered to be in good Condition. It was pruned within the last five years and the lower branches removed. Currently based on a ground level inspection there are no visible defects in the tree.

Based on this assessment it is not proposed to have the tree removed as requested.

Q.14 Councillor Ruairí McGinley

To ask manager to resurface Sundrive Road road surface.

Reply:

I visited this location today and surveyed the condition of the carriageway. In general the road condition, over this long stretch of road, is reasonable but there are some defects present. Upon inspection I confirm that the bulk of the road has previously been surveyed and defects have been added to our works list for repair. I have requested temporary repairs be provided to carriageway defects and the road condition will be monitored by Road Maintenance.

Q.15 Councillor Ruairí McGinley

To ask manager to renew footpath from Clougher Road Church on Sundrive Road side as far as Eamon Ceannt Park.

Reply:

I visited this location today and surveyed the condition of the footway. I confirm that the footway has previously been surveyed and defects have been added to our works list for repair.

Q.16 Councillor Ruairí McGinley

To ask manager to assign a house number to Marist convent on Sundrive Road close to Sundrive Park.

Reply:

If a property owner wishes to apply to name and / or number their premises in the South East Area, they may make their enquiries / application to me on 222 5127 or Fiona.obrien@dublincity.ie

Q.17 Councillor Ruairí McGinley

To ask the manager to install electric gates in Grove Road DCC housing complex, Harold's Cross. Stolen cars in back car park an issue. Also fly tipping.

Reply:

The Area Housing Manager did engage a contractor to quote for the installation of automated gates at this location last year. This was in conjunction with getting a quote for the installation of CCTV in this complex. Both of these quotes were evaluated for being the best solution to resolve the antisocial behaviour at this location. It was viewed that installation of the CCTV was a better solution to try resolve the antisocial behaviour in this complex. These works are due to commence during the summer.

If it is found that these measures do not resolve the issues of antisocial behaviour then the Area Housing Manager will review the installation of automated gates in this complex.

The Project Estate Officer for this complex has instructed the clamping contractor to increase the patrols in this location and to remove any vehicle that is not authorised to park there.

Q.18 Councillor Dermot Lacey

To ask the manager why double yellow lines approved in 2005 (reference 131470//AT) at parking spaces, which were to be removed, in front of mews development at Cranmer Lane, Dublin 4 have still not been installed and if given the incredible time gap can they be installed now as a matter of urgency.

Reply:

An Area Engineer will assess the location at Cranmer Lane in the coming week with the aim to see if Double Yellow Lines are indeed still a requirement. The outcome of this assessment and the decision that is made will be made available to the Councillor in due course.

Q.19 Councillor Ruairí McGinley

To ask manager to repair footpaths outside 58 and 56 Greenlea where path is uneven and there is severe ponding of water on path.

Reply:

This will be put on our works list for repairs to be carried out.

Q.20 Councillor Dermot Lacey

To ask the Chief Executive if he will arrange to have bins - specifically the Big Belly Bins - installed in the increasingly popular Ranelagh Park as sought in the email submitted with this question (details supplied).

Reply:

There were originally three individual standard sized litter bins present in Ranelagh Gardens Park and these have been replaced by a single 'triple' bin located between the entrance to the park at the Ranelagh village end of the park and the playground.

The large triple bin has approximately the same capacity of the 3 No. single bins and allows for more efficient collection and disposal of litter. Prior to this installation the smaller litter bin

adjacent to the playground was constantly overflowing, primarily due to the heavy footfall at the playground, and this was a particular problem during the weekends. Except for rare instances the triple bin has eliminated this problem.

The other two bins, located further into the park, were rarely full except for the depositing of domestic waste. Therefore taking account that the park is used primarily by residents living within a short walking distance it is considered that replacement bins are not necessary at this location.

Also based on our discussions with the local residents' association who are supportive of our initiative in regard to rubbish collection in the park and we have received no complaints in regard to the condition of the park since the triple litter bin has been installed.

We are currently awaiting delivery of a small number of solar powered 'Big Belly Bins' which will be installed in selected parks on a trial basis over the summer.

Q.21 Councillor Chris Andrews

Can the manager fix the footpath that links the Leukos Road in Ringsend with Sean Moore Road as the slabs have lifted and are a hazard for older walkers and residents with disabilities?

Reply:

This will be inspected and repairs scheduled as necessary.

Q.22 Councillor Chris Andrews

Can the manager arrange to have the pocket park opposite 7 Lombard Court cleared up and also can the pathway in front of the park be cleared up and made safe?

Reply:

Parks and Landscape Services have listed the pocket park for cleaning over the next few days.

Q.23 Councillor Frank Kennedy

In circumstances where the bin at the entrance to the Nature Reserve in Sean Moore Park has previously been burned out, and given the importance of bin facilities at this location, to ask the Manager to install a solar-powered belly bin here which would be both much more effective and far less prone to being set alight by vandals.

Reply:

Given the additional cost of installing solar compactor bins it is not recommended to install this type of bin in locations where previously installed bins have been burnt. The Waste Management Department will discuss the issue of suitable provision of bins in this area with the South East Area public domain management team. There may be more suitable locations in the vicinity of the nature reserve where the risk of bins being damaged or vandalised is lower than in the current location.

Q.24 Councillor Frank Kennedy

Williams Place South is an 'L' shaped street that connects with Clanbrassil Street at one end and Long Lane / Meathville Terrace at the other end. The Clanbrassil end is a wide street and contains adequate parking for the residents at that end of the road. However, for those who live at the Long Lane / Meathville Terrace end, this section of the road is very narrow and residents must park their cars physically touching their homes in order to park. Moreover, even if the residents get their car tight to the wall the cars are still at risk from being damaged by passing cars (**see photos attached**). [**Details supplied**]'s car has been damaged on many occasions and in April 2019 it was crashed into by a passing car became a write-off. In these unique circumstances, to ask the Manager to facilitate the purchase by [**Details supplied**] of a parking permit for Long Lane / Meathville Terrace.

Reply:

The Dublin City Council Parking Control Bye-Laws regulate with regard to entitlement and eligibility to Resident Parking Permits and make provision for entitlement to permits by non-residents of a road in limited circumstances only. Residents of Williams Place South are not entitled to a Resident Parking Permit for use on Long Lane.

There is very limited capacity remaining on Long Lane and this demand for parking from residents reflects the demand for parking throughout the area with many locations already at full capacity.

In the circumstances Dublin City Council will continue to manage parking in the area as best it can but cannot facilitate all residents with parking.

Q.25 Councillor Frank Kennedy

With regard to the stretch of Haddington Road between Baggot Street and Northumberland Road despite the huge volumes of people who traverse this thoroughfare (given the two large pubs on the road and the fact that it is a route to the Aviva Stadium) there are no litter bins on this stretch of road. The effect of this is that waste is dumped in private bins or just thrown on the road where it rots. Furthermore, there tends to be a constant fall of small branches and twigs which clogs up the gutter and floods the footpath in places. Unfortunately the sweeping lorry is generally ineffective as it must traverse the middle of the road due to parked cars, not being able to access the locations where most rubbish has accumulated. Therefore, to ask the Manager (a) to conduct regular and comprehensive manual cleaning of this stretch of Haddington Road and (b) to install litter bins along the same stretch.

Reply:

Waste Management Services have Haddington Road cleaned on a daily basis and we will ensure that particular attention is paid to the stretch between Baggot Street and Northumberland Road. We will monitor litter levels along this stretch to see if there is a requirement for litter bins.

Q.26 Councillor Frank Kennedy

[**Details supplied**] has been six years on the Housing List. She is deaf and suffers from depression. Her living conditions are going from bad to worse which is causing serious exacerbation of her physical and mental health difficulties. She and her five year old daughter are living with her parents, both of senior years and one of whom is in bad health. Her brother also lives in this home which is a small two bedroom house. She and her daughter share one of the rooms, which his is very cramped, her parents share the other and her brother does not have a bedroom. Her daughter and her parents are also facing serious challenges and significant stress in the living environment. The circumstances are at present unbearable for [**details supplied**]. Given her circumstances, to ask the Manager to find appropriate housing for her and her daughter immediately.

Reply:

The above applicant is on the Housing List with an application date of 24th April, 2013 the applicant holds the following positions on this list:

Area	Bed size	Position
Area M	2	90
Area N	2	106

Based on this position it may be some time before the applicant is reached for an offer of social housing.

It is noted that the applicant sought to be considered for medical priority. The applicant submitted an application for consideration for medical priority on 19/10/2018, in which no medical priority was given. If the applicant wishes to appeal this decision, please advise her to submit new supporting medical evidence outlining the change in circumstances since the most recent decision.

This applicant is currently eligible for the Housing Assistance Payment (HAP) Scheme which will provide the applicant with financial support towards the cost of renting a property. Should the applicant wish to be considered for this scheme she must present to the Allocations Section with current income details and a Housing Advisor can provide information and advice on the scheme.

Dublin City Council allocates properties based on time on the list and currently there are applicants on the waiting list of longer standing who have to be considered as suitable vacancies arise. It is not possible to indicate accurately the prospect of an offer for any applicant. The number of vacancies arising will be a determining factor in the length of time applicants could expect to be on the waiting list.

Q.27 Councillor Frank Kennedy

The new Metro line proposed by the National Transport Authority (NTA) / Transport Infrastructure Ireland (TII) proposes to demolish College Gate on Townsend Street, Dublin 2, an apartment complex of 70 homes, to make way for a new Metro station at Tara Street. While residents in other areas have had their concerns addressed to achieve major changes to the Metro plans, the residents / owners of College Gate have had no success in re-routing the plans to demolish their homes. This is so in circumstances where the homeless figures for Dublin exceed 10,000 people. There is a real concern that a development such as College Gate, in an economically disadvantaged area, is being brushed aside by the NTA / TII. To ask the Manager to write to the NTA / TII to call for the amendment of Metro plans such that College Gate will not be demolished.

Reply:

While the City Council appreciates the concerns expressed on behalf of residents who will undoubtedly be seriously inconvenienced if MetroLink proceeds on the current alignment, it is satisfied that alternative route alignments that would avoid the need to demolish the College Gate complex (incl. the leisure facility) and the Townsend Street houses have been examined by NTA / TII and have been ruled out on valid engineering viability grounds.

The council is also in discussions with NTA/TII in relation to reconstruction of the apartment block and houses on Townsend Street.

On the basis of the assurances it has received from NTA/TII to date and the NTA/TII assessment of alternative route options the City Council executive will not be making representations to NTA/TII to select an alternative route.

Q.28 Councillor Frank Kennedy

At the SEAC in November 2018 I asked the following question and received the response beneath it:

Q.28 Councillor Frank Kennedy

On 16th October 2018 a resident of Cranfield Place, Sandymount had to leave his home to get medication from the pharmacy for his sick child. However, notwithstanding that his vehicle was parked in his driveway, a vehicle had unlawfully parked in front of his driveway and he was unable to leave his home by car. He reported the incident to Dublin City Council Clamping & Tow Away on 01 6022 500 at 7.56pm. He was informed that there was no guarantee someone from the service would call to his home. As warned, no-one came to his home to tow the offending vehicle. The driver of the car returned to it at 9.30pm and proceeded to do a U-turn

and then drove the wrong way down what is a one-way street. This experience is not uncommon for the resident in question. On the many occasions that he has been forced to call Clamping & Tow Away, only once has a tow truck or parking monitor attended. To ask the manager:

- (a) When major events are taking place at the Aviva stadium, is there an increase in the numbers of tow trucks and parking monitors on active duty?; and*
- (b) If not, to ensure that when events are taking place at the Aviva Stadium, adequate tow trucks and parking monitors are on duty and available in the surrounding area.*

Reply:

Dublin City Council has developed the Aviva Stadium and Croke Park Major Event Parking Enforcement protocol in conjunction with An Garda Síochána and Aviva Stadium and Croke Park and this has been incorporated into their individual Major Event Plans. The protocol sets out roles, responsibilities and lines of communication between the relevant stakeholders. The council's parking enforcement contractor, Dublin Street Parking Services (DSPS), operates in the immediate area primarily under the direction of the gardaí on major event days.

DSPS provide a free vehicle relocation service to the gardaí where a vehicle has to be relocated for crowd safety reasons. A dedicated removals truck is assigned for this purpose. In addition to removals this crew also carry out enforcement as does another dedicated enforcement crew. These resources operate solely in the immediate area. In addition normal enforcement activities are maintained city wide.

Croke Park, Aviva Stadium, An Garda Síochána and the council through their individual websites, social media and Traffic VMS signage promote the use of public transport, advise on parking legally and also advise that enforcement by way of clamping is in force.

Enforcement on match days and prior to other events is typically carried out on surrounding roads early in the day prior to traffic and crowd build up in the area when unrestricted access is possible. Early enforcement in this way also acts as a deterrent to other motorists who then arrive later in the day when attending the stadiums. Aside from this, enforcement levels and response time to individual complaints largely depend on a number of issues, i.e. the teams playing, nature of the event, Garda resources deployed and Health & Safety issues as these all affect the ease with which enforcement crew can move around the area to carry out enforcement.

Regrettably, this problem continues to persist to precisely the same extent in the area. There is blatant illegal parking blatant during matches (all codes) in Lansdowne Road. On an evening in late March, the situation on Claremont Road was dangerous. There was cars and vans parked on the footpaths, on corners and generally causing a major traffic issue in the area. Residents could not exit their homes in their cars. Separately, during one recent event on Claremont Road a bus couldn't move on the road due to illegally parked traffic. Residents have a large collection of photographs documenting these infractions but there is no sign of any official response whatsoever. The policy outlined in the answer to my question in November 2018 is simply not working. To ask the Manager to implement a proper policy of enforcement which would deter the brazen and constant violations of the law which occur at present.

Reply:

Unfortunately, vehicle and pedestrian traffic does limit the effectiveness of enforcement as vehicles can often find it difficult to reach some locations in the vicinity of the Aviva Stadium during events. During these events enforcement crew are specifically assigned to carry out enforcement duties in the area in addition to crew assigned to normal parking enforcement throughout the city.

The issue highlighted will be raised with relevant stakeholders at the next pre-event meeting and arrangement has been made for increased monitoring and enforcement by Dublin Street Parking Services immediately prior to events.

Q.29 Councillor Frank Kennedy

In the past I have submitted questions regarding the enormously and dangerously overgrown trees on Shrewsbury Park, Dublin 4 (see for instance, Q.75 SEAC February 2018). While there have been improvements to some of the trees, there are two trees in particular which at present cause a very serious health and safety risk. Facing into Shrewsbury Park from the vantage point of Merrion Road, the third and fifth trees on the right hand side of Shrewsbury Park (of the six in total) should both be reduced by about ten metres in height with commensurate reduction in their width. To ask the Manager to carry out the requisite reduction in both the height and width of these trees.

Reply:

The trees on Shrewsbury Park were pruned in February 2018 and the majority received 15 - 20% tree crown reduction. One tree was also removed from this location at this time.

Additional pruning work is not required on these trees at this time.

Q.30 Councillor Frank Kennedy

To ask the Manager to rectify the following problems in the home of [Details supplied] who, together with her family, has lived in this accommodation, now in a wholly unacceptable state, for 17 years:

- *Before Christmas, we had a survey done of our home by DCC and we were informed that all of our windows are unsafe in the case of a fire and would need replacing. This is concerning for my family as our safety is at risk. I have had no follow on in relation to this survey or when we may expect something to be done.*

Here is a detailed list of problems/concerns in our house:

- *Windows - Both living room windows are broken and cannot be opened. Kitchen window opens but is stiff. Bedroom windows - 1 is broken and cannot be opened and 1 is stiff and safety lock cannot be lifted to allow exit in case of a fire. Bathroom windows - small one opens, top one does not.*
- *Mould - Due to broken windows, we are unable to open them to air out the house and therefore we have mould in the bathroom and around the bedroom windows.*
- *Insect Infestation - We have been experiencing an infestation with small brown bugs in our living room for the past few months. No matter what we do we cannot get rid of them.*
- *Gas Boiler - We had our boiler replaced during the bad weather last year as it was leaking gas and was deemed a hazardous. When the boiler was replaced they left a huge hole in our wall that we were informed would be filled.*
- *Draft: The front door does not close properly and there is a draft which leads to higher heating bills.*
- *Back Door: Is stiff and we were informed during the survey it would be replaced.*

Reply:

A conditional survey of this dwelling was carried out by Housing Maintenance which indicated that the windows and doors in the dwelling were in good condition and not in need of replacement.

Housing Maintenance has no prior record of a request for repairs to the windows or door. This request has now been logged and will be attended to by Housing Maintenance depot.

Housing Maintenance has no prior record of mould in this dwelling. This has now been logged and an inspection will be carried out.

Dealing with insects is tenant responsibility. Housing Maintenance are not in a position to take on this responsibility.

A new gas boiler was installed in this dwelling early 2018. Housing Maintenance has no record of works unfinished. An inspection will be carried out and any necessary repairs will be carried out.

The tenant of this dwelling will be contacted to make arrangements for the upgrade of smoke alarms, carbon monoxide alarms and a fire blanket.

Q.31 Councillor Paddy McCartan

To ask the manager to deal with the following issue from a constituent. She writes:

"As I am sure you are aware, Shellybanks ENTS is moving on to the Rehab site from September 2019. As a parent of two children in the school, I am very concerned and anxious about the road layout and amount of traffic at the proposed school entrance. There are a lack of safe ways for the children to cross the roads leaving from the school at the junction where three roads meet and to get to Sandymount Green. There will be children up to fourth class in the school from September and I am sure some of these will be walking home without adult supervision.

The school did not qualify for a lollipop warden last September in the RDS building. I hope they are entitled to one from next September.

I know there has been talk about proposed traffic calming around Sandymount Village. I think this is more urgent now with a new primary school in place and eventually the secondary school will be back on site too."

Reply:

The request for a school warden at this location has been added to the agenda of the Traffic Advisory Group for examination and report by the Area Engineer and School Warden Co-ordinator. An examination will be carried out when the school opens in September, 2019. The Councillor will be informed of the recommendation in due course.

Sandymount Green scheme is part of the 2019 programme of works for the South East Area and currently at detail design stage which is expected to be completed in the third quarter of 2019, the scheme will then move to construction stage.

Q.32 Councillor Paddy McCartan

To ask the manager to deal with the following issue from a constituent. He writes:

I am writing to ask you to take action regarding the state of cleaning on my road, i.e. the stretch of Haddington Road between Baggot Street and Northumberland Road. In the seven years that I have lived here, I have NEVER seen this road properly cleaned, except once when it was completely re-surfaced!) There are 2 large pubs on the road, and it lies on the direct access to the Aviva Stadium, which means that every time there is a match or a concert, there are crowds passing along with beer and food packaging.

Incredibly, there are NO litter bins on this stretch of road! So the waste is dumped in private

bins or just thrown on the road where it rots. (You will be aware that existing rubbish on the road 'encourages' the dropping of more rubbish) We can also boast several broken kerbs!

The trees along the road have not been attended to in years and there is a constant 'fall' of small branches and twigs which clogs up the gutter and floods the footpath in places. This week some trees on the road were actually pruned (not all), and we now have a good layer of sawdust to add to the muck and weeds blocking the drains I have observed the totally useless weekly trips up and down the middle of the road by a huge 'sweeping' lorry which is unable to collect anything because of parked cars and it must return to the depot as empty as in left!

I have picked up rubbish and swept parts of the street myself several times, and I have disposed of the rubbish at my expense. In view of the hundreds of thousands paid by residents in Property Taxes, it would really nice to have some proper cleaning (including the footpaths).

Reply:

Waste Management Services have Haddington Road cleaned on a daily basis and we will ensure that particular attention is paid to the stretch between Baggot Street and Northumberland Road. We will monitor litter levels along this stretch to see if there is a requirement for litter bins.

This location will be inspected and broken kerbs will be put on our works list for repairs to be carried out.

The surface water and Flood Incident Management Section are responsible for the cleaning of gullies. On Friday (03/05/19), a crew was sent to Haddington Road to undertake cleaning of gullies.”

Q.33 Councillor Paddy McCartan

To ask the manager to deal with the following issue from a constituent. He writes to me:

As the person who secured the controlled parking in Baggot Lane I would draw your attention that most of the lines have disappeared and also that there no signs at the end of Baggot Lane / Northumberland Road corner which means the law cannot be enforced. I would ask you see if this can be fixed, the residents would appreciate this.

Reply:

Road markings shall be renewed within 30 working days of the SEAC meeting of the 13th May 19.

The Traffic Officer has advised that signs at this location are currently being manufactured and shall be in place as soon as possible.

Q.34 Councillor Paddy McCartan

To ask the manager to deal with the following issue from a constituent. He writes:

You will recall you arranged for Lea Road Sandymount to be resurfaced about 2 years ago and they did a super job. Of course a leak arose on the road opposite my house some time ago and they applied a temporary repair to the leak area, but it still needs a permanent repair. Would it be possible for you to ask Dublin City Council Roads Department to address this? The leak is between 19 Lea Road and 22 Lea Road.

Reply:

This will be examined to determine who is responsible for this repair and appropriate action will be taken.

Q.35 Councillor Paddy McCartan

To ask the manager to deal with the following issue from a constituent. She Writes:

Back in late 2018 I emailed the council about the bins being removed in Ranelagh Park and enquired if they would be replaced with solar powered bins.

I never received a response to my email from Parks, however Customer Service advised that they forwarded my email to Parks.

Since my email, the 3 bins in the park that were removed have been replaced by one bin at the Luas station entrance.

The one bin in the park is not enough and there is a need to replace all of the bins that were removed. The most appropriate bins would be the large big belly compacting bins that send an alert when they are full.

I have attached a photo of how I found the bin today at midday (see below). It's very unsatisfactory - particularly given its proximity to the playground.

It is unreasonable to expect the park to be used as an amenity but to then not provide the bins that are needed. An argument could be made that people should take their rubbish with them however this is not always doable.

One way of ensuring that the park is kept clean and in a presentable usable condition is to provide the necessary bins 3 or more.

Reply:

As stated above there were originally three individual standard sized litter bins present in Ranelagh Gardens Park and these have been replaced by a single 'triple' bin located between the entrance to the park at the Ranelagh village end of the park and the playground.

The large triple bin has approximately the same capacity of the 3 No. single bins and allows for more efficient collection and disposal of litter. Prior to this installation the smaller litter bin adjacent to the playground was constantly overflowing, primarily due to the heavy footfall at the playground, and this was a particular problem during the weekends. Except for rare instances the triple bin has eliminated this problem.

The other two bins, located further into the park, were rarely full except for the depositing of domestic waste. Therefore taking account that the park is used primarily by residents living within a short walking distance it is considered that replacement bins are not necessary at this location.

Also based on our discussions with the local resident association who are supportive of our initiative in regard to rubbish collection in the park and we have received no complaints in regard to the condition of the park since the triple litter bin has been installed.

We are currently awaiting delivery of a small number of solar powered 'Big Belly Bins' which will be installed in selected parks on a trial basis over the summer.

Q.36 Councillor Paddy McCartan

To ask the manager to have the potholes filled on Pembroke Lane Ballsbridge between Raglan Road and Wellington Road.

Reply:

This will be put on our works list for repairs to be carried out.

Q.37 Councillor Paddy McCartan

To ask the manager to respond to the following issues in the email below:

Following on from our call last week, I've set out an overview of the issue we discussed in relation to our football club, Harding IF FC, and our access to the all-weather pitch in Irishtown stadium. I'd be very grateful if you could forward this on to the relevant contact in Dublin City Council for consideration. I am Chairman of the club and would be very happy to have a meeting to progress the issue, if that would be helpful.

Executive summary

Harding IF FC are seeking your support in our attempt to be considered as a local team by the management of Irishtown stadium so as to be treated on an equal basis as all the other local sports teams in Ringsend who are considered as local teams and thus benefit from the community rates charged by the stadium.

Who are Harding IF FC?

Harding IF FC are a junior soccer club which has 2 teams that play in the United Churches Football League (UCFL). The club has been in existence since 1948 and has been based in Ringsend for the last 8 years. Prior to that, the club had operated out of Herbert Park in Ballsbridge. The club's two teams have the pitch rental from Dublin City Council parks department for grass pitch 2 in Ringsend Park. This rental has been in operation for 8 years. In addition to the grass pitch rental, the club have twice weekly slots (on Tuesday and Thursday evenings) on the all-weather pitch in Ringsend Park which is managed by Irishtown stadium. As with the grass pitch, the twice weekly rental of the all-weather pitch has been in place for 8 years. The club is sponsored by Slattery's public house in Beggars Bush and by Give N Go Ltd. who operate the InterFirms 7 aside soccer leagues which operate out of the all-weather pitch in Irishtown / Ringsend.

The club currently has 60 registered players. Of this number, 50% are resident in the Dublin 4 and Dublin 2 areas adjacent to Ringsend Park. In addition, of the overall 60 players, at least 75% work in the Docklands of Dublin 2.

Ongoing Issues with Irishtown stadium

The club has recently encountered difficulties with the management in Irishtown stadium which we believe has resulted in our request to be classified as a local team to be ignored. The issues only arose in late 2018. Up until August 2018, the club had a good working relationship with the management team. However, following the club's request to be assigned a match slot on the all-weather pitch for Saturdays, a change in the relationship occurred.

During the 2016/2017 and 2017/2018 seasons, the club had been able to secure Saturday match slots on the all-weather pitch if the holders of those slots confirmed to the stadium that they weren't going to use them. For these ad hoc rentals, the club paid the charge at the public rate. The club was happy with this arrangement as the all-weather pitch is a wonderful facility and is so much better to play on compared to the grass pitch in the park. It's no surprise that the more established clubs in Ringsend such as St Pats CY and Liffey Wanderers (both Saturday pm) and the schoolboys clubs (Saturday am) have extensive bookings on the all-weather pitch.

The basis (agreed between the stadium and the club) upon which ad hoc booking were made and accepted during 2016/2017 & 2017/2018 seasons was as follows:

- i. The club could make a request for any free time slot on the all-weather pitch regardless of whether the park is called on or off but the stadium cannot confirm until Friday as the existing slot bookings take precedence;

- ii. If the club was successful in obtaining a morning slot on the all-weather pitch the game would have to have a 10.30 am kick off in order for the team on the pitch between 1-3pm to be able to warm up on the pitch;
- iii. The club is not to seek to book the pitch for any cup games as extra time and penalties would potentially interfere with (ii) above. However, if no match is on the all-weather pitch after the Harding game, then this would not apply; and
- iv. The club would pay the pitch rental fee at the rate agreed in the pitch letting agreement signed at the beginning of each year.

In order to formalise this arrangement, the club formally requested in June 2018 to secure the 1 - 3pm match slot on Saturdays. However, this application was rejected by the stadium and the slot which had been vacant was awarded to St. Pats CY.

Prior to the 2018/2019 season commencing, the club reached agreement with the stadium that the ad hoc arrangement detailed above would continue to apply for the 2018/2019 season. This arrangement worked fine until mid-September 2018 when the stadium announced that they would no longer allow us access to the all-weather pitch on Saturdays. Following a protest, the only exception they provided for was that they would consider a request only if the park pitches were officially called off as being unplayable for Saturdays.

As per Dublin City Council's customer charter, the club sought a Statement of Reasons from the management in Irishtown stadium as to why they had taken this decision in September / October 2018. Despite being asked for the statement a number of times, the management team in the stadium has not provided a statement of reasons. The one result from the club's repeated requests was that, in March 2019, the stadium partially reversed the decision taken in September / October 2018 and informed us that we could make requests to play matches on the all-weather pitch regardless of whether the parks were designated as unplayable. However, the management team in the stadium have refused to provide any details on the basis upon which our request will be judged or whether the previously agreed criteria detailed above would apply.

Request to be considered a local team

As the working relationship with the current management team has deteriorated to such an extent that the club does not feel that it is being treated fairly, the request to be classified as a local team is the club's attempt to secure equitable treatment from the stadium management. All other sports clubs in the Ringsend area are considered by the management of Irishtown stadium as being local teams and are charged at a different (cheaper) rate to clubs who make ad hoc bookings. Despite asking the stadium over a month ago for details as to what is the process for agreeing local club status, we have received no information or guidance.

Reply:

Harding FC currently have access to the all-weather pitch at Irishtown Stadium for training on Tuesday and Thursday evenings. I raised an issue last year in relation to their use of the all-weather pitch for matches whilst at the same time having a pitch rental on the grass pitch in Ringsend Park. I did not consider it good practice that a grass pitch which would be in demand would lie idle based on the decision of Harding FC as to whether they would play on it or use the all-weather. The arrangement at the time was that Harding FC could book the all-weather (subject to availability) if the grass pitch was unplayable due to weather conditions. I reviewed this decision with the stadium management this year and agreed that Harding FC could book matches on the all-weather pitch subject only to availability.

Harding FC state that they have encountered difficulties with the Stadium management as a result of their request to be classified as a local team. I do not accept that they have encountered any such difficulty. Harding FC also state "that the working relationship with the

current management team has deteriorated to such an extent that the club does not feel that it is being treated fairly”.

Harding FC are not part of the “Umbrella Group”. This group of clubs / teams were involved in the original proposal to build the all-weather pitch and were part of the overall decision making process at the time of funding applications and building proposals. As such, as agreed at that time, rates of charges below the full rates to be charged to non-umbrella groups were negotiated with this group and the local representatives from the area. Harding FC now wish to be considered to be part of this group to avail of reduced charges. I do not accept that this is appropriate and furthermore it is not within my remit to “make” them part of this group.

Harding FC are offered rental rates which are considerably lower than those prevailing in other facilities. Harding FC can continue to avail of these rates for their Tuesday and Thursday night training sessions. Harding FC can apply for a match letting on the all-weather pitch but this can only be granted subject to availability. I am not proposing to remove existing teams (subject to them complying with their terms and conditions) from match fixtures to facilitate Harding FC or any other club. If Harding FC and possibly all other users of the facility are to be allowed access to further reduced charges the facility will require significant additional council funding to meet the costs of operations.

Q.38 Councillor Paddy McCartan

To ask the manager to have an abandoned car removed from Anglesea Road, Ballsbridge (pics to follow).

Reply:

This car has been inspected and the owner has been contacted. The registered owner lives on the road and the car is not deemed to be abandoned.

Q.39 Councillor Mannix Flynn

Can the manager have clear signage placed on all the pedestrian bridges on the Liffey and other waterways like the Dodder and the canal that indicate “no cycling pedestrians only”?

Reply:

No cycling signs are currently on order and will be erected on the Sean O’Casey Bridge and the Millennium Bridge. As there are steps on the approach to the Ha’penny Bridge it is considered that no cycling signage is unnecessary in this location.

The pedestrian bridges along the Dodder and canals will need to be investigated to see if no cycling signage is appropriate.

Q.40 Councillor Mannix Flynn

Can the manager issue report regards what action has been taken with regards the illegal street furniture that has been placed on Dame Lane?

Reply:

Inspections of this area has shown that no furniture is placed on the public footpaths or roadways during office hours. Dublin City Council has taken enforcement action and removed unlicensed furniture from here in the past,

Enforcement Notices have been issued on 2/11/17, 10/5/18 and 8/11/18 and the undersigned personally warned the Manager of the licensed premises on the 27/2/19.

Further monitoring will be carried out and unlicensed furniture will be removed.

Q.41 Councillor Mannix Flynn

Can the manager issue a report as to what action has been taken to deal with the drug dealing and ongoing antisocial behaviour and criminal activity that is taking place on Lord Edward Street and Castle Street and in the passivity of the methadone clinic?

Reply:

Anti-social behaviour and criminality is a matter for An Garda Síochána and your question was sent to Chief Superintendent Lorraine Wheatley, Kevin Street Garda Station, 41 Kevin Street Upper, Dublin D08 PW26 on 30th April 2019.

Q.42 Councillor Mannix Flynn

Can the manager have the paving stones on Harcourt Street East side fixed and repointed many of the pavement slabs here are loose and I resulting in many people tripping and falling part of the pipe and are completely disintegrated and smashed and are a danger to pedestrians?

Reply:

This will be inspected and repairs scheduled as necessary.

Q.43 Councillor Mannix Flynn

Can the manager have the drainage in Glovers Court flat complex cleaned and inspected many residents here are complaining of flooding due to broken drains and piping in this flat complex that is not in working order.

Reply:

The drains in this complex were surveyed and checked three years ago. Any issues identified at that time were addressed.

If any individual tenant has a blocked drain or issue with pipes in their dwelling contact with Housing Maintenance can be made on 222 2191, the issue will be investigated and any necessary works carried out.

Q.44 Councillor Mannix Flynn

Can the manager contact the owners of the staircase building in Aungier Street and have them remove the graffiti from the front of the building; this is the listed structure that has simply been abandoned for the past number of years.

Reply:

The legal position is that owners / occupiers are responsible for the removal of graffiti from their own premises.

Please note that we are currently awaiting contact details for the owners of this property from the Conservation & Heritage Section of the Planning & Property Development Department. We will write to the owners asking that they arrange to have this graffiti removed in an appropriate manner as soon as possible.

Yes, the owners and their representatives are in the process of being contacted to ensure the staircase building, 21 Aungier Street, has the graffiti removed. As the building is a protected structure, the Conservation Section advises that any shopfront works should be carried out in a careful manner by a contractor with proven experience of working on Historic Buildings / Protected Structures, all in accordance with best conservation practice.

Q.45 Councillor Mannix Flynn

Can the manager issue a full report as to what permissions have been given to the developers and builders to commandeer a large part of this public road way at Longford Street and also at Lower Stephen Street?

Reply:

The Roadworks Control Unit issued a Hoarding Licence on the 25th October 2018 for Longford Street and Stephen Street Upper to the contractor. The validity period of the licence is the 25th October 2018 to the 1st June 2020. The hoarding is necessary to facilitate the implementation of planning reference 3971/15. The layout requires temporary traffic management measures including a narrowing of the traffic lane on Longford Street and also on Stephen Street Upper.

Q.46 Councillor Mannix Flynn

Can the manager remove the rubbish that's been dumped in and around Cathedral View? The vacant site there which is now owned by the Peter McVerry trust is becoming a dumping ground for rubbish this area need to be monitored and put on the watch in order to stop this antisocial behaviour.

Reply:

The Cathedral View area is serviced weekly by Waste Management Services Division and monitored regularly by the South East Area Litter Warden. The Litter Warden will continue to monitor this area to remove and investigate dumped bags.

The City Council approved the disposal of this site to the Peter McVerry Trust in December 2018. It is anticipated that Peter McVerry Trust will commence the construction of 8 units on this site in September, 2019.

The Public Domain Unit will arrange the installation of a temporary CCTV to monitor the illegal dumping at this location. Footage from this camera may assist in identifying the offenders or the presence of the camera and signage will at least act as a deterrent.

Q.47 Councillor Mannix Flynn

Can the manager issue a full report with regard to the leasing out our licensing of Merrion Square Park on Easter weekend for a commercial event by Cadburys Easter eggs this park was turned into a commercial entity promoting the consumption of chocolate eggs aimed at children and this report include what costs were incurred by the company and how much did the company contribute to Dublin city council.

Reply:

The Cadbury Easter Egg Hunt, is a family event in aid of the charity Barnardos and took place in Merrion Square on Easter weekend on the 19th and 20th April 2019, with setting up for the event taking place on the 18th April. The event was managed on behalf of Cadburys by Catalpult.

It is a requirement that any individual / company / organisation who wishes to hold any event, commercial / promotional activity, photoshoot or filming in Dublin City Council parks, makes an application to Parks for an event permit. The permit is issued subject to a number of terms and conditions, including the requirement for insurances, indemnities, waste management arrangements and payment of the requisite fee for the event, where applicable. As Cadbury was the principal applicant and it was ticketed as a 'commercial' event and, a fee of €3,690 incl. VAT @ 23% was charged for the three days from 18th to 20th April 2019 inclusive.

Q.48 Councillor Chris Andrews

Can the manager give an update on the application of the resident in details supplied for installation of shower on medical grounds and plaster the walls in the sitting room as the walls currently are of only plaster board which is cracking?

Reply:

An application for the installation of a shower under our Mobility Programme has been received by Housing Maintenance. The survey has been completed and this application is

due for assessment within the next two weeks. The applicant will be notified in writing of the outcome of the assessment.

Housing Maintenance has no prior record of an issue with the plasterwork in the sitting room of this dwelling. This repair request has now been logged and will be attended to by Housing Maintenance depot.

Q.49 Councillor Chris Andrews

Can the manager arrange to install a ramp at front door so she can get her electric wheel chair over the lip of front door and install a walk in shower with seating to allow her wash at details supplied?

Reply:

Adaptations to City Council dwellings are carried out under our Mobility Programme. Housing Maintenance has no record of an application from this tenant to date. An application has been forwarded to the tenant for completion and return. It should be noted that an Occupational Therapist report is also required before ramps can be installed in dwellings.

Q.50 Councillor Chris Andrews

Can the manager have the tree in George Reynolds, which is shredding the Irish flag, cut back as the branches rip it when it is flying and it looks extremely neglected?

Reply:

The tree at this location will be pruned over the coming weeks,

Housing Maintenance Mobile Crew will inspect this tree and prune where required.

Q.51 Councillor Chris Andrews

Can the manager arrange to have a Dublin Bikes station installed on Clanbrassil Street Lower close to the junction with Daniel Street or close to the junction with Lombard Street West and does the manager have a timeline for the installation in this area and what is the criteria by which an area gets a Dublin Bike station?

Reply:

Any further growth of the Just Eat dublinbikes scheme in the city is dependent on the identification of additional sustainable funding for capital and operational costs. This work is ongoing and is in addition to measures to finance the existing bike scheme in its current format. A further factor that must be considered is the impact of station less bike hire on the Just Eat dublinbikes business and operational model. There is therefore no definite timeline in place for the delivery of station extension to Clanbrassil Street or environs. Station locations are determined at the detailed design stage of planned expansion.

Factors that are taken into account in selecting station locations include some of the following criteria:

1. An analysis of the population and employment levels in the locality of the proposed station, i.e. close proximity to where people live and work, and attractors such as tourist destinations, and community and leisure facilities.
2. Access of the location to cycle lanes and tie in with the Strategic Cycle Network.
3. The physical space available at a location to accommodate a bicycle station and allow access to it by maintenance vehicles.
4. The requirement to avoid the possibility of disruption at the location during future public transport or public realm upgrades.
5. The avoidance of conflict with existing or future proposed traffic management proposals and in particular with traffic management proposals during public transportation ground works.

6. An analysis of the existing or future proposed planning initiatives within the local area which could require a physical change at the location or signal a future opportunity to incorporate a station.
7. The avoidance of disruption to underground services at the locations proposed.
8. The avoidance of any disruption to other users of the public area, in particular persons with visual or mobility difficulties.

Q.52 Councillor Chris Andrews

Can the manager arrange to have the drains at 55 O'Rahilly House in Ringsend cleared and repaired as when the sink is emptied stagnant water comes up in the shower tray and is exceptionally strong and smells toxic and dangerous to inhale.

Reply:

Housing Maintenance has no prior record of this issue. A request for our Choke Car to attend and clear the drain has now been logged. The matter will be attended to.

Q.53 Councillor Chris Andrews

Can the manager arrange to have the drain outside the front door of 56 O'Rahilly House unblocked as the balcony floods with heavy rain?

Reply:

Housing Maintenance has no prior record of this issue. A request for our Choke Car to attend and clear the drain has now been logged. The matter will be attended to.

Q.54 Councillor Chris Andrews

Can the manager arrange to have the pavement outside 4 and 5 Leukos Road in Ringsend levelled as it is a trip hazard?

Reply:

This will be inspected and repairs scheduled as necessary.

Q.55 Councillor Chris Andrews

Can the manager arrange to have the tree cut back at 28 Cathedral View Walk as its branches are hitting this home?

Reply:

The tree in question has been listed for pruning over the coming weeks.

Q.56 Councillor Chris Andrews

Can the manager have the casing for the water pipes into the toilet repaired as it was damaged and not repaired after a problem in the toilet was repaired?

Reply:

Housing Maintenance has no prior record of this issue. A request has now been logged. The matter will be investigated and any necessary works carried out.

Q.57 Councillor Patrick Costello

To ask the manager to increase the crossing time for pedestrians and cyclists crossing at Leeson Street Bridge, there is a significant volume of cyclists and pedestrians here during peak times and an increase in time and frequency of crossing would help make it safer.

Reply:

The council's maintenance contractors went out on site and identified a damaged connection for the physical bicycle detector loop on the ground. This has been repaired and verified. This will result in improved bicycle detection resulting in improved crossing conditions. The operation of the junction has been reviewed and the phasing has been revised to enable an additional crossing phase for pedestrians and cyclists. This will increase the frequency at

which pedestrians and cyclists are able to cross during a cycle period. Furthermore the coding of this signalised junction is subject to a coding upgrade which will facilitate the use of a radar unit (bicycle detection device) which will detect cyclists and inform the controller to demand the pedestrian and cyclist crossing at this junction. The coding upgrade is scheduled to be installed in June.

Q.58 Councillor Patrick Costello

To ask the manager if Palmerston Road has been assessed for repairs, what priority has been given to it, and when it is likely to be repaired?

Reply:

Palmerston Road has not been assessed; it is currently logged for inspection.

Q.59 Councillor Patrick Costello

To ask the manager to include the following location in the next batch of bike stands:

- 1) 52 Grosvenor Road - D06 PX30 - outside Rathgar Parish Centre.
- 2) Bushes Lane, Grosvenor Villas - D06 RY23 - outside Ashbrook Tennis Club.
- 3) Opposite 54 Kenilworth Square South - no Eircode available - at entrance to St. Mary's playing fields.

Reply:

The locations will be examined for their suitability to install cycle parking infrastructure and if deemed appropriate, will be included in a future installation batch of the On-Street Cycle Parking Project.

Q.60 Councillor Mary Freehill

To ask the manager to request an urgent meeting with Irish Water to discuss the serious hold up in carrying out work on the underground Swan River. Irish Water have been promising flood prevention work since 2011, every time that I make enquiries I am told that they are going to tender for survey work. As they are now not in a position to give letters of comfort to residents along the route, it's time that we urgently meet them and that they answer the people of Rathmines and Rathgar.

Reply:

All matters relating to the combined sewer network in the Rathmines and Pembroke Catchment, including the issue of sewer flooding, is a matter for Irish Water. Under a Memorandum of Understanding with Irish Water Dublin City Council continue to work closely with Irish Water in relation to flood risk and related matters. Irish Water is currently engaged in an extensive catchment study of the area. In light of the above question, I will request an update report on this catchment from Irish Water for the elected members.

Q.61 Councillor Claire Byrne

To ask the Area Manager can he please help to support the new Portobello Tidy Towns Committee by working with the group to explore ways to remove existing and excessive graffiti in Portobello area and to minimise further graffiti in the neighbourhood.

Reply:

The Public Domain Unit will set up a meeting with the Portobello Tidy Towns Committee to consider the options available to address the ongoing problems of graffiti in the area. We have written to local residents and businesses to ask them to remove graffiti from their premises. It should be noted that it is the responsibility of the property owner to have graffiti removed.

If the group could make contact with the Public Domain Unit we will assist where possible.

Cllr. Byrne has asked Fiona, the new person on the Portobello Tidy Towns to make contact with us, and we have agreed and hope to meet with them in the coming weeks to advise on setting up, projects to do etc.

Q.62 Councillor Claire Byrne

To ask the Area Manager can he please clear the grass verges on Daniel Street and Harty Place as soon as possible.

Reply:

Waste Management Services had the grass cleared from the channels and footpaths in these streets on the 2nd May 2019.

Q.63 Councillor Claire Byrne

To ask the Area Manager if he could please clear the rear garden of the following tenant (details supplied). The resident has a disability and can't address this herself, and the particular bush keep growing very large and is blocking her light.

Reply:

The maintenance of gardens is the responsibility of the tenant. Housing Maintenance are not in a position to take on this responsibility.

Q.64 Councillor Claire Byrne

To ask the Area Manager can he please address the issue of cars parking on the 2nd right hand corner after you enter New Street Gardens? Cars are parking here despite the double yellow lines, and are blocking the dipped curb here that is essential for residents with disabilities to get up and down the pathways. Bollards on the pathway that are wide enough for wheelchair access could help here. Can the Area Manager look into this as a matter of urgency please?

Reply:

Dublin Street Parking Services have been instructed to monitor the location and to take enforcement action where necessary.

Q.65 Councillor Claire Byrne

To ask the Area Manager if he could please investigate the serious issue of large groups of people regularly harvesting shellfish by hand along the shores of the Irishtown Nature Reserve, can he outline the legalities around this type of shellfish harvesting, the biodiversity impact of this activity, and what can be done to address this.

Reply:

As this location is within a Natura 2000 site protected under the European Union Birds Directive, the South Dublin Bay and River Tolka Estuary Special Protection Area (SPA) (Site Code No. 004024), such activities described pose a threat to biodiversity by depleting the food supply of protected birds.

The Chief Parks Superintendent has notified in writing both the National Parks and Wildlife Service's Dublin Division and the Gardaí at Irishtown for further investigation under the European Union (Birds and Natural Habitats) Regulations 2011 to 2015.

In order to address the matter, the Gardaí have requested that people should report any details of suspected organised illegal shellfish harvesting taking place in or near the SPA as promptly as possible to enable them to investigate the matter and, if warranted, to prosecute any criminal activities.

Q.66 Councillor Claire Byrne

To ask the Area Manager can he please reinforce the 3.5t limit on Bath Street, perhaps by replacing the two small signs with one larger signs, and can he please look at 30km per hour

speed limits in the area as a way to minimise the impacts of large trucks speeding through the neighbourhood.

Reply:

Bath Street has been included in the fourth phase of the 30 Km/h Speed Limit introduction. This proposal will be going for public consultation during summer 2019. Following the adoption, and sealing of the new Bye-Laws in the autumn 2019, works will commence to erect the relevant signage in the new areas during summer 2020.

Signage at this location has been doubled up as per previous recommendations. Larger signage is only installed when roads have a higher speed limit (above 60Km/h).

Q.67 Councillor Kieran Binchy

To ask that the manager address the poor state of the road surface at details supplied.

Reply:

This will be inspected and repairs scheduled as necessary.

Q.68 Councillor Kieran Binchy

To ask the manager if the pavement at details supplied can be put back to its original state following being dug up by Irish Water - Irish Water stated to the residents that it was for the DCC to put it back to its original state

Reply:

This will be examined to determine who is responsible for this repair and appropriate action will be taken.

Q.69 Councillor Kieran Binchy

To ask the manager to address the following:

Residents of the top floor of the below block details supplied have pointed out that bars between balcony and a 30 foot + drop are rusted away and have given way in some instances. They are fearful that their children could have a serious accident if a bar gives way. Can bars at this and neighbouring blocks which have similar features be inspected and urgently replaced as necessary?

Reply:

Housing Maintenance Engineering Unit are making arrangements to have the balcony railings / bars at this location inspected. Any repairs or replacement of these railings will be carried out

Q.70 Councillor Kieran Binchy

To ask the manager to address the following:

Tenant at the below block (details supplied) reported a long campaign to secure a green and brown bin at the complex. Can the council confirm that green and brown bins are in place at all of its multiple unit locations and if not that steps will be put in place to provide same. This seems essential to minimise waste going to landfill.

Reply:

Green and brown bins have been installed in *details supplied City Council flat complexes.

Of the 195 citywide flat complexes all have grey bins for residual waste materials. Green bins for recycling materials have been installed in 107 complexes which represents 55% of the total. 49 of these complexes are flat complexes and 58 are older persons' complexes. The flat complexes where green bins are mainly located are in the South Central and South East Areas. The green bins are 1100L bins and are collected every two weeks.

Plans are being progressed to provide the green and brown bin installation and collection system at all locations on a citywide basis. A pilot has begun in the South East Area and 20 complexes to date have received brown bins and green bins if not already in situ. Presentation by Voice Ireland for information purposes will be undertaken in the coming two months to the remaining flat complexes in the South East Area and the pilot will be evaluated on completion of this area.

Q.71 Councillor Kieran Binchy

To ask the manager to address the following:

A frequently-used way when walking from our part of Portobello to the city centre - the section of Arnott Street highlighted in the image attached. It is not pedestrian-friendly, in particular for people with buggies / wheelchairs / walkers and for those who just want to walk next to each other. The sidewalk is very narrow. Couldn't this be improved, for instance by removing the three parking spots and use the space to have a wider sidewalk on the other side? And, of course a ramp here right at the entrance would be a very good signal to drivers they are entering a residential area, and should slow-down.

Reply:

This query will be added as a service request to the Traffic Assets Management System (TAMS) and will be assessed by an Area Engineer to determine what action is necessary.

Q.72 Councillor Kieran Binchy

To ask the manager to address the following:

The crossing of details supplied 1 with details supplied 2: hard to comprehend that there are only two places to cross with traffic lights for pedestrians at this very busy point. If the missing ones are ever installed, it would be great if they were smartly programmed (not too dependent on button-pressing), preventing the long waits which many pedestrian lights in Dublin have; and let them stay long enough green for older people to cross.

Reply:

The junction at details supplied 2 / 3 / 4 / 5 is a signalised junction. There are large pedestrian volumes at this junction during peak hour periods with dedicated signalised green man crossing at two locations. This junction is within Corridor 12 for the Rathfarnham to the City Centre route. This junction will be upgraded and measures put in place to improve conditions for buses, cyclists and pedestrians as part of the Bus Connects project. There are two options proposed for this junction:

Map 15a

The "Emerging Preferred Route" document indicates that there will be four green man crossings (full wrap around pedestrian crossing). The additional green man crossings would connect details supplied 5 and details supplied 2 on the east side. The remaining additional green man crossing would be on the northern side of the junction.

Map 15b

The "Emerging Preferred Route" document indicates that there will be three green man crossings with the additional green man crossings connecting details supplied 5 and details supplied 2 on the east side.

These proposals will result in safer crossing conditions for many people walking from Portobello and Rathmines towards the city centre.

Corridor 12 – Rathfarnham to City Centre

See Map 15a and 15b

<https://www.busconnects.ie/media/1453/12-busconnects-cbc-rathfarnham-to-city-centre-040119-fa.pdf>

Q.73 Councillor Kieran Binchy

To ask the manager if a filter light can be provided at detail supplied, as there is significant details in crossing at this busy junction due to poor traffic management.

Reply:

The following report was received from DCC's Intelligent Transport Systems (ITS) Section on the above request:

The ITS Officer reports that as the main road inbound from Ringsend is a bus route, operating a right turn filter outbound along this route would add delays to the bus journey times. Therefore, it is not recommended to add a right turning filter to this junction.

Q.74 Councillor Kieran Binchy

To ask the manager if more attention can be paid to details supplied as many of the residents have reported that the flats are in extremely poor condition, suffering from dampness and infested with pests.

Reply:

Housing Maintenance Caretaking Service attends to these flats every day Monday to Friday. The common areas and stairwells are swept daily and washed on a weekly basis. Euro bins are provided for waste disposal and the introduction of brown and green bins has been rolled out in this complex.

Housing Maintenance Mobile Crew monitor this complex in relation to rats. It is baited on a three to four week basis, the last time 17th April 2019.

Any reports of dampness are logged and inspected by Housing Maintenance in relation to any required works.

Q.75 Councillor Kieran Binchy

To ask the manager if more attention can be paid to street cleaning at *details supplied as many of the residents have reported that it is not satisfactory.

Reply:

Waste Management Services had *details supplied cleaned on the 2nd May 2019. We will have this street monitored and arrange more frequent cleaning there when necessary.

Q.76 Councillor Kieran Binchy

To ask the manager about the housing position of details supplied as she is eight years on the housing list living with her parents and sibling, the lady in question herself has 3 children, this is an unacceptable overcrowding situation. Surely 7 people in a 2 bedroom flat is unacceptable to Dublin City Council.

Reply:

The above applicant is on the Housing List with an application date of 30th June 2011 the applicant holds the following positions on this list;

Area	Bed size	Position
Area K	3	174
Area M	3	65

Based on this position it may be some time before the applicant is reached for an offer of social housing.

Dublin City Council acknowledges there is significant overcrowding in this property.

This applicant is currently eligible for the Housing Assistance Payment (HAP) Scheme which will provide the applicant with financial support towards the cost of renting a property. Should the applicant wish to be considered for this scheme she must present to the Allocations Section with current income details and a Housing Advisor can provide information and advice on the scheme.

Dublin City Council allocates properties based on time on the list and currently there are applicants on the waiting list of longer standing who have to be considered as suitable vacancies arise. It is not possible to indicate accurately the prospect of an offer for any applicant. The number of vacancies arising will be a determining factor in the length of time applicants could expect to be on the waiting list.



South East Area - TAG Meeting Minutes for Noting

(Area Committee Date: 08/07/2019)

Item	Enquiry	SP Ref	Topic	Road	Post	Request Description	Tag Result	Tag Comments	Request By	Received	Sec
1	7000181		Double Yellow Lines (Extend)	CREMORNE (SE)	Dublin 6	Extend to the end of the road at Cremorne Apartments	Recommended	Double yellow lines: Commencing from 7 metres North East of lamp standard 9, on the opposite side of the carriage way, install 14 metres of double yellow lines in a north east direction. This request is recommended to allow refuse trucks and other service vehicles to access the apartments in Cremorne.	Member of the Public	06/11/2017	0
2	7000723		Double Yellow Lines (Extend)	RICHMOND MEWS (SE)	Dublin 6	Extension of the double yellow lines, yellow lines all down one side, needs continuation on the opposite side.	Recommended	SR recommended: From a point at the corner of front wall and gable end wall of no 39 Richmond hill (Richmond hill/Richmond mews), on the west side of the carriage way, extend the current double yellow lines 3.6 metres in a northern direction. Stat: Extend double yellow lines on the west side of Richmond Mews, from the existing double yellow lines at the corner of 39 Richmond Hill, for 3.6m northwards.	Member of the Public	04/12/2017	0
3	7000963		Yellow Box	SHELBOURNE ROAD (SE)	Dublin 4	Yellow box at entrance to Ballsbridge college carpark	Not Recommended	The traffic flow from the Ballsbridge college is not significant and the road does not meet the minimum criteria of serving fifty houses/spaces. A yellow box is therefore not recommended. The warrant is not met for a yellow box. Yellow boxes are intended to prevent blocking of junctions. Side road traffic flows should be significant and the side road should serve a minimum of fifty houses or a major traffic generating facility. This guideline is in place to avoid a proliferation of yellow boxes in the city.	Member of the Public	19/12/2017	0
4	7000992		Traffic Calming	CAMBRIDGE VILLAS (SE)	Dublin 6	Introduce traffic calming on the road.	Not Recommended	A speed survey was carried out on the 29th May 2019. The resultant 85% percentile speed did not exceed the speed limit and the road does not have a straight run of a minimum 200m. It is therefore not recommended to introduce additional traffic calming measures, as they do not meet the warrant.	Member of the Public	21/12/2017	0
5	7001514		Yellow Box	SYDNEY PARADE AVENUE (SE)	Dublin 4	For entrance to Martello Mews.	Not Recommended	Yellow boxes are intended to prevent blocking of junctions. Side road traffic flows should be significant and the side road should serve a minimum of fifty houses or a major traffic generating facility. This guideline is in place to avoid a proliferation of yellow boxes in the city. A yellow box at the junction Martello Mews and Sydney Parade Avenue is not recommended as the location does not meet the warrant.	Member of the Public	31/01/2018	0
6	7001552		Disab Park Bay Residential	BEECHWOOD ROAD (SE)	Dublin 6	On the road	Recommended	Rescind Pay and Display and Permit Parking from in line wiith the common boundary between No.'s 9 and 10 Beechwood Road, extending eastwards for 6 metres. Disabled Parking Bay recommended from in line wiith the boundary between No.'s 9 and 10 Beechwood Road, extending eastwards for 6 metres.	Member of the Public	05/02/2018	0
7	7001687		P&D/Permit Park (Change Hours)	LANSDOWNE PARK (SE)	Dublin 4	For extension of the operational hours.	Awaiting Survey	Recommended subject to ballot of residents.	Member of the Public	14/02/2018	1
8	7002180		P&D/Permit Park (Change Hours)	COLLIER'S AVENUE (SE)	Dublin 6	Extend Hours to include sundays and 24 hours a day	Recommended	Accepted at ballot by residents, hours Mon-Sun 07.00-24.00. 31 on the register, 6 votes returned, 5 for, 1 spoilt.	Member of the Public	26/03/2018	1



South East Area - TAG Meeting Minutes for Noting

(Area Committee Date: 08/07/2019)

Item	Enquiry	SP Ref	Topic	Road	Post	Request Description	Tag Result	Tag Comments	Request By	Received	Sec
9	7002184		Disab Park Bay Residential	CREIGHTON STREET (SE)	Dublin 2	outside no. 9	Recommended	Rescind Pay and Display and Permit Parking from common boundary between No.'s 8/9 Creighton Street extending northwards for 6 metres. Disabled Parking bay recommended from common boundary between No.'s 8/9 Creighton Street extending northwards for 6 metres.	Member of the Public	26/03/2018	0
10	7002548		P&D/Permit Park (Change Hours)	LEINSTER ROAD (SE)	Dublin 6	Extend parking hours to 7.00 - 24.00 Mon-Fri and weekends and public holidays.	Awaiting Survey	From Harold's Cross Road to Junction with Leinster Road West both sides of the road it is recommended to change the hours of the existing pay and display scheme from 7 to 24 , mon to sun. This is subject to a bllot of the residents.	Councillor	24/04/2018	2
11	7002570		P&D/Permit Parking (Rescind)	CLYDE LANE (SE)	Dublin 4	space adjacent to No. 20	Recommended	Due to the difficulties that the pay and display parking bay is causing at the entrance of this property the following changes are recommended: STAT as follows: Rescind 6.5m of pay and display scheme and install double yellow lines as follows: North side, from a point 3m west of the common boundary of house nos. 19/20, for 6.5m westwards.	Member of the Public	26/04/2018	0
12	7003237		Double Yellow Lines	PEMBROKE LANE (SE)	Dublin 4	outside No. 73 (door opens onto parking area).	Recommended	Service Request recommended: Double Yellow Lines: 73 Pembroke Lane From a point commencing 5.5 metres west of the east gable end wall of number 73 Pembroke Lane, on the North side of the carriageway, rescind 3 metres of P&D and permit parking in a Westward direction. From a point commencing 5.5 metres west of the east gable end wall of number 73 Pembroke Lane, on the North side of the carriageway ,install 3 metres of Double Yellow Line in a Westward direction. (To allow access through front door)	Member of the Public	07/06/2018	0
13	7003731		Pedestrian Crossing	KIMMAGE ROAD WEST (SE)	Dublin 12	installation of pedestrian markers at entrance to Ben Dunne Gym	Not Recommended	SR NOT RECOMMENDED – After a site visit on Thursday 13/06/19 the Area Engineer spent one hour observing the crossing. In that hour the Engineer observed the following •Dished Kerbs on both the west side and east side of the entrance •The cars exiting the gym are travelling at a very low speeds as there is a ramp approx. 37m north of the junction. •There have been zero reported accidents at this location according to our collision records •During this hour only 10 pedestrians used this crossing and had zero difficulty doing so. For these reasons it would not be recommended to make any changes to this location at present	Member of the Public	11/07/2018	0
14	7005340		Speed Ramps	CASHEL ROAD (SE)	Dublin 12	On the road	Not Recommended	SR not recommended - The area engineer has noted that this part of Cashel Road doesn't meet the criteria for speed ramps as it doesn't have a straight road of more than 200m.	Internal	09/10/2018	0



South East Area - TAG Meeting Minutes for Noting

(Area Committee Date: 08/07/2019)

Item	Enquiry	SP Ref	Topic	Road	Post	Request Description	Tag Result	Tag Comments	Request By	Received	Sec
15	7005460		Disab Park Bay Residential	HADDINGTON ROAD (SE)	Dublin 4		Recommended	Rescind 6 metres of Pay an Display and Permit Parking centred on dwelling No. 33. Disabled Parking Bay recommended for a distance of 6 metres centred on dwelling No. 33.	Member of the Public	16/10/2018	0
16	7005772		Traffic Calming	CAPTAIN'S ROAD (SE)	Dublin 12	Raising centre of roundabout, slow down signs or other traffic calming measures.	Recommended	SR recommended. After a site visit the Area Engineer has noted that there is an issue at this junction with the roundabout. This has been put forward for the 2019 Works program subject to funding.	No Code Allocated	05/11/2018	0
17	7005905		Yellow Box	TRITONVILLE ROAD (SE)	Dublin 4	at Lansdowne Hall Apartments.	Not Recommended	Service request not recommended: Sandymount Castle Rd: Traffic calming measures. Staggered P&D and permit parking acts as a traffic calming measure. It reduces carriage way width and raises driver awareness. Therefore it is not recommended to remove existing staggered parking. It is currently Dublin City Councils Policy not to have Stop/Yield signage at all junctions on internal roads within residential areas as this would lead to a proliferation of the same. It is not recommended to install any additional measures at this location. Any isolated incidents of driving without due care should be reported to the Gardaí. The onus is on the motorist to drive with due care and at a speed appropriate for the prevailing conditions.	Member of the Public	12/11/2018	0
18	7005945		TAG General Engineer Query	RATHGAR PLACE (SE)	Dublin 6	request for parking prohibitions on Rathgar Place as parked cars causing difficulty accessing homes.	Not Recommended	It is not recommended to install parking restrictions, where restrictions are already covered under the law. Under The Road Traffic (Traffic & Parking) Regulations, Section 36 paragraph(2) k; (k) in a manner in which it will interfere with the normal flow of traffic or which obstructs or endangers other traffic; In addition, under The Road Traffic (Traffic & Parking) Regulations, Section 36 paragraph(2) g; (g) "A vehicle shall not be parked in any place, position or manner that will result in the vehicle obstructing an entrance or an exit for vehicles to or from a premises, save with the consent of the occupier of such premises;" Infringements should be reported to Dublin Street Parking Services tel no. 01 6022500 or the Gardaí as they occur.	Member of the Public	13/11/2018	0
19	7005985		Disab Park Bay Residential	OAKLANDS PARK (SE)	Dublin 4	on the road	Recommended	Rescind Pay and Display and Permit Parking from the pedestrian entrance at No. 47 Oaklands Park extending southeast for 6 metres, Disabled Parking bay recommended from the pedestrian entrance at No. 47 Oaklands Park extending southeast for 6 metres,	Member of the Public	15/11/2018	0



South East Area - TAG Meeting Minutes for Noting

(Area Committee Date: 08/07/2019)

Item	Enquiry	SP Ref	Topic	Road	Post	Request Description	Tag Result	Tag Comments	Request By	Received	Sec
20	7006018		Traffic Calming	BEAVER ROW (SE)	Dublin 4	Institute traffic calming measures at this location such as a one-way system, 30km/h limit, or heavy vehicle restrictions.	Not Recommended	<p>One way traffic systems typically encourages traffic to flow at greater speeds and does not contribute to enhance the road safety for pedestrians and cyclists. Given the location of Beaver Row, if it were to be made into a one way street it could result in significant inconvenience to public transport routes, residents and business and is likely to result in further traffic congestion at nearby junctions due to extra distance travelled. Therefore the request for a one way system has not been recommended.</p> <p>Any vehicle over 3.5t is currently not permitted on Beaver Row as indicated by sign RUS 015 "3.5t" which indicates that vehicles whose gross weight exceeds that specified on the sign are prohibited, save for certain exemptions. Road Traffic Act S.I. No. 182/1997 - Road Traffic (Traffic and Parking) Regulations, 1997 17. Weight Restriction on Vehicles Entering a Road 17. (1) Where traffic sign number RUS 015 is provided at the entrance to a road, the driver of a vehicle, the unladen weight of which exceeds the weight specified on the sign, shall not proceed beyond the sign. (2) Sub-article (1) shall not apply where it is necessary for a vehicle to enter a road solely for the purpose of gaining access to or egress from premises accessible only from that road.</p> <p>Illegal parking should be reported to the Gardai or Dublin Street Parking Services (tel no. 01 6022500), for enforcement under the law. Section 36 (2) Road Traffic Act a vehicle shall not be parked - (i) on a foot way, a grass margin or a median strip.</p> <p>With respect to the request for 30km/hr, Beaver Row will be included in the fourth phase of the 30 Km/h Speed Limit introduction. This proposal will be going for public consultation during summer 2019. Following the adoption, and sealing of the new Bye-Laws in the autumn 2019, works will commence to erect the relevant signage in the new areas in summer 2020</p>	Minister	15/11/2018	0
21	7006121		Children Crossing Sign	KERLOGUE ROAD (SE)	Dublin 4	"Slow - Children at Play" sign for the road.	Recommended	Following investigation, a "Children Crossing" sign (W142) and Cul de Sac sign (F350) are recommended at the top of Kerlogue Road (facing West).	TD	20/11/2018	0
22	7006355		Parking Restrictions	SEAN MOORE ROAD (SE)	Dublin 4	narrow road exiting Beach Road on to Church Road difficult.	Not Recommended	After a several site visits during the am peak, pm peak and off peak, no traffic issues were observed at the location. It is not recommended to install Double Yellow Lines on Church Avenue, as there is sufficient room currently to facilitate cars without causing a hazard, and removing parking will only result in faster vehicle speeds at this location.	Councillor	04/12/2018	0



South East Area - TAG Meeting Minutes for Noting

(Area Committee Date: 08/07/2019)

Item	Enquiry	SP Ref	Topic	Road	Post	Request Description	Tag Result	Tag Comments	Request By	Received	Sec
23	7006364		Children Crossing Sign	BRIGHTON SQUARE SOUTH (SE)	Dublin 6	on the road.	Recommended	Following investigation a "Children Crossing" sign (W142) is recommended at Garville Avenue (at junction with Rathgar Road) and at Brighton Square (at junction with Terenure Road Nord/Harold's Cross Road), as it is the entrance to a housing estate from a main traffic route.	Councillor	04/12/2018	0
24	7006884		Yellow Box (Extend)	RATHMINES ROAD LOWER (SE)	Dublin 6	The yellow box at the junction of Rathmines/Rathgar Rd be extended eastwards to allow traffic turn out of Rathmines Rd Upper	Recommended	SR Recommended: Junction of Rathgar Rd and Rathmines Road Upper: Yellow Box on Rathmines Road Lower at the junction with Rathgar Road to be extended by 7 Metres in an Eastwards direction to allow for traffic to turn out of Rathmines Rd Upper. This will reduce delays to the inbound bus service route 140.	Internal	16/01/2019	0
25	7006916		Traffic Lights (new)	CITY QUAY (SE)	Dublin 2	Stop light for cyclists from the east direction, to improve safety at the pedestrian bridge.	Not Recommended	During the site visit It was observed that issue has been resolved. At the junction City Quay with Lombard Street East cycle signals have been installed to prevent any collision between pedestrians and cyclists. Therefore no further action is required at this time.	TD	17/01/2019	0
26	7006922		Double Yellow Lines	MOREHAMPTON LANE (SE)	Dublin 4	Extend DYs down lower part of the lane.	Recommended	Extend double Yellow lines: Commencing at a point at Lamp Standard 7 on the Northeast side of the carriageway, install double yellow lines for a distance of 35.8 Metres in a Northwest direction to a point at Lamp Standard 8.	Member of the Public	18/01/2019	0
27	7007030		Disab Park Bay Residential	MARTIN STREET (SE)	Dublin 8	Disabled bay for this location, due to non-residents parking on street.	Recommended	Rescind Pay and Display and Permit Parking from common boundary between No.'s 12/14 extending southwards for 6 metres. Disabled Parking Bay recommended from common boundary between No.'s 12/14 extending southwards for 6 metres.	Member of the Public	23/01/2019	0
28	7007233		Right Turn Filter Light	SUSSEX ROAD (SE)	Dublin 4	Dedicated right turn traffic light for this junction.	Not Recommended	At the moment, vehicles on Sussex Road can make a right turn onto to Leeson Street when it is safe to do. Before this junction, there is a pedestrian crossing on Leeson Street inbound which can make it easier for cars to make a right turn from Sussex Road without any problems. For this reason, there is no requirement for a right turn filter from Sussex Road to Leeson Street otherwise this would create a huge tailbacks on Sussex Street. The Area Engineer does not recommend traffic signals at this location.	Member of the Public	04/02/2019	0



South East Area - TAG Meeting Minutes for Noting

(Area Committee Date: 08/07/2019)

Item	Enquiry	SP Ref	Topic	Road	Post	Request Description	Tag Result	Tag Comments	Request By	Received	Sec
29	7007331		Double Yellow Lines	TEMPLE GARDENS (SE)	Dublin 6	DYs at junction with Milltown Path.	Recommended	<p>Bollards are only considered in exceptional circumstances, where there is a demonstrable health and safety issue. They are not provided as a measure to prevent damage to private property. Bollards are not accident prevention devices and are not impact resistant. They are not deemed appropriate in this instance. It is not recommended to install bollards at the base of the brick pier at junction of Milltown Path with Temple Gardens(House no. 20)</p> <p>During a site inspection on Milltown Path at the junction with Temple Gardens (between Temple Gardens and Palmerstown Lane) it was found few cars parked right up to the entrance of the road, car who can obstruct access for long vehicles. In order to facilitate a easy access, it's recommended to install Double Yellow Lines at the entrance of Milltow Path (between Temple Gardens and Palmerstown Lane).</p> <p>Stats: On the Eastern Side of the carriageway of Milltow Path : From a point commencing 4.4 meters South of Lamp Standard 6, install 5.0 meters Double Yellow Lines in a South direction of Milltow Path. On the Western Side of the carriageway of Milltow Path: From a point commencing 4.4 meters South of Lamp Standard 6, install 5.0 meters Double Yellow Lines in a South direction of Milltow Path.</p>	Member of the Public	11/02/2019	0
30	7007340		Double Yellow Lines	BRICKFIELD DRIVE (SE)	Dublin 12	DYs for this junction.	Not Recommended	<p>SR not recommended - It is not DCC policy to introduce parking restrictions where restrictions are already covered under the law Under The Road Traffic (Traffic & Parking) Regulations, Section 36 paragraph(2) (i), it is illegal to park on a footway, a grass margin or a median strip" and (c) within 5 metres of a road junction; Infringements of the Act should be reported to the Gardaí or Dublin Street Parking Services Ph.6022500 for enforcement under the law. This area will be brought to the attention of our parking enforcement and will be asked to monitor the area closely</p>	Member of the Public	11/02/2019	0
31	7007360		P&D/Permit Park (Extend Area)	ARRANMORE ROAD (SE)	Dublin 4	Extend white boxes, or provide DYs, at end of road.	Recommended	<p>SR Recommended: Pay and Display and permit parking: Arranmore Road (SE)</p> <p>Commencing at a point 14 metres Southeast of lamp standard 1, on the Southwest side of the carriageway, install 20.5 metres of Pay & Display and permit parking in a Northwest direction with times of 08.00 to 18.30.</p> <p>Commencing at a at lamp standard 2, on the Northeast side of the carriageway, install 39.2 metres of Pay & Display and permit parking in a Northwest direction with times of 08.00 to 18.30.</p>	Member of the Public	12/02/2019	0
32	7007435		Yellow Box	MERRION ROAD (SE)	Dublin 4	Yellow box to allow vehicles exit from Sandymount Avenue.	Not Recommended	<p>Yellow box is not recommended where restrictions are already covered under the law .</p> <p>The junction between Sandymount Avenue and Merrion Road is provided with traffic lights.</p> <p>Issues relating to vehicles breaking the law should be referred to the Gardaí as they occur.</p>	Member of the Public	14/02/2019	0



South East Area - TAG Meeting Minutes for Noting

(Area Committee Date: 08/07/2019)

Item	Enquiry	SP Ref	Topic	Road	Post	Request Description	Tag Result	Tag Comments	Request By	Received	Sec
33	7007437		Yellow Box	AILESBURO ROAD (SE)	Dublin 4	To allow traffic coming from Sydney Parade to turn left for Merrion Road.	Not Recommended	Yellow box is not recommended where restrictions are already covered under the law . The junction between Ailesbury Road and Merrion Road is provided with traffic lights. Placing of a yellow box after the junction is also not recommended, because it could force outbound traffic to stop inside the junction and this would affect the junction layout by blocking Merrion Road and Ailesbury Road. It is also noted that the left turn filter is a flashing amber arrow which means vehicles from Ailesbury Road can only enter Merrion Road when it safe to do so. Issues relating to vehicles breaking the law should be referred to the Gardaí as they occur.	Member of the Public	14/02/2019	0
34	7007561		Parking Restrictions	BEAVER ROW (SE)	Dublin 4	Scheme to prevent dangerous & haphazard parking along the road.	Not Recommended	Illegal parking should be reported to the Gardai or Dublin Street Parking Services (tel no. 01 6022500), for enforcement under the law. Section 36 (2) Road Traffic Act a vehicle shall not be parked - (i) on a foot way, a grass margin or a median strip.	Member of the Public	21/02/2019	0
35	7007770		Parking Restrictions	RATHMINES ROAD UPPER (SE)	Dublin 6	Disabled Parking Bay,outside 16 to 22 upper rathmines road Also requesting one hour parking permitted restrictions	Recommended	Disabled bays already located in close proximity of this location so no further disabled bays required. Double Yellow Lines are recommended as follows: From a point commencing at the boundary line between 22 and 24 Rathmines road Upper, Install Double Yellow Lines on the East side of the carriageway for a distance of 18.6 Metres in a North direction along the kerb line (Meeting existing loading bay). Rathmines Road: Double Yellow Lines From a point commencing 2 metres North of the South gable end wall of number 37 Rathmines Road upper, on the west side of the carriageway, install 11 Metres of Double yellow line in North direction along the kerb line (Meeting existing Taxi bay). Rathmines Road: Double Yellow Lines From a point commencing 5.7 metres south of the boundary line between 312 Rathmines road Lower and 2 Rathmines road Upper, on the East side of the carriage way, Install 4.3 metres of Double Yellow Lines in a Southern direction. (Meeting existing bus bay).	Member of the Public	05/03/2019	0
36	7007785		Yellow Box	MACKEN STREET (SE)	Dublin 2	To allow residents in Eblana / Island Villas turn in to Hogan Avenue particularly during heavy traffic.	Recommended	Service request recommended: yellow box at the Junction of Hogan Street and Macken Street. From a point commencing 8 Metres south of lamp standard 29 on Macken street install 8 Metres of Yellow box on the west side of the carriageway of Macken Street only in a southwards direction.	Councillor	06/03/2019	0



South East Area - TAG Meeting Minutes for Noting

(Area Committee Date: 08/07/2019)

Item	Enquiry	SP Ref	Topic	Road	Post	Request Description	Tag Result	Tag Comments	Request By	Received	Sec
37	7007882		TAG General Engineer Query	TOWNSEND STREET (SE)	Dublin 2	blocking of car park entrances, loading & unloading of goods.	Recommended	The following are recommended: Loading Bay: From a point commencing 61.5 Metres East of Lamp Standard 15 on the North Side of the carriageway, install 12 Metres of Loading bay in and Eastwards direction with Hours of Operation as follows: 07.00 to 19.00 Hours. Double Yellow Lines: From a point commencing 6 Metres East of Lamp Standard 15 on the north side of the carriageway install 55.5 Metres of Double Yellow Lines in an Eastwards direction.	Gardai	12/03/2019	0
38	7007913		P&D Parking (Rescind)	DERRYNANE GARDENS (SE)	Dublin 4	Recently dished driveway. Unable to exit due to cars parking in pay and display.	Recommended	Service request recommended: 37 Derrynane Gardens: Rescind P&D and permit parking. Commencing at a point at the boundary wall of number 36 and 37 Derrynane Gardens, on the east side of the carriageway, rescind 8.2 metres of P&D and permit parking in a Southwards direction. This is to allow for recently approved permission of vehicular entrance to number 37 Derrynane Gardens.	Member of the Public	13/03/2019	0
39	7007915		Double Yellow Lines	CAMBRIDGE ROAD (SE)	Dublin 6	DYLs to prevent abandoned vehicles being parked at this location.	Not Recommended	Double yellow lines are provided to ensure the smooth flow of traffic and prevent congestion where parking causes congestion which would interfere with traffic flows on a daily basis. Following recent site visits at Cambridge Road, between Castlewood Avenue and Stables Lane, no adverse problems regarding parking were observed. A minimum width of 4.6m is required for single side parking; the average width along Cambridge Road is 5.5m and there is ample room for vehicles to get by. There are existing double yellow lines at the both entrance of the road. Therefore extension of the existing double yellow line are not recommended. Illegal parking or abandoned cars should be reported to the Gardai or Dublin Street Parking Services Ph. 01 6022500.	Member of the Public	13/03/2019	0
40	7007935		Double Yellow Lines	LANSDOWNE PARK (SE)	Dublin 4	opp. No.69	Recommended	Service request Recommended: Double Yellow Lines: Lansdowne park: From a location commencing 3.7 metres south of lamp standard 22 on the west side of the carriageway install 3.8 metres of double yellow line in a southwards direction.	Member of the Public	14/03/2019	0
41	7008091		Disab Park Bay Residential	MOUNTPLEASANT AVENUE UPPER (SE)	Dublin 6	56 upper mount pleasant ave	Not Recommended	Mountpleasant Avenue Lower: Rescind Pay & Display and permit parking: From a point commencing 8.7 metres north of lamp standard 3 on the East side of the carriageway, rescind 6 metres of Pay & Display and permit parking in a southwards direction. Disabled Bay: From a point commencing 8.7 metres North of lamp standard 3 on the East side of the carriageway, install 6 metres of disabled bay in a southwards direction and accompanied by the upright Disabled Persons' parking information sign.	Member of the Public	26/03/2019	0



South East Area - TAG Meeting Minutes for Noting

(Area Committee Date: 08/07/2019)

Item	Enquiry	SP Ref	Topic	Road	Post	Request Description	Tag Result	Tag Comments	Request By	Received	Sec
42	7008107		Disab Park Bay General	CLYDE ROAD (SE)	Dublin 4	25 Clyde Road, Dublin 4. There are currently two but an additional bay would help.	Recommended	Clyde Road: Installation of disabled bay: Recommended From a point commencing 5 metres east of lamp standard 14 on the south side of the carriageway, rescind 6 metres of Pay & Display and permit parking in an Easterly direction. From a point commencing 5 metres east of lamp standard 14 on the south side of the carriageway, install 6 metres of disabled bay in an Easterly direction and accompanied by the upright Disabled Persons' parking information sign.	Member of the Public	27/03/2019	0
43	7008219		Disab Park Bay General	MOREHAMPTON TERRACE (SE)	Dublin 4	Disabled parking bay for this location.	Not Recommended	Disabled Parking Bay: 58 Irishtown Road: SR Recommended Install a disabled bay on the Northeast side of the carriage way, Perpendicular (nose to kerb), commencing at the gable end boundary point of number 60 Irishtown road in a north-westerly direction for a distance of 2.4 metres wide with bay length of 6 Metres accompanied by the upright Disabled Persons' parking information sign. .	Member of the Public	02/04/2019	0
44	7008257		Parking Restrictions	LONDONBRIDGE ROAD (SE)	Dublin 4	Parking prohibitions to preserve access to complex for vehicles & wheelchair-users.	Recommended	During a site inspection on Londonbridge Road (on The Pumphouse location), it was found few cars parked right up to the entrance of this location, car who can obstruct access for the emergency vehicles. In order to facilitate access for the emergency vehicles it's recommended to install Double Yellow Lines at the entrance of The Pump House. See sketch attached. Stats: On the Western Side of the carriageway of Londonbridge Road : From a point commencing 4.7 meters North of Lamp Standard 11, install 19.7 meters Double Yellow Lines in a North direction. On the Eastern Side of the carriageway of Londonbridge Road: From a point commencing in line with the Southern gable of Syphon House, install 18.00 meters Double Yellow Lines in a South direction excluding the entrance to the Pumphouse.	Internal	04/04/2019	0
45	7008313		Double Yellow Lines	BAGGOT LANE (SE)	Dublin 4	At 14 Baggot Lane, Ballsbridge, Dublin 4.	Not Recommended	Not recommended: Dublin City Council's policy is to not introduce parking restrictions such as double yellow lines where restrictions are already covered under the law, as this would lead to a proliferation of same and additional expense due to maintenance, etc. Under Section 36 paragraph (2) (g) of the Road Traffic (Traffic & Parking) Regulations; "A vehicle shall not be parked in any place, position or manner that will result in the vehicle obstructing an entrance or an exit for vehicles to or from a premises, save with the consent of the occupier of such premises" In addition, under Section 36 paragraph (2) (k) of the Road Traffic (Traffic & Parking) Regulations; "A vehicle shall not be parked in a manner in which it will interfere with the normal flow of traffic or which obstructs or endangers other traffic." Infringements of the act should be reported to Dublin Street Parking Services tel. no. 01 6022500 or the Gardaí as they occur.	Member of the Public	08/04/2019	0



South East Area - TAG Meeting Minutes for Noting

(Area Committee Date: 08/07/2019)

Item	Enquiry	SP Ref	Topic	Road	Post	Request Description	Tag Result	Tag Comments	Request By	Received	Sec
46	7008342		P&D/Permit Park (Change Hours)	RATHMINES PARK (SE)	Dublin 6	Extend parking scheme times to 24 hours/7 days.	Awaiting Survey	Recommended to extend the hours of the Pay and Display and Permit Parking Scheme subject to a ballot of the residents concerned.	Member of the Public	09/04/2019	0
47	7008347		No Left Turn	RATHGAR ROAD (SE)	Dublin 6	No Left Turn required from end of Rathgar Road onto Grosvenor Road as cars are turning from Rathgar Road onto green pedestrian light on Grosvenor Road.	Recommended	Service request recommended: Rathgar Road: No Left Turn: Install no left turn signage (RUS 013: NO LEFT TURN) at the junction of Rathgar Road and Grosvenor road. This is to prevent traffic turning left from Rathgar Rd onto Grosvenor Road due to the acute angle and current ITS sequence set up.	Gardai	09/04/2019	0
48	7008380		P&D/Permit Park (Change Hours)	MACKEN STREET (SE)	Dublin 2	Change parking hours to 7am-Midnight, 7 days a week.	Awaiting Survey	Extension of hours to 7.00-24.00 Mon.-Sun. proposed, subject to ballot of residents indicating a majority in favour of the proposal.	Member of the Public	10/04/2019	0
49	7008445		Road Closure	MOUNT STREET CRESCENT (SE)	Dublin 2	Close off road to motor vehicles, and allow use by cyclists and pedestrians only.	Not Recommended	Service request not recommended: Mount Street Crescent: Closure of roadway to allow for Pedestrians and cyclists only. It is Dublin City Councils policy to promote all types of sustainable transportation within the city including cycling and walking. It is not recommended at this time to close this section of roadway to allow for pedestrians and cyclists only at present. However this correspondence will be passed to the sustainable transport unit (STU) as feedback going forward with future sustainable transportation schemes.	Member of the Public	12/04/2019	0
50	7008539		Double Yellow Lines (Extend)	ROSTREVOR ROAD (SE)	Dublin 6	Extend DYLS along lane to left, off main Rostrevor Road, to ensure access to laneway.	Not Recommended	Double Yellow lines : Not recommended: Dublin City Council's policy is to not introduce parking restrictions where restrictions are already covered under the law, as this would lead to a proliferation of same and additional expense due to maintenance, etc. Under Section 36 paragraph (2) (g) of the Road Traffic (Traffic & Parking) Regulations; "A vehicle shall not be parked in any place, position or manner that will result in the vehicle obstructing an entrance or an exit for vehicles to or from a premises, save with the consent of the occupier of such premises" In addition, under Section 36 paragraph (2) (k) of the Road Traffic (Traffic & Parking) Regulations; "A vehicle shall not be parked in a manner in which it will interfere with the normal flow of traffic or which obstructs or endangers other traffic." Infringements of the act should be reported to Dublin Street Parking Services tel. no. 01 6022500 or the Gardai as they occur.	Member of the Public	17/04/2019	0



South East Area - TAG Meeting Minutes for Noting

(Area Committee Date: 08/07/2019)

Item	Enquiry	SP Ref	Topic	Road	Post	Request Description	Tag Result	Tag Comments	Request By	Received	Sec
51	7008703		Double Yellow Lines	GREENFIELD PARK (SE)	Dublin 4	DYs to increase visibility and safety for vehicles entering & exiting the Crescent.	Not Recommended	Greenfield Park (SE): It is not recommended to install double yellow lines directly across from exit of Greenfield crescent on the Northwest side of the carriage way of Greenfield Park. After this junction was assessed by an Area Engineer, it was deemed that visibility in both directions exiting Greenfield Crescent is good. For vehicles exiting Greenfield crescent in the direction of the N11 there is adequate breaks in the P&D and permit parking to pull over to allow for oncoming vehicles to pass. This acts as a traffic calming measure, reducing carriage way width whilst increasing driver awareness. No further action is deemed necessary at this time.	Member of the Public	26/04/2019	0
52	7008730		Continuous White Line	LAVARNA GROVE (SE)	Dublin 6W	White line markings for entrances to Lavarna Grove.	Recommended	Following investigation, SR it is recommended on Lavarna Grove. On Lavarna Grove, Dublin 6w, for west side and east side of the carriageway, from the junction of Terenure Road West, rescind double yellow line 15 metres in southwards direction and install Stop Sign RUS 026 with associated Stop Line RRM 017 on Lavarna Grove at the junction with Terenure Road West. Install Stop Sign RUS 026 with associated Stop Line RRM 017 on Lavarna Grove at the junction with Fortfield Road.	Councillor	29/04/2019	0
53	7008806		Traffic Calming	YORK STREET (SE)	Dublin 2	Measures to reduce traffic speed and raise awareness of frequent pedestrian traffic.	Not Recommended	SR not recommended: York Street: Traffic calming The carriage way width has been significantly reduced on this road in recent years by widening the pedestrian pathways (build out). By reducing the carriage way width it raises driver awareness. This is a form of traffic calming in itself. After an assessment by an Area Engineer on the 28th May 2019 it was noted that traffic volumes were low to moderate. It is not recommended to install any additional measures at this location. Any isolated incidents of driving without due care should be reported to the Gardaí. The onus is on the motorist to drive with due care and at a speed appropriate for the prevailing conditions.	Member of the Public	02/05/2019	0
54	7008811		No U Turn	MOUNT SANDFORD (SE)	Dublin 6	Measures to prevent motorists travelling to Eglinton Road from using this entrance as a U-Turn.	Not Recommended	It is not recommended to install a "No U Turn" Sign on Milltown Road at the junction with Mount Sandford. From inspection this turning motion would be difficult and no traffic was observed making this manoeuvre during a site visit. The entrance into Mount Sandford is private property and not in Dublin City Councils charge.	Councillor	02/05/2019	0



South East Area - TAG Meeting Minutes for Noting

(Area Committee Date: 08/07/2019)

Item	Enquiry	SP Ref	Topic	Road	Post	Request Description	Tag Result	Tag Comments	Request By	Received	Sec
55	7008841		Zebra Crossing	SAINT STEPHEN'S GREEN WEST (SE)	Dublin 2	Zebra crossing for this location.	Not Recommended	SR not recommended: SAINT STEPHEN'S GREEN WEST (SE): Zebra Crossing The flow of traffic turning the corner on Stephens Green West at the Royal College of Surgeons in Ireland was monitored by the Area Engineer. It was noted to be of a low traffic volume. The pedestrian crossing before the bend only allows 4 to 5 vehicles through at a time. This allows for adequate time for pedestrians to cross this part of the carriage way safely. A Zebra crossing at this point on the carriage way would not be feasible as geometrically it would not allow for a reasonable amount of visibility for oncoming traffic coming from the Grafton Street area.	Member of the Public	03/05/2019	0
56	7008888		Disab Park Bay Residential	IRISHTOWN ROAD (SE)	Dublin 4	58 Irishtown Road, Irishtown, Dublin 4.	Recommended	Disabled Parking Bay: 58 Irishtown Road: SR Recommended Install a disabled bay on the Northeast side of the carriage way, Perpendicular (nose to kerb), commencing at the gable end boundary point of number 60 Irishtown road in a north-westerly direction for a distance of 2.4 metres wide with bay length of 6 Metres accompanied by the upright Disabled Persons' parking information sign. .	Member of the Public	08/05/2019	0
57	7008986		Double Yellow Lines	GOLDEN LANE (SE)	Dublin 8	parallel to the Dublin Bike stands	Recommended	Service Request recommended: Double Yellow lines: Golden Lane From a point commencing 5.4 metres west of lamp standard Number 8, on the south side of the carriageway, install double yellow lines for a distance of 18.3 metres in a westward direction along the roadside. (Parallel to Dublin bike stands).	Internal	13/05/2019	0
58	7009121		Double Yellow Lines	KENILWORTH LANE (SE)	Dublin 6	DYLs to prevent parking & blocking of entrance to no. 18.	Recommended	SR Recommended: KENILWORTH LANE (SE): Rescind Pay & Display and Permit parking. At a point commencing immediately east of vehicular entrance to Number 18 Kenilworth Lane, on the Southside of the carriageway rescind 1 metre of Pay & Display and permit parking in an Eastward direction. At a point commencing immediately east of vehicular entrance to Number 18 Kenilworth Lane, on the Southside of the carriageway install 1 metre of Double Yellow Line in an Eastward direction.	Member of the Public	16/05/2019	0
59	7009122		Disab Park Bay Residential	LENNOX STREET (SE)	Dublin 8	Disabled parking bay for this location.	Recommended	SR recommended: Lennox Street: Disabled bay Rescind P&D and permit parking commencing at a point at the boundary line between number 15 and 17 Lennox Street, on the south side of the carriage way for a distance of 6 metres in a westerly direction. Install Disabled bay commencing at a point at the boundary line between number 15 and 17 Lennox Street, on the south side of the carriage way for a distance of 6 metres in a westerly direction and accompanied by the upright Disabled Persons' parking information sign.	Member of the Public	16/05/2019	0



South East Area - TAG Meeting Minutes for Noting

(Area Committee Date: 08/07/2019)

Item	Enquiry	SP Ref	Topic	Road	Post	Request Description	Tag Result	Tag Comments	Request By	Received	Sec
60	7009158		Pedestrian Crossing	PEMBROKE ROAD (SE)	Dublin 4	Pedestrian crossing from The Bridge 1859 pub across to the Ulster Bank.	Not Recommended	A pedestrian crossing is located approximately 40m from Bridge 1859 pub. This is considered to be an adequate walking distance. An additional pedestrian crossing in such proximity to the existing one would not be recommended at this moment.	Member of the Public	17/05/2019	0
61	7009250		P&D/Permit Parking (Rescind)	DERRYNANE GARDENS (SE)	Dublin 4	Rescind parking space, due to completion of dishing at this location.	Recommended	SR recommended: Derrynane Gardens: Rescind Pay and Display and permit Parking. Commencing at a point 3.5 metres north of the boundary line of number 12 and 13 Derrynane Gardens, on the west side of the carriageway, Rescind 8 metres of pay & display and permit parking in a southward direction. Commencing at a point 3.5 metres north of the boundary line of number 12 and 13 Derrynane Gardens, on the west side of the carriageway, install 3.4 metres of Double Yellow Lines in a southward direction.	Member of the Public	21/05/2019	0
62	7009259		Traffic Calming	SANDYMOUNT CASTLE ROAD (SE)	Dublin 4	Appropriate signage & road markings to prevent speeding on this road & cul-de-sac.	Not Recommended	Service request not recommended: Sandymount Castle Rd: Traffic calming measures. Staggered P&D and permit parking acts as a traffic calming measure. It reduces carriage way width and raises driver awareness. Therefore it is not recommended to remove existing staggered parking. It is currently Dublin City Councils Policy not to have Stop/Yield signage at all junctions on internal roads within residential areas as this would lead to a proliferation of the same. It is not recommended to install any additional measures at this location. Any isolated incidents of driving without due care should be reported to the Gardaí. The onus is on the motorist to drive with due care and at a speed appropriate for the prevailing conditions.	No Code Allocated	21/05/2019	0
63	7009389		Yellow Box	ADRIAN AVENUE (SE)	Dublin 6W	To allow residents enter exit from Adrian Avenue off clareville road	Not Recommended	The traffic flow from the Adrian Avenue is not significant and the road does not meet the minimum criteria of serving fifty houses/spaces. A yellow box is therefore not recommended. The warrant is not met for a yellow box. Yellow boxes are intended to prevent blocking of junctions. Side road traffic flows should be significant and the side road should serve a minimum of fifty houses or a major traffic generating facility. This guideline is in place to avoid a proliferation of yellow boxes in the city.	Councillor	28/05/2019	0
64	7009393		Disab Park Bay General	D'OLIER STREET (SE)	Dublin 2	Additional parking bays for this area.	Not Recommended	After a site visit by an Area Engineer, it was noted that there is currently one disabled parking bay located at Burgh Quay and two Located on the West side of D'Olier Street. Adequate disabled parking bays are provided in these area's and therefore no further action is deemed necessary at this time.	Member of the Public	28/05/2019	0



South East Area - TAG Meeting Minutes for Noting

(Area Committee Date: 08/07/2019)

Item	Enquiry	SP Ref	Topic	Road	Post	Request Description	Tag Result	Tag Comments	Request By	Received	Sec
65	7009394		Disab Park Bay General	BURGH QUAY (SE)	Dublin 2	Additional parking bays for this area.	Not Recommended	After a site visit by an Area Engineer, it was noted that there is currently one disabled parking bay located at Burgh Quay and two Located on the West side of D'Olier Street. Adequate disabled parking bays are provided in these area's and therefore no further action is deemed necessary at this time.	Member of the Public	28/05/2019	0
66	7009409		Yellow Box	HAROLD'S CROSS ROAD (SE)	Dublin 6W	Yellow box for bus lane at this location.	Not Recommended	A speed survey was carried out on the 29th May 2019. The resultant 85% percentile speed did not exceed the speed limit and the road does not have a straight run of a minimum 200m. It is therefore not recommended to introduce additional traffic calming measures, as they do not meet the warrant.	Member of the Public	28/05/2019	2
67	7009457		Yellow Box	CRUMLIN ROAD (SE)	Dublin 12	On the Crumlin Road entrance to Dolphin Park.	Not Recommended	SR not recommended. It is not recommended to install a yellow box at this location. Yellow boxes are intended to prevent blocking of junctions. From a site inspection it was noted that there was very few delays for traffic exiting from the Dolphin Park Gaa ground.	Member of the Public	30/05/2019	0
68	7009585		Double Yellow Lines	RALEIGH SQUARE (SE)	Dublin 12	DYLS to assist buses in exiting & entering the Club. directly outside no 9.	Recommended	Double Yellow Lines recommended as follows: On the east side of the carriageway, commencing from a point 1.5 metres south of the south vehicular entrance pillar to number 9 Raleigh Square, continuing in a southward direction to the boundary line of number 9 and 10 Raleigh Square.	Member of the Public	07/06/2019	0
69	7009853		Double Yellow Lines	RAGLAN ROAD (SE)	Dublin 4	looking for parking restrictions	Recommended	Double Yellow Lines recommended as follows: Commencing at a point 5.1 metres south of Lamp standard 3, on the East side of the carriage way, install 2.7 metres of DYL in a Southwards direction. These double yellow are to be placed between the vehicular entrances of No. 12 Raglan Rd and Beiginis Raglan Rd.	Member of the Public	21/06/2019	0
70	11077704	2441354	Double Yellow Lines	ORWELL ROAD (SE)	Dublin 6	double yellow lines be placed at junctions in the area, to include the roadway adjacent to the Marianella development.	Not Recommended	It is not recommended to install double yellow line, at junction Orwell Road with Marianella Development where restrictions are already covered under the law. (Under the current Road Traffic Regulations Traffic & Parking), as it is illegal to park within 5 m of the junction.	Member of the Public	03/04/2019	0



South East Area - TAG Meeting Minutes for Noting

(Area Committee Date: 08/07/2019)

Item	Enquiry	SP Ref	Topic	Road	Post	Request Description	Tag Result	Tag Comments	Request By	Received	Sec
71	90046173	SP_31521	Double Yellow Lines (Extend)	SIBTHORPE LANE (SE)	Dublin 6	on the lane	Pending	<p>A site inspection was made on 14/08/18 by the Line marking inspector, it was established that the width of the carriageway on the west arm of Sibthorpe Lane is 4m.</p> <p>The current Dublin City Council requirements for single sided parking is 4.6m, and this is not achievable on this section of the laneway, therefore double yellow lines could be recommended to prevent obstructions to traffic.</p> <p>As this is a health and safety measure, it will cause difficulties for the residents parking in the area, then it would be necessary that Mr. Maurice Aherne provides signatures of support of his request from his neighbours with the names and proof of addresses from the following houses numbers: 23 to 28 on Leeson St Upper, the Wesley House Residence Sibthorpe Lane and the Ranelagh Osteopathic Clinic.</p> <p>If written support is provided then it will then be considered by Dublin City Council for implementation.</p> <p>STAT as follows:</p> <ul style="list-style-type: none"> •From the Lamp stand number 1 extending westward 5m, from this point on the east side of the carriageway install 15m of Double yellow lines extending Northwards. (DYL won't be place at the corner as under current Road Traffic Regulations it is illegal to park within 5 metres of a junction. Issues relating to illegal parking should be referred to Dublin Street Parking Services tel no. 01 6022500 or the Gardaí as they occur). 	Member of the Public	24/05/2016	1
72	90046900	SP_35750	Traffic Calming	LEESON STREET UPPER (SE)	Dublin 4	from the corner of Upper Leeson Street and onto Sussex Road	Not Recommended	<p>Sussex Road is a part of a major strategic arterial route linking city centre and N11 road (a national primary road in Ireland). It also is a bus route and an emergency services route with high traffic volumes. Sussex Road currently contains on street parking which acts as traffic calming by way of increasing driver caution, the tree lined appearance of the road also creates an enclosed nature to area which further enhances traffic calming.</p> <p>Ramps and/or rumble strips do have unwelcome side effects such as additional noise, vehicle damage and possible personal injury. The Ambulance Service, generally, is not in favour of ramps and has concerns about the effect of ramps on people with spinal injuries travelling over ramps.</p> <p>The Fire Services are also concerned that ramps delay the response time of their fire tenders.</p> <p>DCC has a policy not to install ramps on bus routes for similar reasons.</p> <p>Speeding violations are a matter for the Gardaí.</p> <p>For these reasons, the provision of extra traffic calming measures is not recommended at this time on Sussex Road.</p>	Councillor	06/01/2017	0



South East Area - TAG Meeting Minutes for Noting

(Area Committee Date: 08/07/2019)

Item	Enquiry	SP Ref	Topic	Road	Post	Request Description	Tag Result	Tag Comments	Request By	Received	Sec
73	90047831	SP_36687	Traffic Calming	LANSDOWNNE PARK (SE)	Dublin 4	on the road.	Not Recommended	<p>With regards to Lansdowne Park, it was noted also that there is a No Right Turn sign on Northumberland Road at its junction with Lansdowne Park during the hours of 7 a.m. to 10 a.m. Monday to Friday and a No Right Turn sign on Shelbourne Road at its junction with Lansdowne Park during the hours 4 p.m. to 7 p.m. Monday to Friday. The no right turns are to prevent traffic from using Lansdowne Park as a rat run during peak hours.</p> <p>Lansdown Park currently contains on street parking (staggered on both sides) which acts as traffic calming by way of increasing driver caution.</p> <p>The sign Children Crossing W142 and 30 km/h Slow Zone sign, Sign F 403 are also installed on Lansdown Park (from Shelbourne Road to Northumberland Road and vice versa) plus a two ramps (from Northumberland Road to Shelbourne Road) as well consider like a traffic calming.</p> <p>For these reasons, the provision of extra traffic calming measures on Lansdowne Park is not recommended at this time. If motorists are using this route as a rat run during peak hours, the issue should be referred to the Gardai for enforcement.</p> <p>You may or may not be aware that the junction of Pembroke Road with Lansdowne Road is proposed for change in the Bus Connects project, which will allow the Pembroke Road vehicles to access Lansdowne Road. We believe that if this modification is to go ahead it would alleviate many or all of your concerns. Please visit the Bus Connect link for all details: https://www.busconnects.ie/media/1475/busconnects-cbc14-ucd-tc, and junction detail attached.</p>	Member of the Public	24/02/2017	0
74	90049606	SP_38482	Double Yellow Lines	MOUNT STREET UPPER (SE)	Dublin 2	behind no.17	Not Recommended	<p>Not recommended: Dublin City Council's policy is to not introduce parking restrictions where restrictions are already covered under the law, such as placing Double Yellow Lines (RRM008) across an entrance to a premise, as this would lead to a proliferation of same and additional expense due to maintenance, etc.</p> <p>Under Section 36 paragraph (2) (g) of the Road Traffic (Traffic & Parking) Regulations; "A vehicle shall not be parked in any place, position or manner that will result in the vehicle obstructing an entrance or an exit for vehicles to or from a premises, save with the consent of the occupier of such premises"</p> <p>In addition, under Section 36 paragraph (2) (k) of the Road Traffic (Traffic & Parking) Regulations; "A vehicle shall not be parked in a manner in which it will interfere with the normal flow of traffic or which obstructs or endangers other traffic."</p> <p>Infringements of the act should be reported to Dublin Street Parking Services tel. no. 01 6022500 or the Gardai as they occur.</p>	Councillor	02/06/2017	0

Road Maintenance South East Area Works Programme 2019

The South East Road Maintenance Works Programme 2019 is being carried out in the main under four contracts as follows:

C16-18: South Side Asphalt Contract:

Contractor has been appointed and is Roadstone. Works are underway and have been concentrated in the South Central Area over the last few months. The works in the South East Area will commence in the coming weeks.

Locations: Belmont Avenue, Donnybrook Road, Ranelagh Road, South Great George's Street and Stillorgan Road.

C9-19: South East and South Central Asphalt Contract 2019:

Contractor has been appointed and is SIAC Bituminous Products Ltd. Works are likely to commence in July 2019.

Locations: Shelbourne Road, Charleston Road, Camden Street Lower, Aungier Street, Stephen Street Lower, Purser Gardens, Bushy Park Road, Zion Road, Molesworth Street and South Anne Street, Ashfield Park, Homelee and Ailesbury Gardens.

C3-19: South City Name Plate Contract:

Contractor has been appointed and is Richard Nolan Civil Engineering. Works have commenced on site.

C14-19: South City Footway Reconstruction Contract (South East):

Tender documents are being prepared and will likely be sent to contractors on Framework in the next three weeks. Works likely to commence in July 2019 upon successful appointment of contractor.

Locations: Fortfield Road, Kimmage Road West, Pearse Square, Rutland Grove, Mercer Street Upper and Lower, Haddington Road and Mount Street Lower.

Note: Ashfield Park, Homelee and Ailesbury Gardens in contract C9-19 above are to be funded from the SEA Discretionary Fund.

To: **The Chairman and members of the
South East Area Committee**

24th June 2019

Meeting: 8th July 2019

With reference to the proposed grant of a temporary convenience letting of a site at Beggars Bush, Shelbourne Road, Dublin 4.

By way of temporary convenience letting a site at Beggars Bush, Shelbourne Road, Dublin 4, shown outlined red and coloured pink on Map Index No. 12861 was demised by Dublin City Council to Eircom Limited for use as a car park for a term of 5 years from 29th September 2003 and subject to an annual rent of €25,000. The letting expired on 28th September 2008. Eircom Limited continued to pay rent up to 28th September 2012 and were over-holding on this site until a new letting agreement was commenced 29th September 2012 for a period of 5 years at an annual rent of €18,000.

Dublin City Council's Housing Department have indicated that this site is not considered suitable for any housing development and have no objection to a new letting agreement with Eir

Negotiations commenced between Dublin City Council and Eir (previously Eircom Limited) to enter into a new temporary convenience letting and it is now proposed to a grant a further temporary letting for use as a car park to Eir subject to the following terms and conditions:

1. That the letting shall be made under Section 211(5) of the Planning and Development Act, 2000.
2. That the subject property is as shown outlined in red and coloured pink on Map Index No. SM-2017-0411 (previously known as Map Index No. 12861).
3. That the term of the letting shall be for a five year period commencing on 29th September 2017.
4. That the rent shall be payable at the rate of €23,000 (twenty three thousand euro) per annum.
5. That no building shall be erected or constructed on the site.
6. That the letting shall include such conditions and covenants which the Council's Law Agent deems appropriate for a letting of this nature.
7. That each party shall be responsible for their own fees in this matter.

The dates of the performance of any of the requirements of the proposed disposal may be amended at the absolute discretion of the Executive Manager.

The proposed disposal shall be subject to such conditions as to title to be furnished, as the Law Agent in his discretion shall stipulate.

No agreement enforceable at law is created or intended to be created until an exchange of contracts has taken place.

Helen McNamara
Senior Executive Officer



SHELBOURNE ROAD - BEGGARS BUSH

Site At
Dublin City Council to EIR
Grant of 5 Year Lease

Area = 341sqm (0.084 Ac.)



Comhairle Cathrach
Bhaile Átha Cliath
Dublin City Council

An Roinn Comhshaoil agus Iompair
Rannán Suirbhéireachta agus Léarscáilithe
Environment and Transportation Department
Survey and Mapping Division

O.S REF
3264-18

SCALE
1:1000

INDEX No	FOLDER No	CODE	DWG No	REV
FILE NO	SM-2017-0411-_0204- C5 - 001 - A.dgn			

DATE
14-07-2017

SURVEYED / PRODUCED BY
L. Butler

THIS MAP IS CERTIFIED TO BE COMPUTER GENERATED BY
DUBLIN CITY COUNCIL FROM ORDNANCE SURVEY DIGITAL MAPBASE
SURVEY, MAPPING AND RELATED RESEARCH APPROVED

JOHN W. FLANAGAN
PhD CEng Eur Ing FIEI FICE
ACTING CITY ENGINEER

APPROVED _____
THOMAS CURRAN
ACTING MANAGER LAND SURVEYING & MAPPING
DUBLIN CITY COUNCIL

INDEX No.
SM-2017-0411
(12861)

**Culture, Recreation & Economic Services Department
Parks & Landscape Services Division**

**To the Chairperson and Councillors of the
South East Area Committee**

RE: Update on the installation of the 'Yi' Friendship Garden in Herbert Park

As set out in my reports to the South East Area Committee in July of 2016 and also in April of this year in respect of the Chinese Garden which will include a pagoda style shelter, planting, seating, rockery, pond and a small waterfall.

The original location of the Yi Garden was to be at the paved area close to the pond at the Ballsbridge end of the Herbert Park. However, having considered future proposals for the pond area with Howley Hayes Conservation Architects, who undertook the Conservation Management Plan for Herbert Park, it was decided that a location on the western side of the park close to park amenities and facilities such as the tearoom and toilets would be more appropriate.

Having investigated a number of locations in this area of the park a site to the rear of the bowling green, on a disused hard surface area, was chosen (see attached). This is in close proximity to utilities (electricity, water) resulting in minimum disturbance to the park during construction. The location also ensures that the Yi Garden is easily visible from the road and accessible for those wishing to visit the garden.

**Michael Noonan
Senior Executive Park Superintendent**

LOCATION OF YI GARDEN



ELEVATION



**To the Chairperson and Members of the
South East Area Committee**

Housing Projects and Local Area Improvements

Crumlin Area Office

As a result of the recent change in local electoral areas, the Crumlin Area Office is now part of the South East Area and accordingly Chris Butler, Area Housing Manager will be attending the South East Area Committee meetings.

Grand Canal Sub Group

The latest meeting of the Grand Canal Sub-committee was held on 23rd April 2019. The Canal Ambassador Scheme pilot is running well. There was a large turnout for the canal element of the Dublin Community Clean-up Day on 27th April 2019 in conjunction with the four Dublin Local Authorities and Waste Management Section DCC. The IWAI Dublin Branch Boat Rally took place in May on both canals. Waterways Ireland are to propose a new format for canal sub group meetings in the coming months. The next meeting of the Grand Canal Sub-committee will be held on 4th September 2019.

Rathgar Village Improvement Plan (VIP)

The redesign of Herzog Park is the final element of the Rathgar VIP to be undertaken. The Nature Play Area was officially opened by the Lord Mayor on 13th September 2018. Works to construct the Multi Use Games Area (MUGA) on the site of the bowling green are now complete and park landscaping is underway. The MUGA will be open in September 2019. This constitutes phase 2 of the works. Works to re-align the bring centre are almost complete and it will reopen as soon as leaf collection area is completed in mid-July. Internal planting, boundary treatment and the car park area will be addressed in the final phase 3 later in 2019.

Ranelagh Gardens Park

The installation of new park benches and ancillary works has commenced in Ranelagh Gardens Park and it is anticipated that the works will take two weeks to complete.

Ringsend Irishtown Local Environment Improvement Plan (LEIP)

The Ringsend Irishtown Local Environment Improvement Plan (LEIP) was adopted at the June 2017 South East Area Committee meeting. It is now proposed to prepare planning applications under Part 8 of the Planning and Development Regulations, 2001, for the redesign of (1) Library Square and (2) Cambridge Road.

Library Square: (Mitchell & Associates) Meetings with internal stakeholders were held during September and October 2018. A meeting was held with local businesses to discuss parking / loading arrangements on 5th December 2018. A presentation was made to area councillors on 13th February 2019 and a preliminary draft design was brought to a public meeting for all stakeholders on Thursday 21st March 2019 at 7pm in the Ringsend Irishtown Community Centre (RICC). Following a period of consultation up to 19th April 2019, submissions have been received and are being reviewed by the project team. A revised design will be drawn up following further consultation with internal departments prior to holding a second public meeting and commencing Part 8 process.

Cambridge Road: (Redscape Architects) An initial public workshop in relation to Cambridge Road was held on Thursday 30th August 2018 in the RICC on Thorncastle Street. Meetings with internal stakeholders took place in September and October and designs were drafted based on consultations which were brought to a second public workshop/meeting on 28th November 2018. Further information is required in relation to road design and drainage requirements for the proposal and it is hoped to proceed with the Part 8 process once these issues have been addressed.

Terenure Village

Proposal to screen recycling bins in car park on Terenure Road North was examined in partnership with Terenure 2030 / Tidy Towns and Waste Management Services and will be carried out in 2019. Dublin Canvas has been asked to create a design. They will commence work on the project in June 2019.

New Playground at Sean Moore Park

The playground in Sean Moore Park is almost complete and Parks are currently allowing for the establishment of the grass matting on the mounds. However before the playground can be opened it will be necessary that the ball stop netting, as recommended in the Planner's Part 8 Planning Report, be installed and Parks are currently in discussion with the National Parks and Wildlife Service (NPWS) and the contractor to agree a timeline for this installation.

O'Carroll Villas

Housing Maintenance sought prices from contractors for the proposed landscaping at O'Carroll Villas and we are currently awaiting an update on this.

Mercer Street Play Area

A play area was installed in Mercer Street and we had a request that the external fencing be painted and we have asked Housing Maintenance for this work to be done.

Cabbage Patch

We held a public consultation earlier this year to see what local residents wanted for the future of the Cabbage Patch and two particular items were suggested by the residents; namely the provision of a play area in the Cabbage Patch and also improvements to the Football Pitch and the objective is to attract more people to visit the Cabbage Patch in the future. We are currently liaising with the City Archaeologist who will be arranging trial excavations to establish how much of the Cabbage Patch has been previously archaeologically resolved. The results of these excavations will then dictate progress on the play area and the pitch.

There are also a number of events taking place in the Cabbage Patch this summer. The Pride Dog Show took place on Sunday 23rd June and there will be an event for the Hospice on the 13th July. Housing Maintenance have tidied up the public realm in the vicinity of the Cabbage Patch and Public Lighting are going to improve the lighting in Cathedral Lane.

Stannaway Court, Senior Citizens' Complex

Insulation and upgrading works are well underway in the complex. Following the completion of the required gas works insulation works are almost completed in block 1 (No.'s 1 -12) and have commenced on 2 other blocks. New Fire safety hall doors have also been installed in block 1 and are being rolled out to the other blocks.

Raleigh Square - Tuath Housing Association

Tuath Housing are constructing 33 senior citizens' units at Raleigh Square in Crumlin. Works are progressing on these units but there has been some delays experienced. The contractor is claiming weather delays, supply chain issues and unforeseen design elements and the new completion date is October 2019. Tuath have advised they will be seeking nominations, from Housing Allocations, for the 33 units (28 x 1 bed, 5 x 2 bed) in September.

Rafter's Lane – WALK VHA (Voluntary Housing Association)

WALK VHA are constructing 10 x 1 bed units and 1 x 5 bed communal unit at Rafter's Lane in Drimnagh. The one bed units will accommodate senior citizens and the communal unit will accommodate older persons who are supported by WALK. Works are well underway on site and the project is due to be completed in August 2019.

Armagh Road - FOLD VHA

Construction works are continuing on the site for 97 senior citizens' 1 bed units. These units are being purchased by and managed by FOLD VHA and the expected completion date is Q4, 2019.

Mount Argus

DCC have agreed to acquire 13 units in block H of this development. The units acquired will include 4 x 1 beds, 8 x 2 beds and 1 x 3 beds. The units are expected to be ready in Q4 of this year.

To the Chairperson and Members of the
South East Area Committee

Community Development Section Report

Please find below a list of events taking place in the South East Area in July 2019, organised or supported by the Community Development Team of the South East Area Office.

- **2 July at 2pm – Let's Walk & Talk visit to Airfield Estate.** Meet outside the Barge Pub, Charlemont Street.
- **13 July from 11 - 4pm – 'Funster' children's entertainment at Busy Park Market.**
- **13 July at 2pm – Dartmouth Square Picnic in the Park.**
- **13 July at 2.30pm – A Galway Girl** (play) at Beechill Court Community Room.
- **14 July at 2pm – Cabbage Patch Family Fun Day** (off Kevin / New Street).
- **20 July at 2pm – Canon Mooney Gardens Fun Day.**
- **20 July at 2pm – Colombia Independence Day Celebrations** at 1 Windmill Lane.

Weekly Activities:

- Every Monday from 11am - 1.30pm – **Verschoye Pottery Club** at Verschoye Court Community Room.
- Every Monday from 2 - 4.30pm – **Verschoye Art Group** at Verschoye Court Community Room.
- Every Monday from 7 - 9pm – **Verschoye Drama Group** at Verschoye Court Community Room.
- Every Tuesday at 11am – **Dance for Life** dance classes for older people at the Evergreen Centre, Terenure.
- Every Tuesday at 2pm – **Let's Walk & Talk** walking group, meeting outside the Barge Pub, Charlemont Street.
- Every Wednesday from 11.30am - 12.30pm – **Chair Yoga** at Beech Hill Court, Donnybrook.
- Every Wednesday at 2pm – **Let's Walk & Talk in Spanish** walking group, meeting at Kildare Place, Kildare Street.
- Every Wednesday at 2.30pm – **Knitting Circle** at Verschoye Court Community Room.
- Every Thursday at 10am – **Parent & Toddlers Group** at the Evergreen Centre, Terenure.
- Every Thursday at 2pm – **Let's Walk & Talk** walking group, meeting at Sandymount Green.
- Every Thursday from 3 - 5pm – **Knitting Circle** at Beech Hill Court, Donnybrook.
- Every Friday at 11am – **Let's Walk & Talk as Gaeilge** walking group, meeting at Meeting House Square, Temple Bar.
- Every Friday at 2pm – **Let's Walk & Talk in French** walking group, meeting at Kildare Place, Kildare Street.
- Every Saturday at 10am – **Parent & Toddlers Group** at the Evergreen Centre, Terenure.
- Every Saturday from 11 - 4pm – **Bushy Park Market.**

- Every Saturday at 2pm – **Let's Walk & Talk** walking group, meeting at the car park of the Dropping Well Pub, Milltown.

Many thanks to all volunteers and those involved in the above for their commitment and efforts.

To the Chairperson and Members of the
South East Area Committee

Environmental Services Unit Report

Public Realm Enhancements

44 hanging baskets erected.

25 abandoned bikes removed in June.

49 abandoned bikes removed in May.

BIDs / Dublin Town

Ongoing contact and support.

Proposal for spending additional funding allocated for locally based waste management initiatives in South East Area.

Pilot dog dirt bag dispenser installed in Dartry Park.

Ongoing patrols in South East Area parks and along Sandymount Strand.

Events

Summer in the City 21st July.

Laya Healthcare spectacular (Merrion Square) 12th - 14th July.

To the Chairperson and Members of the
South East Area Committee

DCSWP HIGHLIGHT EVENTS & PROGRAMMES JULY - AUGUST 2019

DUBLIN SPORTSFEST 2019

Following on from last year's success DCSWP's flagship annual event, Dublin Sportsfest 2019 will take place during European Week of Sport (September 22 – 29). The focus will be on encouraging participation across all ages, backgrounds and abilities and, importantly, sustainability. There will also be the added bonus of the chance to showcase DCC's many sport and recreation facilities.

The festival will comprise of a week-long programme of events across many of DCC's facilities, parks and urban spaces.

The DCSWP Project Team is in place and is currently in the planning stage. A full list of highlight events and programmes will be communicated across all social media channels, websites etc. once confirmed.

DOCKLANDS DIP 2019

The Docklands Dip is back for 2019 and will take place on Wednesday 17th July from 10am – 4pm at Spencer Dock. This event is aimed at young people aged between 12 - 18 years.

Participants will have the opportunity to take part in water safety sessions, learn how to jump and dive and try their hand at water polo and kayaking.

SMALL GRANTS 2019

Sports clubs operating within the administrative area of Dublin City Council and affiliated to a National Governing Body (NGB) were recently invited to apply for financial assistance from the Sport For Young People Small Grants Scheme (10-21 years of age). The Grant Scheme is funded and administered by Sport Ireland and the Dublin Sport and Wellbeing Partnership. The scheme supports clubs in some of the following;

- Purchase of equipment
- Administrative costs
- Training and coaching courses

Applications for the Small Grants Scheme closed on 28th June 2019.

DCSWP CORE PROGRAMMES JULY - AUGUST 2019

CHANGE FOR LIFE Underactive Adults

The Change for Life programme aims to improve the health of local communities by supporting people to become more physically active on a regular basis and adopt a healthier diet. The programme was rolled out from January to March in tandem with RTE's Operation Transformation in 15 locations across the city with over 1,000 participants including the South East Area.

Due to its success the following Change for Life programme continues in the South East Area over the next period;

- **Programme:** Fitness For All Classes
Dates/Times: Tuesdays and Thursdays 8 – 9pm
Location: Charlemont Street Community Centre
Participants: Mixed 18+ years

FOREVER FIT (CORE) Older Adults

The Forever Fit Programme is aimed at older adults and focuses on activities to improve balance, increase mobility, strength, coordination and prevent falls.

Details of Forever Fit programmes running in the South East Area during the next six week period are outlined below.

- **Programme:** Chair Fit, Mount Drummond
Dates/Times: Mondays 7pm – 8pm
Location: Mount Drummond Sheltered Housing Complex, Harold's Cross
Participants: Older Adults –55+ years
- **Programme:** Chair Yoga, Ranelagh
Dates/Times: Tuesdays 3pm – 4pm
Location: Woodstock Sheltered Housing Complex, Dublin 6
Participants: Older Adults – 55+ years
- **Programme:** Beech Hill Yoga
Dates/Times: Wednesdays 12.30pm – 1.30pm
Location: Beech Hill Court, Donnybrook
Participants: Older Adults – 55+ years
- **Programme:** Dance For Life
Dates/Times: Tuesdays 11am – 12pm
Location: The Evergreen Centre, Terenure
Participants: Mixed Older Adults 55+ years

GO FOR LIFE GAMES Older Adults

The aim of the Go for Life Games is to involve older adults in recreational sport with emphasis on participation and fun. The games can be played in singles, pairs and teams and are played in a non-competitive way (as much as possible!) with participants encouraged to umpire their own game.

The programme involves the following three sports;

- **Lobbers** - adaption of Petanque and Boules
- **Flisk** - adaption of Frisbee and Horseshoe Pitching
- **Scidil** - adaption of Ten-Pin Bowling and Skittles

Programme: Go For Life – Active Retirement

Dates/Times: Mondays 7pm – 8pm/Wednesdays 3pm-4pm

Location: Mount Drummond Court, Harold's Cross (Mondays) Beechwood Centre, Ranelagh (Wednesdays)

Participants: Mixed 55+ years

CO-FUNDED PROGRAMMES JULY - AUGUST 2019

ATHLETICS DEVELOPMENT OFFICER UPDATE

The Athletics Ireland summer camp will take place from 8-19 July (10am – 2pm) in Morton Stadium, Santry. The camp is aimed at children age 6 – 12 years.

- A Family Fun Day with various athletic activities is scheduled for Sunday 14 July in Markievicz Park, Ballyfermot. Details TBC.

BOXING DEVELOPMENT OFFICER UPDATE

The StartBox Aviva Stadium Experience provides an opportunity to primary schools, secondary schools and community groups to visit the National Soccer and Rugby Stadium and be inspired by stories of past sporting heroes. Groups visiting the stadium have full access to the stadium's facilities. This event is free of charge to all participants. Bookings for this event are ongoing. On-site visits take until 26th July from 12pm-2pm.

CRICKET DEVELOPMENT OFFICER

The Cricket Development Officer will be liaising with DCSWP Sport Officers in the area to organise the running of cricket programs for the coming months and any Summer Projects that may be on in the area;

A number of players from the Sandymount and Ringsend are involved in the U11, U13, U15, U17, and U19 DCC Cricket teams this summer. Players are mixed and aged between 9-18 years. Over the next period participants meet for training sessions and cricket tours in various locations in different venues in the Dublin City area.

Citywide cricket summer camps take place in the following locations in July and August;

- Dublin City Summer Camp - 15-19^{of} July from 10am-4pm in the Phoenix Park.
- Dublin City girls camp from 30 July – 3 August from 10.00am-16.00pm (Venue TBC).

The U11 District tournament takes place from 22 - 25 of July from 10am -5pm in Pembroke CC. Members of the Dublin City team will be from the Sandymount /Ringsend area and from cricket clubs in the area.

FOOTBALL DEVELOPMENT OFFICER

School is out for summer but children are encouraged to stay active and learn new skills through the Sports Direct FAI Summer Soccer School programme. This programme will enter its 23rd year in 2019. Every year boys and girls of all abilities sign up for five days of fun and football. While participants will learn new skills and tricks from our FAI Officers, the most important element of the camp is for children to have fun and enjoy themselves. The camps are fully inclusive, so if your child has a disability he/she is more than welcome

Details of citywide camps and camps in the South East area can be found on the FAI website; <https://summersoccerschools.ie/dublin>

The Sprog soccer programme is aimed at 4 to 8 year olds and is held in 3 locations on a weekly basis;

- Sports and Fitness Irishtown on Fridays. Time TBC.
- YMCA on Wednesdays at 9.30am.
- 3 St. Catherine's sports centre on Mondays.
- Pearse House on Saturdays at 10am.

The men's league continues over the period every Monday and Wednesdays in Sports and Fitness Irishtown from 6pm to 8pm.

The 'KICKIN FOOTBALLTHROUGH ENGLISH' initiative will be delivered in partnership with Tusla in the area for teenagers seeking asylum. Full Details TBC.

RUGBY DEVELOPMENT OFFICER

For details of rugby programmes and initiatives over the next period please contact Ken Knaggs at ken.knaggs@leinsterrugby.ie

FURTHER DETAILS

For details or queries on any of the programmes/initiatives outlined above please contact Dee O'Boyle, DCSWP at (01) 222 5433 / dee.oboyle@dublincity.ie

CONTACT DETAILS

- Shauna McIntyre, Dublin City Sport & Wellbeing Partnership Manager: shauna.mcintyre@dublincity.ie
- Aideen O'Connor, Dublin City Sport & Wellbeing Partnership Programmes & Services Development Manager: aideen.o'connor@dublincity.ie
- Colin Sharkey, Senior Staff Officer, Dublin City Sport & Wellbeing Partnership: colin.sharkey@dublincity.ie
- Michelle Malone, Sport Officer: michelle.malone@dublincity.ie
- Maz Reilly, Sport Officer: marielouise.reilly@dublincity.ie
- Jamie Dowling, Centre Manager, Sports & Fitness Markievicz & Irishtown: jamie.dowling@dublincity.ie
- Football: jonathan.tormey@fai.ie
- Rowing: mary.moloney@rowingireland.ie
- Rugby: ken.knaggs@leinsterrugby.ie
- Women's Rugby: larissa.muldoon@leinsterrugby.ie
- Boxing: Michael_carruth@ymail.com
- Cricket: fintan.mcallister@cricketleinster.ie

Report by Dee O'Boyle, DCSWP. dee.oboyle@dublincity.ie

Nomination of South East Area Councillors to committees

- i. Nomination of 2 members to the South Inner City Drugs Task Force.
- ii. Nominations of 3 members to the Covanta/Waste to Energy Community Gain Committee.
- iii. Nomination of 2 members to the Aviva Community Gain Committee.
- iv. Nomination of 1 member to the D12 Local Drugs Task Force.
- v. Nomination of 1 member to the Dublin Dockland Oversight and Consultative Forum (DOCF).

**Housing, Community & Emergency Services Department
South East Area Office**

**To the Chairperson and Members of the
South East Area Committee**

Naming and numbering proposal for new development on a site at Charlemont Street / Tom Kelly Road, Dublin 2.

A request to name and number a development on a site at Charlemont Street / Tom Kelly Road has been received. The residential element of Block 3, known as French-Mullen House has already been approved.

The proposed naming and numbering scheme is outlined in the following table:

Building Name in Irish	Building Name in English	Units in Irish	Unit(s) in English	Use
1 Cearnóg Charlemont	1 Charlemont Square	Aonad 1 agus 2	Units 1 and 2	Office accommodation. Retail units.
2 Cearnóg Charlemont	2 Charlemont Square	Aonad 3 - 5	Units 3 - 5	Office accommodation. Retail units.
Bloc 3, Cearnóg Charlemont	Block 3, Charlemont Square	Aonad 1 - 3	Units 1 – 3	Retails units.
Loc 6, Cearnóg Charlemont	Lock 6, Charlemont Square	Aonad 6 Árasán 1 - 86	Unit 6 Apartments 1 – 86	Retail unit. Residential units.
Loc 7, Cearnóg Charlemont	Lock 7, Charlemont Square	Aonad 7 Aonad 8 Aonad 2, 20 / 21 Sráid Richmond Theas Árasán 1 – 86	Unit 7 Unit 8 Unit 2, 20 / 21 Richmond Street South.	Concierge unit. Retail unit. Retail unit. Residential units.

Geata an Loic, Cearnóg Charlemont	Lock Gate, Charlemont Square	18 /19 Sráid Richmond Theas	18 /19 Richmond Street South	Retail unit.
		Árasán 1 – 15 Geata an Loic	Apartments 1 – 15 Lock Gate	Residential units.

The development is indicated on the Map Index No. SM-2019-0312 dated 17-05-2019 (copy attached).

The Heritage Officer considers the proposed names appropriate, as all names therein are a continuation of existing place or building / structure names and accordingly the scheme is recommended for approval.

Brian Hanney
Area Manager

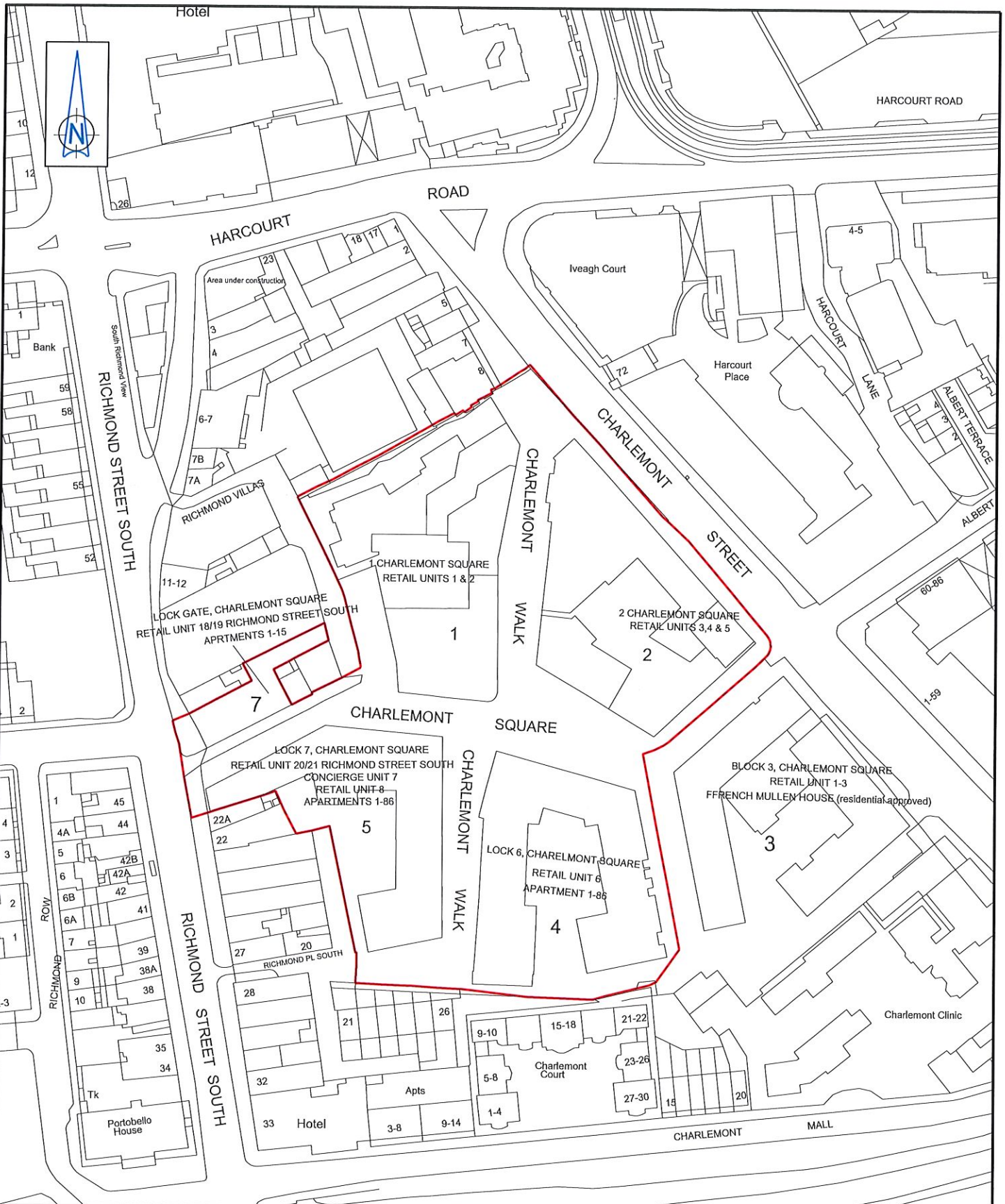

CHARLEMONT STREET

Map for Naming and Numbering

 Comhairle Cathrach Bhaile Átha Cliath Dublin City Council		An Roinn Comhshaoil agus Iompair Rannán Suirbhéireachta agus Léarscáilithe Environment and Transportation Department Survey and Mapping Division			
O.S. REF 3263-20, 25 3264-16, 21	SCALE 1:1000	INDEX No FOLDER No CODE No DWS No REV	FILE NO SM-2019-0312-0204-C5-001-A.dgn		
DATE 17-05-2019	SURVEYED/ PRODUCED BY L. Butler	<small>THIS MAP IS CERTIFIED TO BE COMPUTER GENERATED BY DUBLIN CITY COUNCIL FROM ORDNANCE SURVEY DIGITAL MAPBASE SURVEY, MAPPING AND RELATED RESEARCH APPROVED</small>			INDEX No. SM-2019-0312
Dr JOHN W. FLANAGAN CITY ENGINEER		APPROVED THOMAS CURRAN ACTING MANAGER LAND SURVEYING & MAPPING DUBLIN CITY COUNCIL			

**Housing, Community & Emergency Services Department
South East Area Office**

**To the Chairperson and Members of the
South East Area Committee**

**Naming and numbering proposal for a new development on a site at 17 Denzille Lane,
Dublin 2.**

Cúirt Denzille / Denzille Court

A request to name and number a development of apartments on a site at 17 Denzille Lane, Dublin 2 as 1 – 6 Cúirt Denzille / Denzille Court has been received. The applicant proposes to retain the existing road number, 17 Denzille Lane, Dublin D02 XR97.

The development is shown outlined on Map Index No. SM-2019-0417.

The Heritage Officer considers the proposed name appropriate and accordingly the scheme is recommended for approval.

**Mary Taylor
Executive Manager South City**

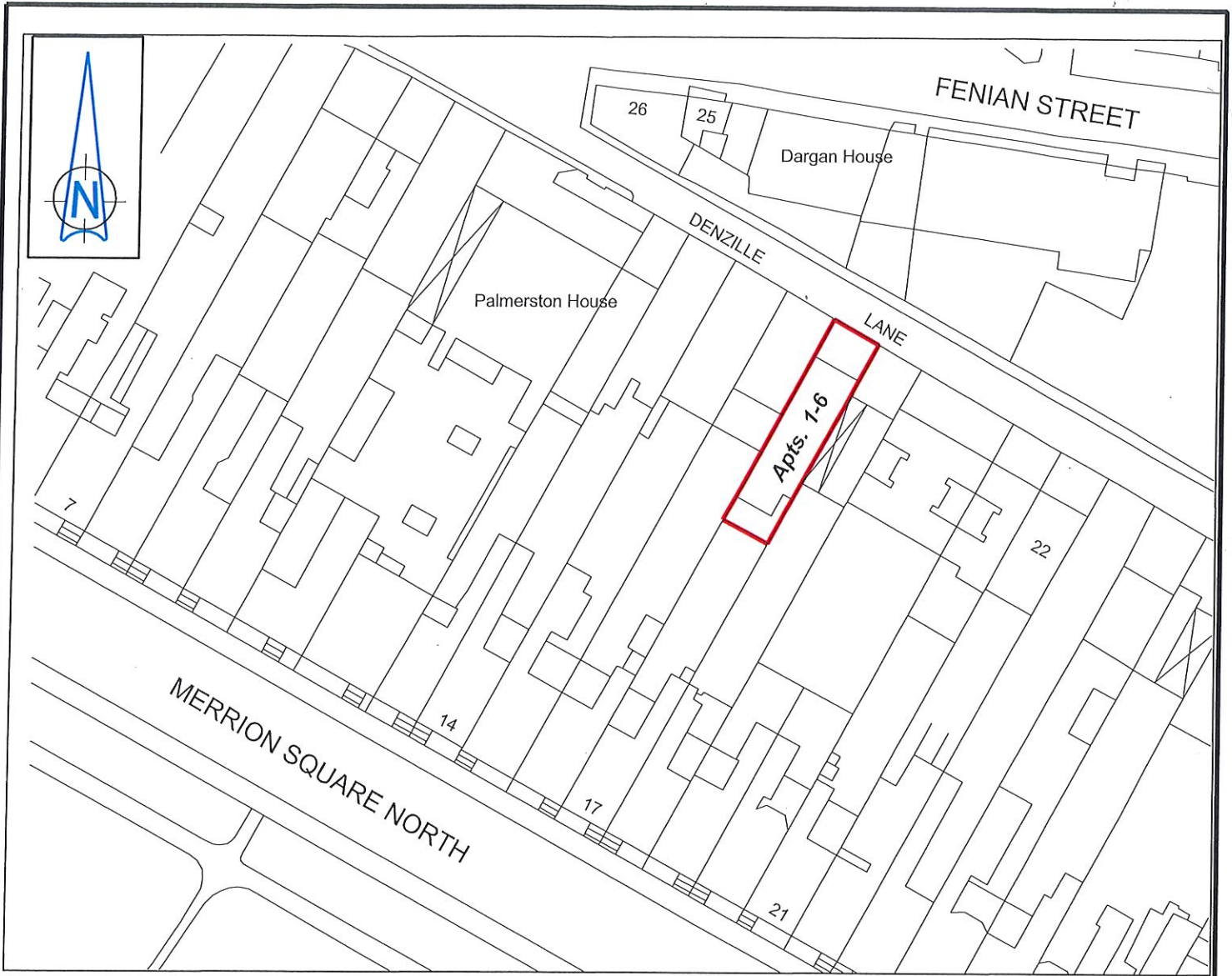

DENZILLE COURT , DENZILLE LANE, DUBLIN 2

Map for naming and numbering purposes



Comhairle Cathrach
Bhaile Átha Cliath
Dublin City Council

An Roinn Comhshaoil agus Iompair
Rannán Suirbhéireachta agus Léarscáilithe
Environment and Transportation Department
Survey and Mapping Division

O.S REF 3264-11	SCALE 1-1000
---------------------------	------------------------

DATE 24-06-2019	SURVEYED / PRODUCED BY PMcGinn
---------------------------	--

Dr JOHN W. FLANAGAN
CEng FIEI FICE
CITY ENGINEER

FILE NO	INDEX No	FOLDER No	CODE	DWG No	REV
SM-2019-0417-_0204- C23 - 001 - A.dgn					

THIS MAP IS CERTIFIED TO BE COMPUTER GENERATED BY
DUBLIN CITY COUNCIL FROM ORDNANCE SURVEY DIGITAL MAPBASE
SURVEY, MAPPING AND RELATED RESEARCH APPROVED

APPROVED _____
THOMAS CURRAN
ACTING MANAGER SURVEYING & MAPPING
DUBLIN CITY COUNCIL

INDEX No.
SM-2019-0417

To the Chairperson and Members of the
South East Area Committee

Naming and numbering proposal for new development of nine houses on a site at 11 Park Avenue, Sandymount, Dublin 4.

Péine Monteray / The Monterey

A request to name and number a development of nine houses on a site at 11 Park Avenue, Sandymount, Dublin 4 as 1 – 9 Péine Monteray / The Monterey has been received.

The applicant has chosen the name The Monterey as there is a Monterey Pine tree at the site, which will be retained.

The development is outlined on the attached Map Index No. SM-2019-0418.

The Heritage Officer considers the proposed name appropriate and accordingly the scheme is recommended for approval.

Mary Taylor
Executive Manager South City

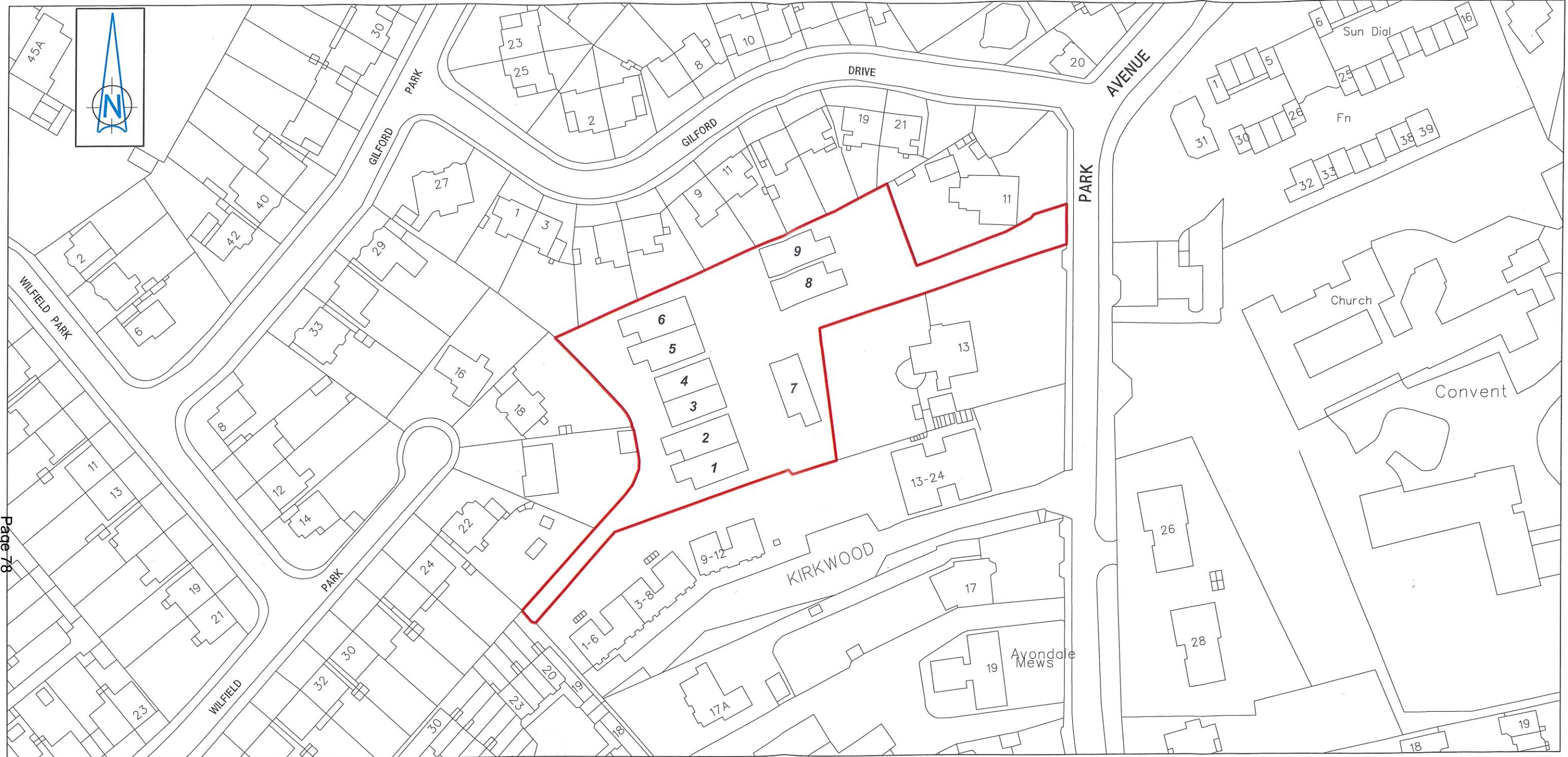

Page 78

THE MONTEREY, PARK AVENUE, SANDYMOUNT, DUBLIN 4

Map for naming and numbering purposes



Comhairle Cathrach
Bhaile Átha Cliath
Dublin City Council

An Roinn Comhshaoil agus Iompair
Rannán Suirbhéireachta agus Léarscáilithe
Environment and Transportation Department
Survey and Mapping Division

O.S REF 3264-24	SCALE 1-1000
DATE 24-06-2019	SURVEYED / PRODUCED BY PMcGinn

FILE NO	INDEX No	FOLDER No	CODE	DWG No	REV
SM-2019-0418_0204- C23 - 001 - A.dgn					

Dr JOHN W. FLANAGAN
CEng FIEI FICE
CITY ENGINEER

THIS MAP IS CERTIFIED TO BE COMPUTER GENERATED BY
DUBLIN CITY COUNCIL FROM ORDNANCE SURVEY DIGITAL MAPBASE
SURVEY, MAPPING AND RELATED RESEARCH APPROVED
APPROVED **THOMAS CURRAN**
ACTING MANAGER LAND SURVEYING & MAPPING
DUBLIN CITY COUNCIL

INDEX No.
SM-2019-0418

**Housing, Community & Emergency Services Department
South East Area Office**

**To the Chairperson and Members of the
South East Area Committee**

**Naming and numbering proposal for new development of apartments on a site at
Bellevue Avenue, Merrion Road, Dublin 4.**

Radharc na Teamhrach / Tara View

A request to name and number a development of apartments on a site at Bellevue Avenue, Merrion Road, Dublin 4 as 1 – 69 Radharc na Teamhrach / Tara View has been received.

The applicant has chosen the name Tara View as “the development is located at the start of the ancient road from Dublin Bay to the Hill of Tara, which presumably underpinned the name of the original hotel”.

The development is indicated on the Map Index No. SM-2019-0126.

The Heritage Officer considers the proposed name appropriate and accordingly the scheme is recommended for approval.

**Mary Taylor
Executive Manager South City**

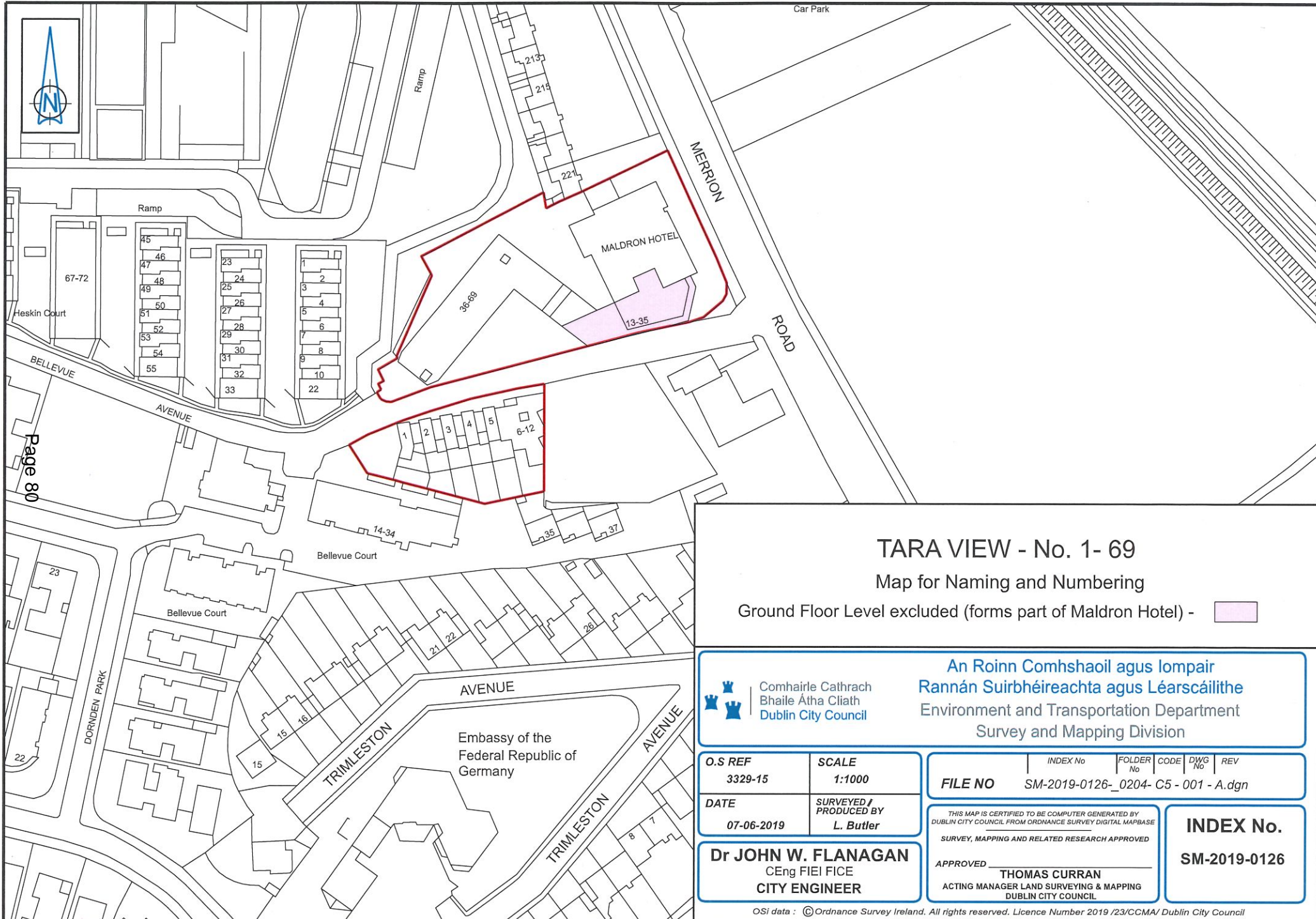

Page 80

TARA VIEW - No. 1- 69
 Map for Naming and Numbering
 Ground Floor Level excluded (forms part of Maldron Hotel) -

Comhairle Cathrach
 Bhaile Átha Cliath
 Dublin City Council

An Roinn Comhshaoil agus Iompair
Rannán Suirbhéireachta agus Léarscáilithe
 Environment and Transportation Department
 Survey and Mapping Division

O.S REF
3329-15

SCALE
1:1000

DATE
07-06-2019

SURVEYED / PRODUCED BY
L. Butler

Dr JOHN W. FLANAGAN
CEng FIEI FICE
CITY ENGINEER

INDEX No	FOLDER No	CODE	DWG No	REV
FILE NO	SM-2019-0126_0204- C5 - 001 - A.dgn			

THIS MAP IS CERTIFIED TO BE COMPUTER GENERATED BY DUBLIN CITY COUNCIL FROM ORDNANCE SURVEY DIGITAL MAPBASE SURVEY, MAPPING AND RELATED RESEARCH APPROVED

APPROVED _____
THOMAS CURRAN
 ACTING MANAGER LAND SURVEYING & MAPPING
 DUBLIN CITY COUNCIL

INDEX No.
SM-2019-0126

8th July 2019

**To The Chairperson and Members of the
South East Area Committee**

**With reference to a proposal to initiate procedures to have Adair Lane,
Dublin 2 taken in charge by Dublin City Council**

Proposal

The laneway known as Adair Lane, Dublin 2 was in Dublin City Council's charge until 10th January 2011 when Dublin City Council extinguished the public right of way over the laneway at the request of the applicant Gleeson, McGrath, Baldwin Solicitors on behalf of their client The Fleet Street Inn Dublin Limited (trading as The Temple Bar Hotel, Fleet Street, Dublin 2). (Report 411/2010 refers).

The application stated that the extinguishment of the public right of way over the laneway was required in order to gate the laneway to facilitate the development of a smoking area/beer garden to the rear of the Temple Bar Hotel.

Dublin Fire Brigade, the Environment & Transportation Department and the Planning & Development Department requested that a number of stipulations be attached to the closure and the public right of way was extinguished subject to the following conditions:

- I. *The applicant is to provide written confirmation that no building will take place on this laneway and to acknowledge that if Dublin City Council wishes to develop Adair Lane as part of the public pedestrian or vehicular network, that this extinguishment would not preclude development of plans, consultation or re-adoption of the laneway by the City Council as a public right of way.*
- II. *There must be strictly no parking anywhere along the laneway as this would restrict Fire Brigade access.*

Written confirmation regarding the conditions stipulated was received from the applicant. Planning Permission was subsequently granted for Planning Ref. No. 2186/11 in 2011. Condition 6 states that the permission was valid for a period of 2 years from the date of grant of permission.

The current position is that Adair Lane is owned by Dublin City Council but is no longer in charge. The laneway has not been gated since the extinguishment was approved and the planning permission for the smoking area/beer garden has expired.

In recent weeks vehicles have started to park in Adair Lane. Access for emergency vehicles is restricted as a result which is in direct breach of a condition specified by Dublin Fire Brigade in relation to the extinguishment.

The extinguishment was subject to a stipulation that Dublin City Council could re-adopt the laneway as a public right of way. The Environment and Transportation Department recommends the re-adoption of the laneway as a public right of way to address these issues and to regularise the current position.

Gleeson, McGrath, Baldwin Solicitors on behalf of their client, The Fleet Street Inn Dublin Limited (trading as The Temple Bar Hotel) have been notified of this decision and have informed the City Council that the Temple Bar Hotel was sold by their client a number of years ago.

The taking in charge of this road is governed by the Roads Act 1993 Section 11. Under Section 11 (b) where a road authority proposes to declare a road to be a public road it must satisfy itself that the road is of a general public utility and it must consider the financial implications of the authority of the proposed declaration. In considering these requirements the Environment and Transportation Department is satisfied that the road in question is of general utility and is satisfied that the road is up to taking in charge standard. The Environment & Transportation Department recommends that the taking in charge process be commenced. The extent of the proposal is shown on the attached Drawing No.

R.M. 25173B dated 3rd July 2019.

Service Check

A service check has been initiated.

Statutory Requirement

The statutory procedure requires that public notice of the proposal is placed in one or more newspapers circulating in the City and that the relevant documents in relation to the proposal to declare the road to be a public road go on public display for a period of 1 month. Objections or representations in relation to the proposal can then be made by members of the public within 2 weeks of the end of that period. Taking in Charge is a function reserved to the elected members of the City Council who shall consider any objections or representations made and not withdrawn

Recommendation

I recommend that procedures be initiated under Section 11 of the Roads Act 1993 to have Adair Lane, Dublin 2 taken in charge by Dublin City Council as indicated on Drawing No. R.M. 25173B.

Taking in Charge is a function reserved to the City Council.

Mary Taylor

Executive Manager South City

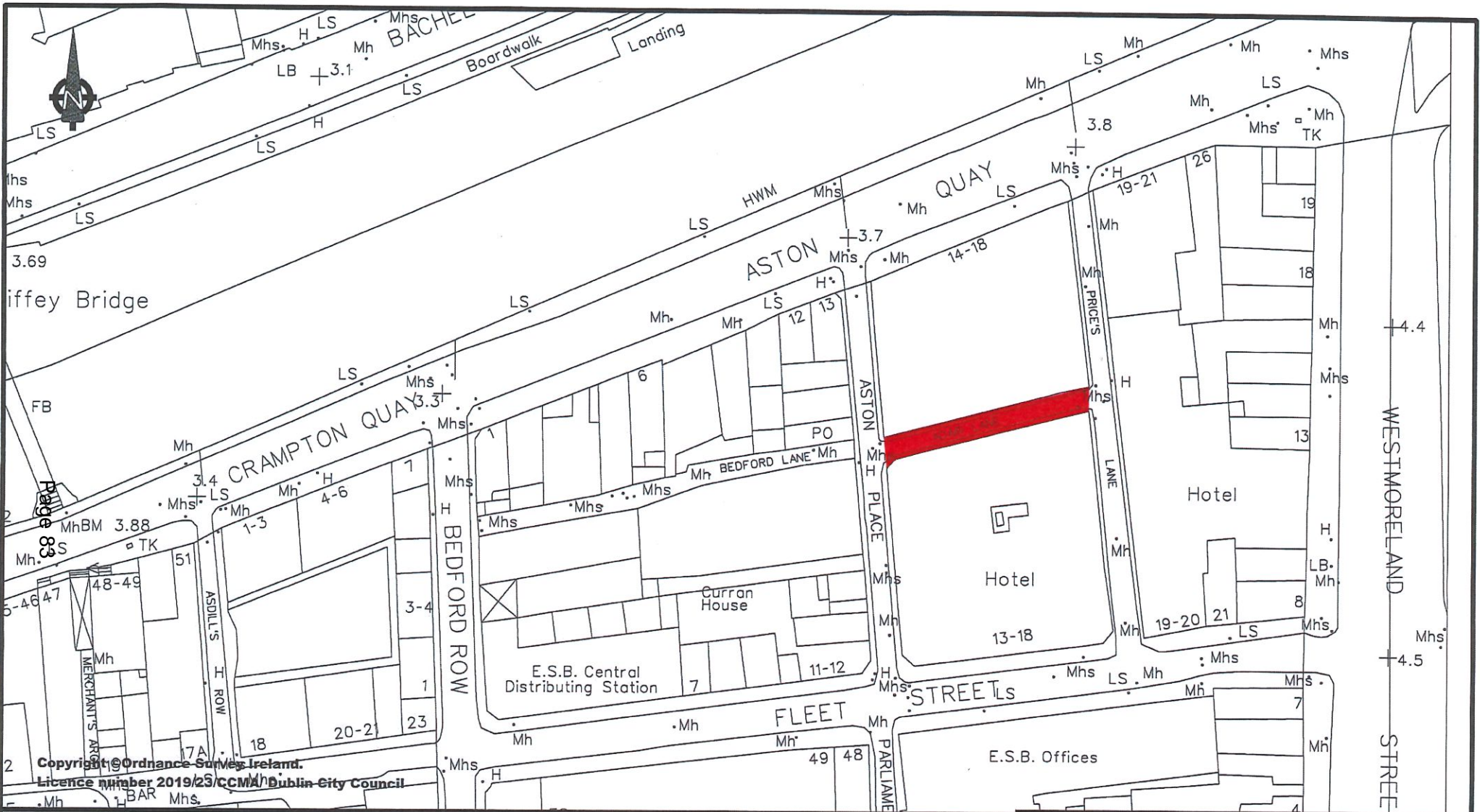

Comhairle Cathrach
Bhaile Átha Cliath
Dublin City Council
 ENVIRONMENT & TRANSPORTATION DEPARTMENT,
 CIVIC OFFICES,
 WOOD QUAY, DUBLIN 8.
 Dr John W. Flanagan CEng FIEI FICE
 City Engineer

REVISION	DESCRIPTION	DATE	REFERENCE DRAWINGS
		//20	
		//20	
		//20	
			DATUM
			C.A.D. BY
			CHECKED BY
			APPROVED BY

Adair Lane, Temple Bar.
 Proposed 'taking in charge' Adair Lane.

ROADS MAINTENANCE DIVISION

SCALE 1:1000
 DATE 03/07/2019

DRAWING No.
R.M. 25173B

Copyright Ordnance Survey Ireland.
 Licence number 2019/23/CCMA/Dublin City Council

**DUBLIN CITY COUNCIL
SOUTH EAST AREA COMMITTEE
8th JULY 2019**

Motion 1 from Councillor Dermot Lacey

This committee requests an urgent examination of the pedestrian crossing arrangements for children and parents / guardians accessing the very welcome new children's playground at Sean Moore Park.

Motion 2 from Councillor Chris Andrews

That the seat on the Grand Canal close to junction at Warren Street and Portobello Road be removed as it is causing residents ongoing disruption and concern as the level of anti-social behaviour is escalating and it is attracting extreme behaviour that no one should have to put up with. The users of this chair are also creating increased levels of dirt and rubbish which is negatively impacting on the Grand Canal and negating all the great work community groups do to keep the place clean and that manager clarify which agency is responsible for the installation and maintenance of the seat.

Motion 3 from Councillor Chris Andrews

That given the traffic issues in Eblana Villas / Island Villas will the manager make this a priority for a review of current traffic flows in order to address the current health and safety issues in this residential cell which is being used as a rat run currently.

Motion 4 from Councillor Chris Andrews

Given the serious environmental impact of the ESB oil leaks into the Grand Canal, recently highlighted by the RTE Investigates programme, that DCC and the Manager will give full and comprehensive replies to the following questions and request the ESB to make an oral report to this area committee in the September meeting:

- Has DCC met with officials from ESB - and what was discussed?
- Has DCC requested a report from ESB, documenting incidences of leaks, locations, assessments of risk, remediation carried out?
- Has DCC asked ESB to report any future leaks?
- Is a protocol for reporting leaks and procedures for remediation under discussion between the city council and ESB?
- Is the protocol based on the current system currently in operation between the energy companies and regulator in England? Please see link at the end of this email, outlining the protocol.
- Is DCC concerned about what it **now** knows about the scale of the leaks and the level of non-reporting by ESB?
- Has DCC received documentation from ESB about incidents of leaks and other details re same?
- What is the status of the leak at Camden Row?
- How many ESB underground cables are currently leaking in DCC areas, how much oil is leaking and at what locations, as reported to the City Council by ESB?
- Is DCC concerned about the disclosures by RTÉ Investigates on June 5 last about the leaking of 1 million litres of oil from ESB cables over the past 20 years and the failure of the ESB to report this to any of the relevant authorities?
- In the RTÉ Investigates programme broadcast on June 5, the ESB claimed that 1 million litres of fluid leaked from its underground cables was bio-degradable and not hazardous. Does DCC share any concerns about this response from the ESB in light of the fact that 90 per cent of the fluid being leaked contained quantities of a mineral oil, which at best is not readily bio-degradable - including an oil called C4? In particular, is DCC aware that the material safety sheet for this oil specifically states, "Do not allow

product to contaminate land"? Furthermore, the safety sheet for this product also states, "Spillages or uncontrolled discharges into watercourses must be reported immediately to the Environmental Agency or other appropriate regulatory body". In addition, is DCC aware that the Energy Networks Association - the body which represents energy companies, including ESB - states that the oils used to insulate underground electricity cables up until the 1980s included mineral oils called C14 and C14A which that body states had low bio-degradability or were not bio-degradable at all?

Motion 5 from Councillor Chris Andrews

That this area committee agrees and requests that DCC sow wildflowers as proposed by Donnybrook Tidy Towns on the median strip from Donnybrook Church up to RTE entrance as it would help pollinators and also reduce maintenance costs.

Motion 6 from Councillor Mannix Flynn

That this committee of the SEA call on Dublin City Council management, Planning Department and Street Furniture Section to refuse planning permission for street furniture etc. outside Davits pub Camden Street / Pleasant street. Also, that the planning permission to widen the footpath onto the road carriage way be refused.

This business premises for the past number of years has simply flaunted the law in relation to planning permission. There have been a number of complaints to Planning Enforcement about illegal works, street furniture and advertisement placed on the structure. There have been numerous complaints to me and to the authority about the sheer level of anti-social behaviour emanating from the customers from this establishment. On many occasion the footpaths both at Camden Street and Pleasant Street are impassable with many pedestrians including elderly residents having to walk on the roadway. This behaviour often continues well into the early hours of the morning keeping local residents and their children awake. The management here have no regard for the local residents and community. A complete disregard for pedestrians and road users and have failed entirely to take responsibility for this dreadful situation that they have created. Every person has a right to trade responsibly but this kind of trading and behaviour is reckless and detrimental to all.

Motion 7 from Councillor Mary Freehill

That the Manager state what discussion took place, if any, with the NTA in regard to the current road resurfacing of Kimmage Road from Kimmage Court to Sundrive Road.

Motion 8 from Councillor Mary Freehill

That the Traffic Department reports on progress on the proposed locations made by residents' association for bike stands in the Harold's Cottages area.

Motion 9 from Councillor Mary Freehill

That the Manager inform us on progress and the proposed implementation date for residential disc parking on Clareville Road.

Motion 10 from Councillor Mary Freehill

That DCC request Waterways Ireland to consider installing Seabins along the Grand Canal (info attached), this would greatly improve the level of pollution in our canals. Also that they consider planting reeds along the canal. It has been noticed that Gulls are attacking young water hens on the canal, if there were reeds close to the banks it would provide a greater protection for the wild life along the canal".

"The Seabin V5, is a floating garbage bin, which acts as a trash skimmer and debris interceptor that is located in the water at marinas, ports and yacht clubs. By pumping water into the device, the Seabin V5 can intercept: floating debris, macro and micro plastics and micro

fibres (a recent development). By acting as a trash skimmer, the Seabin V5 is also able to clean the water from contaminated organic material (leaves, seaweed, etc.).

The Seabin V5 is equipped with oil absorbent pads able to absorb petroleum-based surface oils and detergent predominant in most marinas around the world."

Ireland has two Seabins. Both of which were installed in Dún Laoghaire and crowd funded by an 11-year-old environmental activist who collaborated with the Dún Laoghaire Harbour Company, the Dún Laoghaire Marina and Inland and Coastal Marina Systems.

The cost of each Seabin is €3,300, but the price is often reduced in the event of a large order. In addition, it appears that the company who makes them, 'The Seabin Project' are focussed on installing them in Marinas, Ports and Yacht Clubs but I've contacted them about how adaptable they'd be to freshwater and am awaiting a reply.

I've attached an image that describes what kind of waste it gathers and a short YouTube video of one in action: <https://www.youtube.com/watch?v=ySp7HKD7jaw&t=57s>

I notice as well that Waterways Ireland have received an overall funding increase of €1.8 million bringing their total financial allocation to €20.737m in current funding and €4.38m in Capital Funding. Perhaps the Dublin Port Authority could also allocate some of their previously misused and abuses budgets to initiatives like the Seabin."

Motion 11 from Councillor Chris Andrews

That this area committee recognises that the works being undertaken by the Waste Management Department at Herzog Park are a 'Material Change' and a 'Modification' in breach of the Part 8, Report No. 10/2017 and the Chief Executive's Recommendations therein as noted and approved by the City Council on the 9th January 2017. Therefore management will stop works immediately and the work will be carried out as recommended 'Without Modification'.

Motion 12 from Councillor Anne Feeney

This South East Area Committee requests a review of the access gates of all Dublin City Council parks large and small (e.g. Poddle Close) and commits to installing gates that will ensure ease of access for those who need to use wheelchairs and motorized wheelchairs.

Motion 13 from Councillor Anne Feeney

That this committee calls upon the Chief Executive to outline a programme to repaint all street name signs and to do this with a paint that is durable for many years to come. Currently there are many street signs that are totally illegible and make areas in our city look neglected. Perhaps this work could be done in conjunction with some community / volunteer / student groups as part of a potential 'Pride in Our Neighbourhood / City' initiative.

Motion 14 from Councillor Deirdre Conroy

That this area committee does not approve the modification and change of use to the rear of the Bring Centre at Herzog Park, Rathgar Road. The Part 8 Application 3762/16 recommended that the proposed development would proceed without modifications. The modifications are since referred to as 'redesign'. The change of use involves access and egress of n trucks per day over a minimum of 12 weeks, beside a playground, a school, a tennis club, a small car park.

(I have submitted an opinion to the Waste Management Officer)

Motion 15 from Councillor Deirdre Conroy

That this area committee would agree traffic signal improvement on Terenure Road West which runs from Kimmage Cross Roads to the junction of Terenure and Templeogue Road. There are many side roads and housing estates off the road. The traffic light control signal at the Y junction with Templeogue Road is considered by local residents to be unsynchronized for local traffic. A report from the Chief Executive is requested for local residents.

Motion 16 from Councillor Deirdre Conroy

Anti-social behaviour in various parks throughout the western area of the Kimmage-Rathmines Ward, particularly in children's playgrounds, has caused local residents to request that the gates of parks be locked within an agreed time in the evening (particularly the entrance to Eamon Ceannt Park on Sundrive Road). And that fencing is constructed around playgrounds, to minimize access (Stannaway Park). Residents report that bins are removed from outside their homes and brought to parks to be burnt.

Motion 17 from Councillor Deirdre Conroy

That this area committee agrees to reinstatement of the outdoor yoga class on Saturday mornings in Dartmouth Square, and other parks from which it has been removed, the event has been previously supported by Dublin City Council and the organiser Happenings.ie

Motion 18 from Councillor Kevin Donoghue

That the speed limit on the main road through Ringsend into Irishtown be reduced to 30 KPH.

Motion 19 from Councillor Pat Dunne

This area committee calls upon our Public Domain Section to co-ordinate a weed removal programme combined with a general clean-up of roads, lanes, pathways and communal green spaces in the Dublin 12 area.

Given that the spraying of chemicals to contain the growth of weeds is no longer being used we call upon the various sections of DCC to implement a plan to manually deal with this problem. The Dublin 12 area is in a particularly bad state with weeds growing out of control.

Motion 20 from Councillor Pat Dunne

This area committee calls for a system to be put in place for the rest of this calendar year to ensure that any unspent money allocated from the 2019 Dublin South Central Discretionary Fund and earmarked for that part of Dublin 12 that is now in Dublin South East be spent in Dublin 12.

Motion 21 from Councillor Pat Dunne

Given the size and diversity of the Dublin South East Area Committee we believe that a system of more localised meetings between councillors and local management for each of the 3 local electoral areas (LEAs) should be established.

Motion 22 from Councillor Claire Byrne

That this area committee calls on the Area Manager to engage further with Irish Water to find an interim solution to address the ongoing issue of no bathing water notices being served due to over flows at the Ringsend Waste Water plant.

Motion 23 from Councillor Claire Byrne

That this area committee rejects the decision by An Bord Pleanála to change the zoning of areas B1, B2 and Port Park in the Poolbeg West Strategic Development Zone (SDZ). The zoning for these sites was agreed by the members of the council and should not be amended.

Motion 24 from Councillor Hazel Chu

That this local area committee agrees to write to Supervalu in Ranelagh to investigate the possibility of glass recycling facilities.

Motion 25 from Councillor Hazel Chu

That this local area committee agrees to write to Environmental Protection Agency (EPA) Ireland and Covanta asking for real time air monitoring in light of recent licence changes and their permission to now burn sewage sludge.

Motion 26 from Councillor Hazel Chu

That this local area committee request a representative from Irish Water to provide details of actions they will take in light of repeated sewage overflow and beach closure.

Motion 27 from Councillor Hazel Chu

That this local area committee agrees to establish a series of dog parks.

Motion 28 from Councillor Hazel Chu

That this local area committee would sow wild flowers on grass verges without mowing throughout the year to both save cost and support pollinators and increase biodiversity.

Motion 29 from Councillor Mary Freehill

That Palmerston Park in its entirety be designated protected status as a historically designed park. That the Holwley Hayes Arborist Management Report be implemented and that funding is made available for this purpose.

Q.1 Councillor Dermot Lacey

To ask the manager if he could investigate why a request from a resident that hedge seriously encroaching on the public footpath at (details supplied) be pruned and cut back was not acted upon or the resident receiving any response from DCC.

Q.2 Councillor Dermot Lacey

To ask the manager if he will give me a response to these issues in relation to Belgrave Square Park:

Belgrave Square - 3 out of 7 bins removed from park - why?

Poo bin removed from railing replaced by notice - why?

Can we have some adult exercise equipment please?

Q.3 Councillor Dermot Lacey

To ask the manager if he will give me response to these issues pertaining to Palmerston Park, Dublin 6:

There are signs at the entrance to the park saying dogs must be on leads. The city council makes zero effort to enforce the rules or even to monitor the situation. And I mean zero effort not even random checks. There are numerous large dogs not on leads running loose around the park who are a danger to small children and older people. They can knock them over as some large dogs get very excited when they are loose and run fast and powerfully. Dog owners come from other parts of the city to run their dogs in Palmerston Park because they know there is no monitoring and that they can get away with not having their dogs on leads.

Q.4 Councillor Dermot Lacey

To ask the manager if he will respond positively to the concerns regarding the footpath on Temple Road as referred to in the email excerpt below.

“The footpaths on Temple Road, Dublin 6 are badly broken up and in many cases are dangerous for walkers, particularly the elderly. The paths are probably over 100 years old.”

Q.5 Councillor Dermot Lacey

To ask the manager if he will raise the matters referred to in the email excerpt below to the Gardaí and the authorities of Trinity Hall, Darry:

“There are over 1,000 student residents in Trinity Hall. At 10.30 every night the management there requires students who are noisy and drinking to leave the complex. These student residents are then forced out onto Temple Road heading for the LUAS with a number engaging regularly in anti-social behaviour towards the normal residents and their property. My wife and I have even been threatened with glass bottles by drunken students. There is no visible policing from the GARDA and Trinity has not even installed a proper CCTV system at the entrance gates to monitor the behaviour of its own residents leaving and entering the complex.”

Q.6 Councillor Dermot Lacey

To ask the manager if there will be a weed spray in the Pembroke area this summer as per previous summers and to indicate the areas to be covered.

- Q.7 Councillor Patrick Costello**
To ask the manager what is being done to address the littering and anti-social behaviour in Pearse Park.
- Q.8 Councillor Patrick Costello**
To ask the manager with the planned resurfacing of Kimmage Road Lower, in the process of breaking out and raising ironworks, the two Bord Gáis manholes (outside 216 and 220 Lower Kimmage Road) will be repaired or replaced?
- Q.9 Councillor Patrick Costello**
To ask the manager to resurface Windsor Terrace and Portobello Road.
- Q.10 Councillor Patrick Costello**
To ask the manager to install cycle lane along Terenure Road West.
- Q.11 Councillor Patrick Costello**
To ask the manager to have Derry Road resurfaced as soon as possible.
- Q.12 Councillor Patrick Costello**
To ask the manager to replace the ramps on Derry Road (marked in red on the image below) with speed tables located at the junctions (marked in green at the image below).
- 
- Q.13 Councillor Chris Andrews**
Can the manager introduce a right hand filter on Macken Street for traffic turning right / east onto Pearse Street, as motorists currently have obscured view when trying to turn right and is extremely dangerous?
- Q.14 Councillor Chris Andrews**
Can the manager say where the application of (detail supplied) for a wet room is and what is the process and a timescale for installation?
- Q.15 Councillor Chris Andrews**
Can the manager arrange to have all the planters in Dowling's Court cut back and maintained, particularly the one outside 15 Dowling's Court, as there are clearly rats nesting in this one and some of the others and ensure the rats are treated with poison until they are gone?
- Q.16 Councillor Chris Andrews**
Can the manager contact the management of Riverview / David Lloyd and serve them with notice to cut the hugely overgrown trees on the boundary with Beechill Avenue and, if they do not cut them DCC will carry out this work and charge Riverview / David Lloyd.
- Q.17 Councillor Mannix Flynn**
Can the manager write to the management of the Meath Hospital and request them to remove the graffiti from the perimeter walls particularly in and around Arnott Street? This wall has become vandalised due to much graffiti. Also, can they weed the area around their perimeter wall and generally maintain the fabric of this listed building?

- Q.18 Councillor Mannix Flynn**
Can the manager supply me with the archaeological report regards the archaeological findings at Longford Street? This report was commissioned some time back and I still have not received a copy of it.
- Q.19 Councillor Mannix Flynn**
Can the manager have Estate Management investigate a series of rat infestations in and around Verschoyle Court particularly with the dwellings that are closest to the archway?
- Q.20 Councillor Mannix Flynn**
Can the manager issue a full report as to when the fencing will be completed for the residents at the Peace Park Garden in Christchurch?
- Also, can the manager obtain a copy of the finished wording that is to be placed in the garden and when this work is to be reinstated and a copy all site works to be finished at the Peace Garden and any other works associated with the Saint Nicolas without the walls structure?
- Q.21 Councillor Mannix Flynn**
Can the manager initiate a full clean and weeding and graffiti removal of the entire Portobello area including the area in and around St. Kevin's? This area now is saturated with graffiti. Many buildings are vandalised. Adding to this the weeds are thriving. There is an issue I know, with cars being parked but if residents are informed they can be removed.
- Q.22 Councillor Mannix Flynn**
Can the manager have the footpaths and kerb stones repaired on Lombard Street West (north side)? Much of the footpath and kerb stone here is broken and dilapidated. It is a dangerous trip hazard.
- Q.23 Councillor Mannix Flynn**
Can the manager examine the possibility of having a green wall (planted foliage) at Drury Street Carpark / Stephen Street Lower and Fade Street? This building is a multi-storey carpark belonging to DCC. Its frontage is made of steel and it lends absolutely nothing to the street or the surrounding architecture. Given our recent published plan on climate action, placing a green wall (planted foliage) and greening this area is a fantastic opportunity for DCC to lead the way.
- Q.24 Councillor Mannix Flynn**
Can the manager issue an update report regarding the progress on the resurfacing and regeneration of the football pitch at Digges street?
- Q.25 Councillor Mannix Flynn**
Can the manager issue a full update report with regards the undue delays of the refurbishment and tendering process for Temple Bar Square? This report to include a full list of all those who are involved in this project and a clear explanation as to what is delaying this project. Many traders in the area are dismayed by this delay and are concerned and confused by the delay and lack of clear information. In the meantime the Square itself is seriously dilapidated and a public danger.
- Q.26 Councillor Mannix Flynn**
Can the manager issue a full report regarding any plans that DCC has before them or drawings that relate to the reconfiguration and banning of parking and rearrangement of traffic at Seafort Avenue, Sandymount? Recently a meeting was held between

residents and traffic officials. Some clarification was given but the residents here are still gravely concerned about the behaviour and the intentions of the Department of Education and their building out of Rosalind Park School. Further, can the management set out in details the statutory process for the removing of residents parking and also for any changes and realignment of roadways that may be envisaged here by the Department of Education?

Q.27 Councillor Paddy McCartan

To ask the manager to deal with the following issue from a constituent: {He writes}
"Cowper Downs has become a car park for the Luas Cowper stop and a dumping ground for unwanted cars.

The reason for this is that parking is free and the surrounding roads all have paid parking.

Can you implement paid parking please for Cowper Downs with residents' permits for those of us who live here?"

Q.28 Councillor Paddy McCartan

To ask the manager to have a name plate at the end of Cherryfield Avenue, Ranelagh replaced. See picture.



Q.29 Councillor Paddy McCartan

To ask the manager to have the drains cleared on Vergemont Hall, Clonskeagh.



Q.30 Councillor Paddy McCartan

To ask the manager to deal with the following issue on Morehampton Road Donnybrook outside the shops between AIB and Donnybrook Fair. They have signage outside on the footpath which is a safety hazard for wheelchair users and the visually impaired.

Q.31 Councillor Paddy McCartan

To ask the manager to deal with the following issue from a constituent:
She writes about the state of the bike rack in Supervalu car park in Ranelagh:
"Supervalu say it's not their problem. Is it a DCC issue?
It is a health hazard at this stage. Litter is thrown there and also, sausages and remains of cauliflowers. There are the remains of four bicycle wheels attached to the racks. They have been there for nearly two years. Please clarify who is responsible."

Q.32 Councillor Paddy McCartan

To ask the manager to respond to the issues raised from a constituent:

(He writes)

"I believe that I speak for the residents of Mount Eden Road in expressing our total horror and opposition to the proposal to construct the entrance to the proposed new school in Muckcross Park, catering for some 800 students, on Mount Eden Road, when there is existing a very large and suitable entrance to these grounds already there on Marlboro Road. There is absolutely no need to have a second entrance to this new school.

You will be aware of the current chaotic traffic arrangements on Belmont Avenue. If the main entrance for students to this school is arranged on Mount Eden Road, the chaos will be much more horrific as much of the traffic will be coming through Belmont Avenue.

The current very large entrance to these grounds off Marlboro Road, with the large space just inside the gates allowing students to be dropped off without requiring any parking, would be eminently much more suitable than a Mount Eden Road drop off arrangement.

Question: has planning permission been applied for or agreed for this new gate on Mount Eden Road?

Q.33 Councillor Paddy McCartan

Dodder Public Transportation opening bridge.

According to the project delivery programme Stage 3 the tender process will commence July 2019 till October 2019 and Stage 4 the construction process will commence October 2019 till April 2021

Could the manager indicate at this stage whether the project is on target?

Q.34 Councillor Anne Feeney

To ask the manager to arrange to have more lights installed on Fortfield Terrace, Cowper Road and Grosvenor Lane and indeed to carry out a review of lighting on adjoining roads. These roads are very dark at night and in the case of Cowper Road, potentially dangerous for commuters coming off the Luas line and walking up toward Rathmines Road Upper.

Q.35 Councillor Anne Feeney

To ask the manager to review the double yellow lines outside (details supplied) as there is a dangerous bend with cars parked on it and the lane is heavily used by people using the Dartry gym and tennis club.

Q.36 Councillor Anne Feeney

To ask the manager to install a 'Cul de Sac' sign at the entrance to the area commonly known as 'The Keyhole' off Melvin Road.

Q.37 Councillor Anne Feeney

To ask the manager to address the following issues on Grosvenor Square;

- Trees needing pruning, particularly outside (details supplied).
- More signage and enforcement re dog fouling around the square.

- Q.38 Councillor Anne Feeney**
To ask the manager to consider a yellow junction box on Terenure Road East at the entrance to Healthfield Road. It is very difficult for cars emerging from Healthfield Road to get onto Terenure Road East whether going east or west, particularly at peak hours with cars backed up this main arterial route.
- Q.39 Councillor Anne Feeney**
To ask the manager to do a clean-up of the lane behind (details supplied) and to regularly inspect this lane which has ongoing issues of drinking, defecation and dumping.
- Q.40 Councillor Anne Feeney**
To ask the manager to carry out some repair works on the paths on Frankfort Avenue. A number of parts of the path are in a hazardous state, some as a result of tree roots lifting the pavements. (Outside details supplied is particularly dangerous for those with mobility issues).
- Q.41 Councillor Anne Feeney**
To ask the manager to arrange for the heritage poles on Victoria Road, Effra Road and across the South East area to be re-painted in order to preserve them for future generations. While some of these poles on Belgrave Square and Palmerston Road were repaired and painted recently, many others are in a poor state and should be preserved as part of the heritage of the city.
- Q.42 Councillor Anne Feeney**
To ask the manager to arrange for more speed control signs/interventions to be put in place on Victoria Road.
- Q.43 Councillor Deirdre Conroy**
To ask the manager for removal and repair of rat hole and rat infestation in gardens on Cashel Road. Exact location as per details supplied. It is a City Council rented property and impacts directly on the adjacent private residence. It is a serious health impact and the resident children in the property cannot use their garden.
- Q.44 Councillor Deirdre Conroy**
To ask the manager for repair of serious sewage damage, the impact of which affects the local environment, the footpath, main road, outside family homes on Stannaway Road. Possibly caused by extensive development construction on site to the rear of (details supplied).
- Q.45 Councillor Deirdre Conroy**
To ask the manager if a pedestrian crossing can be provided near Ravensdale, Crumlin / Kimmage?
- Q.46 Councillor Deirdre Conroy**
To ask the manager if the double yellow lines outside the residents' homes on Mount Drummond Avenue could be completed.
- Q.47 Councillor Deirdre Conroy**
To ask the manager if double yellow lines could be extended outside a private home on Zion Road.

- Q.48 Councillor Deirdre Conroy**
To ask the manager if street lights could be improved on Corrib Road and trees pruned. As the scale of the trees is blocking the effect of the street lights according to local residents.
- Q.49 Councillor Deirdre Conroy**
To ask the manager to address the commercial company that has over scale transport accessing the site to the rear of Cedar Court on Mount Tallant Avenue. Local resident says it is significant danger to children, pedestrians, cyclists in the area.
- Q.50 Councillor Kevin Donoghue**
To ask the manager, when will the plebiscite take place on the change of times of the Pay & Display in (details supplied)?
- Q.51 Councillor Kevin Donoghue**
To ask the manager when will the plebiscite take place on the change of times of the Pay & Display in (details supplied)?
- Q.52 Councillor Kevin Donoghue**
To ask the manager when repairs to the flood defences on Fitzwilliam Quay will commence as this is ongoing for the past seven years.
- Q.53 Councillor Kevin Donoghue**
To ask the manager, are the sewer vent pipes being vented above the roof in Canon Mooney Gardens.
- Q.54 Councillor Kevin Donoghue**
To ask the manager, for improved 3 tonne signage to be erected on Shelbourne Road?
- Q.55 Councillor Kevin Donoghue**
To ask the manager for electronic speed signs to be erected on the approach road to the Tom Clarke Bridge in both directions.
- Q.56 Councillor Kevin Donoghue**
To ask the Area Manager if they will liaise with Waterways Ireland around the introduction of sea bins / water bins to clear up rubbish and debris in Grand Canal and, if necessary, to invite Waterways Ireland to present to the area committee on same.
- Q.57 Councillor Kevin Donoghue**
That this area committee calls on the area to review and increase the frequency of street cleaning on Gordon Street, Gerald Street, Howard Street, South Dock Street and Barrow Street. Construction on Barrow Street has led to a significant increase in the amount of litter and debris on these streets and the residents have been left to clean this up.
- Q.58 Councillor Pat Dunne**
Can the Area Manager give a definite date for the re-opening of the Crumlin Swimming Pool and confirm the summer timetable for public swimming?
- Q.59 Councillor Chris Andrews**
Can the manager arrange to have the windows of the elderly tenant (details supplied) which are currently single glazed replaced with double glazed modern windows?

Q.60 Councillor Chris Andrews

Can the manager explain why the resident of (details supplied) did not have a new window and door frame installed when they moved in, similar to other tenants when they moved in and that a report on the reason for the ongoing issues the tenant is experiencing with drafts in the flat.

Q.61 Councillor Claire Byrne

To ask the Area Manager can he please give a progress update on the provision of the Men's Sheds project for Ringsend / Irishtown? Can the Area Manager confirm whether a site has been located for the project and at what stage this is currently at in terms of the delivery?

Q.62 Councillor Claire Byrne

To ask the Area Manager can he please assist (details supplied 1) in securing a home for her and her daughter in the neighbourhood? They are currently living in a seriously overcrowded situation, with their parents who have health issues and who also have another grown up child with disabilities. Can this person be considered for (details supplied 2), which I understand are available.

Q.63 Councillor Claire Byrne

Can the Area Manager please enforce the issue of illegal parking on Molesworth Street outside The Ivy? The constant illegal parking on double yellow lines here is causing an obstruction and serious problems for buses, cyclists and vehicles turning on to Molesworth Street, The council should consider removing all parking along that section as it is very dangerous.

Q.64 Councillor Claire Byrne

To ask the Area Manager can he please investigate complaints about (details supplied)? The restaurant has an outdoor oven which is causing a large plumes of smoke to flow into the neighbouring gardens. I understand previous complaints have been investigated but that the proprietor is not complying with the necessary regulations.

Q.65 Councillor Claire Byrne

To ask the Area Manager can he please investigate the following issue for (details supplied)? The family of the former tenant (details supplied), received notification that their mother had been over paying rent, and that a reimbursement was owed. However to this date this overpayment has not been reimbursed and no valid expansion given. A family member is the current tenant of the property, having lived there all his life with his mother. Can the Area Manager please investigate why this payment has not been made and can he confirm that they current tenant is entitled to stay in the property.

Q.66 Councillor Claire Byrne

To ask the Area Manager can he please install a bin outside the Meath Street Hospital on Heytesbury Street as verbally agreed at the May meeting. This would help with the ongoing litter problem along this stretch of road.

Q.67 Councillor Claire Byrne

To ask the Area Manager can he please address the on-going issue of litter and illegal dumping on Grantham Place, Dublin 8? Can the Area Manager increase the street cleaning here and install 'No Dumping' signs at either end as a starting measure?

Q.68 Councillor Claire Byrne

Can the Area Manager please explain why trees are being removed from Bride Street and John Field Road, are there plans to remove further trees here, if so, why are they

being removed, and when will these trees be replaced as per the Dublin City Tree Strategy.

Q.69 Councillor Claire Byrne

To ask the Area Manager if he will please consider reviewing the parking system on Hagans Court, Dublin 2, as the current system is making ingress and egress to some properties here difficult, and is also a challenge for bin trucks on collection days.

Q.70 Councillor Hazel Chu

To ask the manger when repairs to Merrion Road cycle path will be undertaken.

Q.71 Councillor Hazel Chu

To ask the manager to repair the dangerous lawn area which is currently a trip hazard for children and adults at play in Mount Pleasant Square.

Q.72 Councillor Hazel Chu

To ask the manager for an update on Rathmines Gulistan Cottage development, to provide a timeline of development and a date of when the next meeting between councillors and planners will be.

Q.73 Councillor Hazel Chu

To ask the manager for more bins in parks and more enforcement of fines on littering especially that of dog littering.

Q.74 Councillor Hazel Chu

To ask the manager to install traffic calming measures in Northbrook Avenue estate.

Q.75 Councillor Hazel Chu

To ask the manager to facilitate an on-site meeting between councillors, the local area office Transdev and residents of Richmond Court to explore what steps can be taken to address the issue of noise from the Luas approaching Miltown Luas stop.

Q.76 Councillor Patrick Costello

To ask the manager to improve the signage for the cul de sac at Swanville place.

Q.77 Councillor Patrick Costello

To ask the manager for an update on question 57 from the May meeting (re pedestrian crossing at Lesson Street), and if there is a timeline for the works to be completed?

Q.78 Councillor Mary Freehill

To ask the Road Maintenance Section to carry out street and footpath repairs in Mount Drummond as per attached photos. Furthermore because of heavy commuter parking at the bollards at the top of Mount Drummond Square beside the Grosvenor Square, residents have found themselves boxed in and unable to exit. I would appreciate if traffic would examine this please.

Q.79 Councillor James Geoghegan

To ask the manager further to my question 83 to the Chief Executive on the 17th of June 2019 if he could confirm whether the outfall from Ailesbury Pump Station a factor in the closure of Sandymount Strand and Merrion Strand for swimming; if a copy of the updated management plan for Sandymount Strand sent to the Environmental Protection Agency (EPA) this year could be provided to me.

Q.80 Councillor James Geoghegan

To ask the manager if he would consider installing flexi bollards along the cycle lane in the main Ranelagh Road through the village to protect safe cycling and prevent cars from parking along the cycle lanes.

Q.81 Councillor James Geoghegan

To ask the manager if he would consider installing a welcome to Milltown sign at the entrance to Milltown village like what Donnybrook has.

Q.82 Councillor James Geoghegan

To ask the manager if he would write to all residents of Belmont Avenue, Belmont Gardens and Belmont Villas inquiring with them as to their favourability for Belmont Avenue becoming a one-way road for a test period.

Q.83 Councillor James Geoghegan

To ask the manager if he would consider what additional safety measures can be put in place at St Matthew's National School, Cranfield Place, Dublin 4 for children attending school there in circumstances where it is a busy road with cars taking the route as a short cut from the East Link and that due to the large number of cars on both sides of the road - Cranfield Place and Oswald Road - visibility is very poor for both those crossing and traffic merging from Oswald Road, which despite its small size is a two-way road.

Q.84 Councillor James Geoghegan

To ask the manager if he would inquire into the possibility of introducing a yellow box on Serpentine Avenue at the top of Serpentine Park.

Q.85 Councillor James Geoghegan

To ask the manager if he could provide an update in relation to the Mount Pleasant Upper trial and its impact for the residents of Richmond Hill.

Q.86 Councillor James Geoghegan

To ask the manager if he could detail all roads in the south east area that have been included in the fourth phase of the 30 Km/h Speed Limit introduction which is scheduled to go for public consultation during summer 2019.